

80Amp Bosch Type Pressfit Automotive Rectifiers

Features

- ★ Low forward voltage drop
- ★ High current capability
- ★ High reliability
- ★ High surge current capability

Mechanical Data

- ★ Case: OFC Heat Sink
- ★ Encapsulation: Exoxy Sealed Rated UL94V-0
- ★ Weight: 7.10 gram

**Voltage Range 200 to 600
Current 80 Ampere**

PRESS-FIT

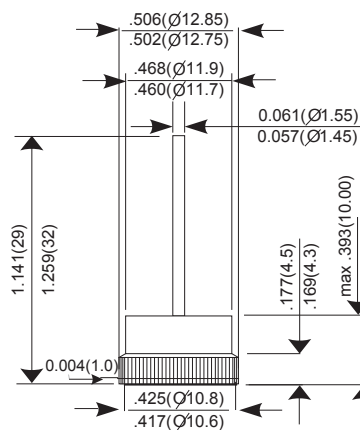

Dimensions in inches and (millimeters)

MAXIMUM RATINGS AND ELECTRICAL CHARACTERISTICS

Rating at 25°C ambient temperature unless otherwise specified.

PARAMETER	SYMBOL	PBFR8002JP(N)	PBFR8004JP(N)	PBFR8006JP(N)	Units
Peak Repetitive Reverse Voltage@Irrm=100mA	VRRM	200	400	600	V
Maximum RMS Voltage	VRMS	140	280	420	V
Maximum DC Blocking Voltage(TA=25°C)	VB	200	400	600	V
Average Forward Current Io@Tc=175°C 60 Hz, resistive or inductive load	I(AV)	80			A
Peak Forward Surge Current, 8.3ms single Half sine-wave superimposed on rated load (JEDEC method)	IFSM	700			A
Maximum Inst. Forward Voltage Drop, IF at 100 Amp	VF	1.05			V
Maximum DC Reverse Current @TJ=25°C At Rated DC Blocking Voltage @TJ=175°C	IR	1 300			uA uA
Operating Junction and Storage Temperature Range TJ, TSTG	TJ, TSTG	- 40 to + 175			°C

FIG.1 - FORWARD CURRENT DERATING CURVE

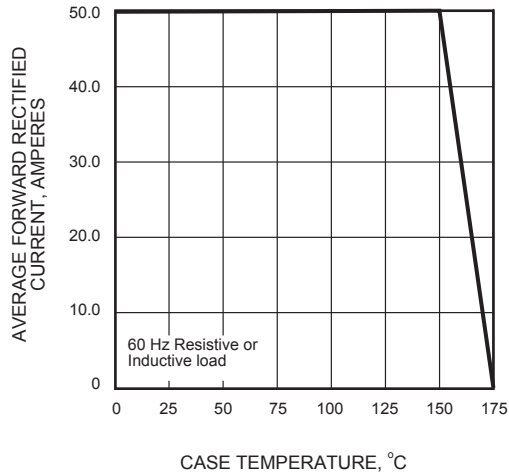

FIG.2 - MAXIMUM NON-REPETITIVE PEAK FORWARD SURGE CURRENT

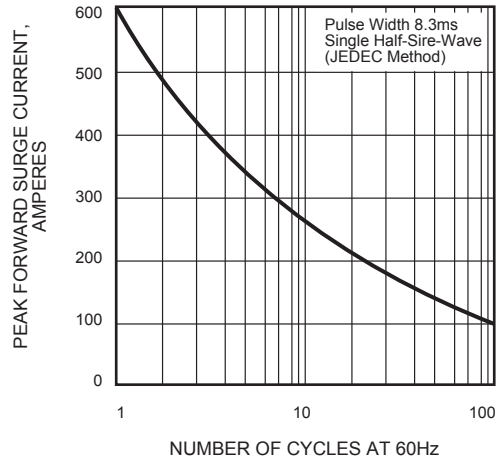

FIG.3 - TYPICAL INSTANTANEOUS FORWARD CHARACTERISTICS

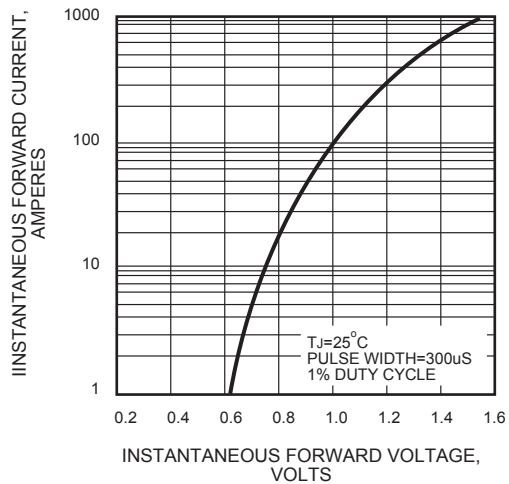

FIG.4 - TYPICAL REVERSE CHARACTERISTICS

