



LIGHTING FOREVER

4 PIN SOP PHOTOTRANSISTOR AC INPUT PHOTOCOUPLER

EL3H4-G Series

Features:

- AC input response
- Current transfer ratio
(CTR: Min. 20% at $I_F = \pm 1\text{mA}$, $V_{CE} = 5\text{V}$)
- High isolation voltage between input and output (Viso=3750 V rms)
- Compact small outline package
- Pb free and RoHS compliant.
- UL approved (No. E214129)
- VDE approved (No. 132249)
- SEMKO approved
- NEMKO approved
- DEMKO approved
- FIMKO approved
- CSA approved (No. 2021495)

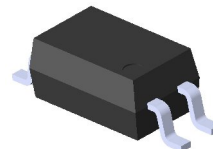

Schematic

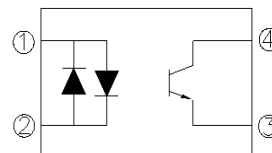

Pin Configuration

1. Anode / Cathode
2. Cathode / Anode
3. Emitter
4. Collector

Description

The EL3H4 series contains two infrared emitting diode, connected in inverse parallel, optically coupled to a phototransistor encapsulated with green compound.

It is packaged in a 4-pin small outline SMD package.

Applications

- AC line monitor
- Programmable controllers
- Telephone line interface
- Unknown polarity DC sensor

CONFIDENTIAL



LIGHTING FOREVER

4 PIN SOP PHOTOTRANSISTOR AC INPUT PHOTOCOUPLER

EL3H4-G Series

Absolute Maximum Ratings ($T_a=25^{\circ}\text{C}$)

| Parameter | | Symbol | Rating | Unit |
|-------------------------------------|---|-----------|----------|--------------------|
| Input | Forward current | I_F | ± 50 | mA |
| | Peak forward current ($t = 10\mu\text{s}$) | I_{FM} | 1 | A |
| | Power dissipation No derating required up to $T_a = 100^{\circ}\text{C}$ | P_D | 70 | mW |
| Output | Power dissipation Derating factor (above $T_a = 80^{\circ}\text{C}$) | P_C | 150 | mW |
| | | | 3.7 | mW/ |
| | Collector-Emitter voltage | V_{CEO} | 80 | V |
| | Emitter-Collector voltage | V_{ECO} | 6 | V |
| Total power dissipation | | P_{tot} | 200 | mW |
| Isolation voltage ^{*1} | | V_{iso} | 3750 | V rms |
| Operating temperature | | T_{opr} | -55~+100 | $^{\circ}\text{C}$ |
| Storage temperature | | T_{stg} | -55~+125 | $^{\circ}\text{C}$ |
| Soldering temperature ^{*2} | | T_{sol} | 260 | $^{\circ}\text{C}$ |

Notes

*1 AC for 1 minute, R.H.= 40 ~ 60% R.H. In this test, pins 1 & 2 are shorted together, and pins 3 & 4 are shorted together.

*2 For 10 seconds.



LIGHTING FOREVER

4 PIN SOP PHOTOTRANSISTOR AC INPUT PHOTOCOUPLER

EL3H4-G Series

Electrical Characteristics (T_a=25°C unless specified otherwise)

Input

| Parameter | Symbol | Min. | Typ.* | Max. | Unit | Condition |
|-------------------|-----------------|------|-------|------|------|-------------------------|
| Forward voltage | V _F | - | 1.2 | 1.4 | V | I _F = ± 20mA |
| Reverse current | I _R | - | - | 10 | μA | V _R = 4V |
| Input capacitance | C _{in} | - | 50 | 250 | pF | V = 0, f = 1KHz |

Output

| Parameter | Symbol | Min. | Typ.* | Max. | Unit | Condition |
|-------------------------------------|-------------------|------|-------|------|------|--|
| Collector-Emitter dark current | I _{CEO} | - | - | 100 | nA | V _{CE} = 20V, I _F =0mA |
| Collector-Emitter breakdown voltage | BV _{CEO} | 80 | - | - | V | I _C =0.1mA |
| Emitter-Collector breakdown voltage | BV _{ECO} | 6 | - | - | V | I _E =0.01mA |

Transfer Characteristics (T_a=25°C unless specified otherwise)

| Parameter | Symbol | Min. | Typ.* | Max. | Unit | Condition |
|--------------------------------------|----------------------|--------------------|------------------|------|------|--|
| Current Transfer ratio | EL3H4 | 20 | - | 300 | % | I _F = ±1mA, V _{CE} = 5V |
| | EL3H4A | 50 | | 150 | | |
| Collector-emitter saturation voltage | V _{CE(sat)} | - | 0.1 | 0.2 | V | I _F = ±20mA, I _C = 1mA |
| Isolation resistance | R _{IO} | 5×10 ¹⁰ | 10 ¹¹ | - | Ω | V _{IO} = 500Vdc, 40~60%R.H |
| Floating capacitance | C _{IO} | - | 0.6 | 1.0 | pF | V _{IO} = 0, f = 1MHz |
| Rise time | T _r | - | 6 | 18 | μs | V _{CE} =2V, I _C =2mA, R _L =100Ω |
| Fall time | T _f | - | 8 | 18 | μs | |

* Typical values at T_a = 25°C

4 PIN SOP PHOTOTRANSISTOR AC INPUT PHOTOCOUPLER

EL3H4-G Series

Typical Performance Curves

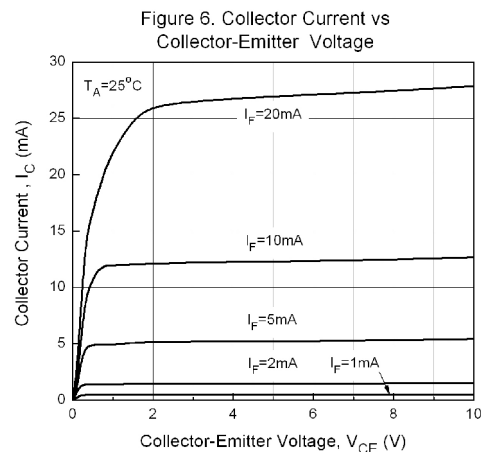
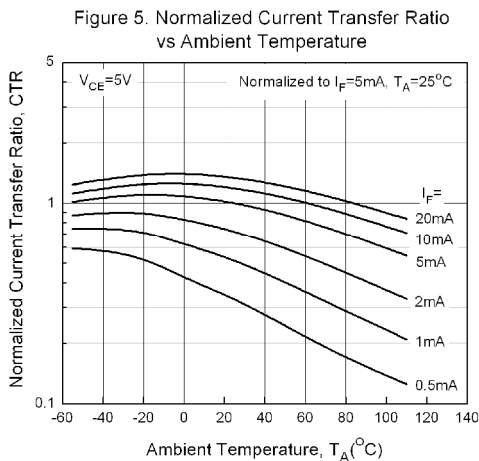
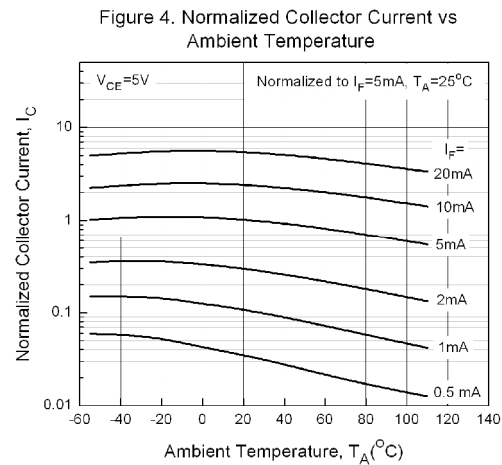
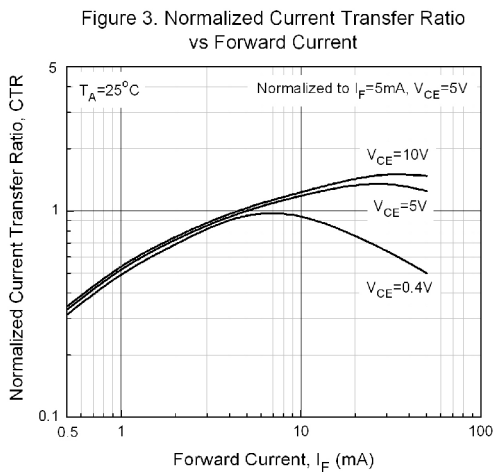
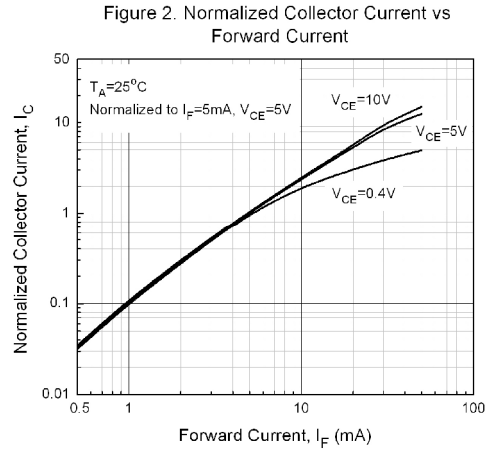
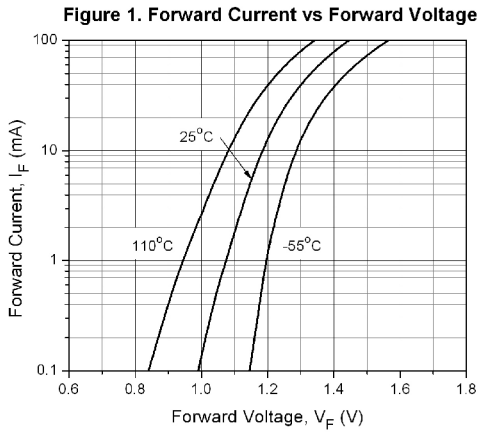

4 PIN SOP PHOTOTRANSISTOR AC INPUT PHOTOCOUPLER

EL3H4-G Series

Figure 7. Collector Current vs Collector-Emitter Voltage

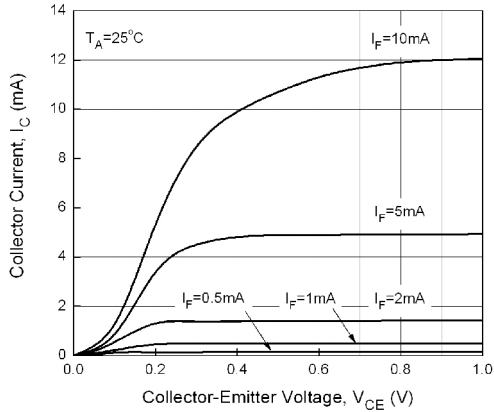

Figure 8. Collector Dark Current vs Ambient Temperature

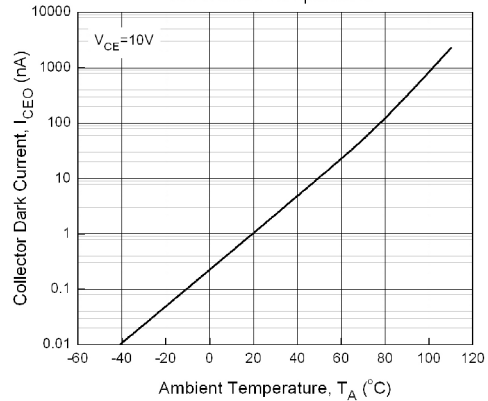

Figure 9. Collector-Emitter Saturation Voltage vs Ambient Temperature

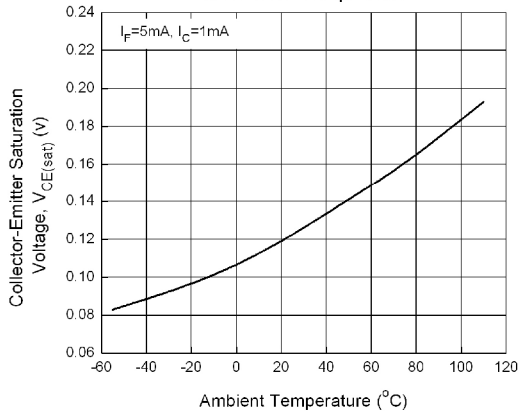

Figure 10. Switching Time vs Load Resistance

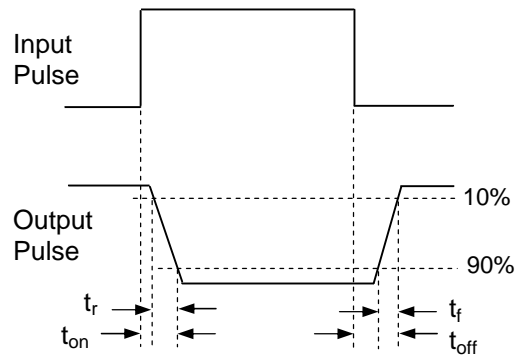
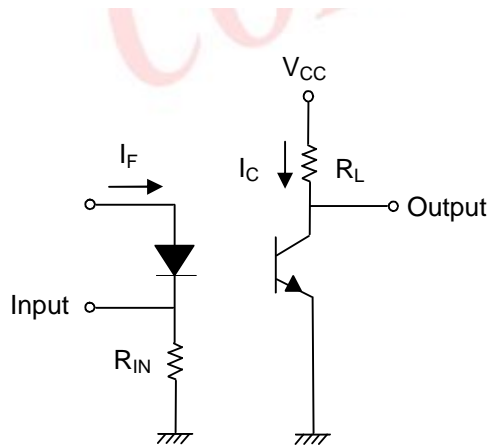
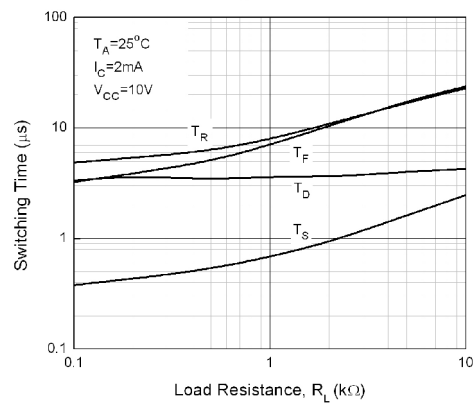

Figure 11. Switching Time Test Circuit & Waveforms



LIGHTING FOREVER

4 PIN SOP PHOTOTRANSISTOR AC INPUT PHOTOCOUPLER

EL3H4-G Series

Order Information

Part Number

EL3H4(X)(Y)-VG

Note

- 3H4 = Part No.
- X = CTR Rank (A or none)
- Y = Tape and reel option (TA, TB, EA, EB or none).
- V = VDE (optional)
- G = Halogens free

| Option | Description | Packing quantity |
|--------|-----------------------------|---------------------|
| None | Standard SMD option | 100 units per tube |
| -V | Standard SMD option + VDE | 100 units per tube |
| (TA) | TA Tape & reel option | 5000 units per reel |
| (TB) | TB Tape & reel option | 5000 units per reel |
| (TA)-V | TA Tape & reel option + VDE | 5000 units per reel |
| (TB)-V | TB Tape & reel option + VDE | 5000 units per reel |
| (EA) | TA Tape & reel option | 1000 units per reel |
| (EB) | TB Tape & reel option | 1000 units per reel |
| (EA)-V | TA Tape & reel option + VDE | 1000 units per reel |
| (EB)-V | TB Tape & reel option + VDE | 1000 units per reel |



LIGHTING FOREVER

4 PIN SOP PHOTOTRANSISTOR AC INPUT PHOTOCOUPLER

EL3H4-G Series

Package Drawings

(Dimensions in mm)

Package Drawing

(Dimensions in mm)

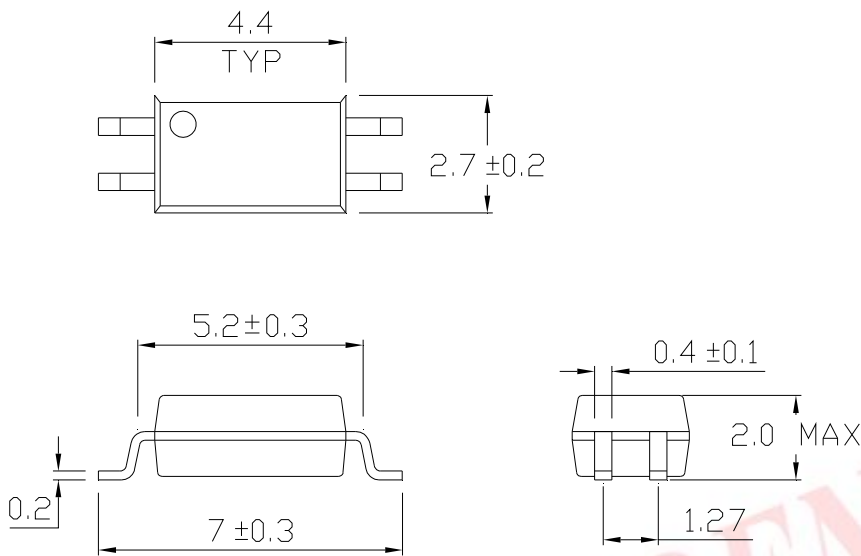

Recommended pad layout for surface mount leadform

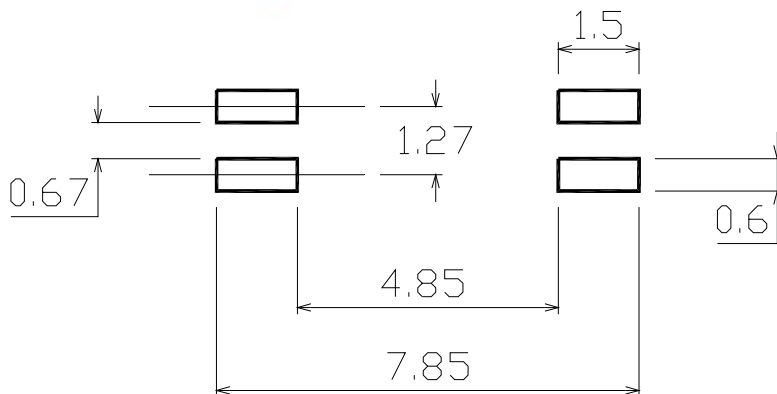



LIGHTING FOREVER

4 PIN SOP PHOTOTRANSISTOR AC INPUT PHOTOCOUPLER

EL3H4-G Series

Device Marking



Notes

- EL denotes Everlight
- 3H4 denotes Part Number
- R denotes CTR Rank (A or none)
- Y denotes 1 digit Year code
- WW denotes 2 digit Week code
- V denotes VDE approved (optional)

CONFIDENTIAL



LIGHTING FOREVER

4 PIN SOP PHOTOTRANSISTOR AC INPUT PHOTOCOUPLER

EL3H4-G Series

Tape & Reel Packing Specifications

Option TA

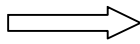
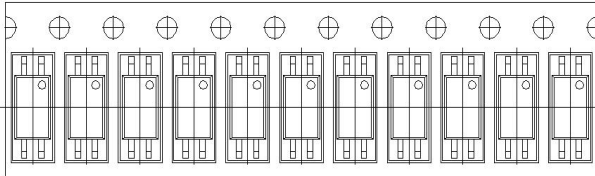

Direction of feed from reel

Option TB

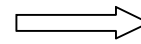
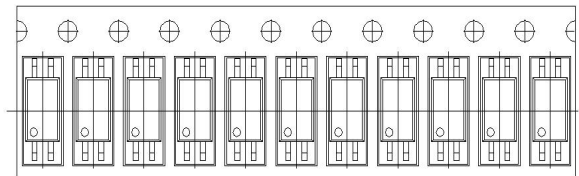

Direction of feed from reel

Tape dimensions

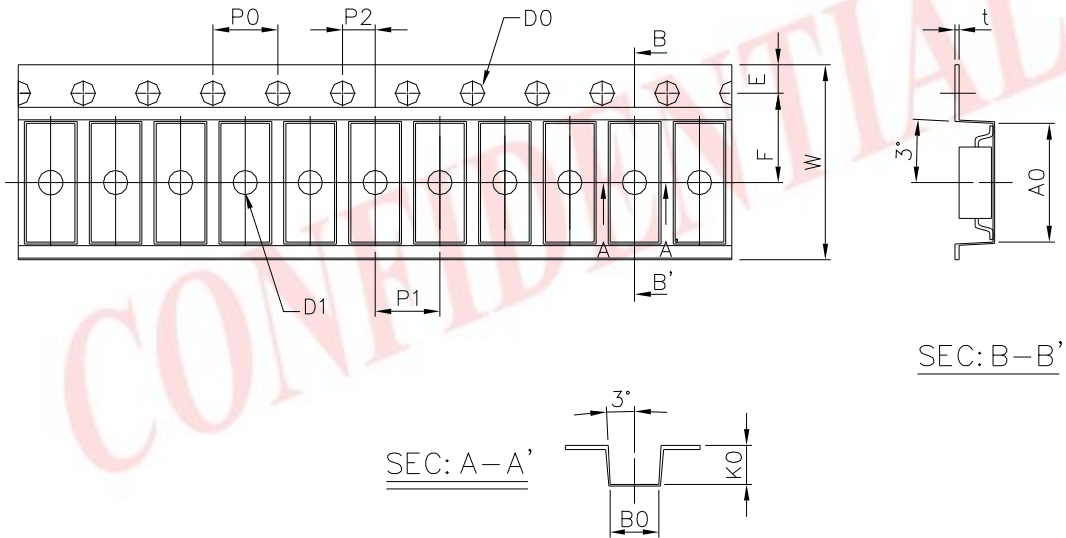

| Dimension No. | A | B | Do | D1 | E | F |
|----------------|-----------|-----------|--------------|-----------|------------|-----------|
| Dimension (mm) | 3.0 ± 0.1 | 7.3 ± 0.1 | 1.5 + 0.1/-0 | 1.5 ± 0.1 | 1.7 5± 0.1 | 5.5 ± 0.1 |

| Dimension No. | Po | P1 | P2 | t | W | K |
|----------------|------------|-----------|-----------|-------------|------------|-----------|
| Dimension (mm) | 4.0 ± 0.15 | 4.0 ± 0.1 | 2.0 ± 0.1 | 0.25 ± 0.03 | 12.0 ± 0.2 | 2.4 ± 0.1 |



LIGHTING FOREVER

4 PIN SOP PHOTOTRANSISTOR AC INPUT PHOTOCOUPLER

EL3H4-G Series

Solder Reflow Temperature Profile

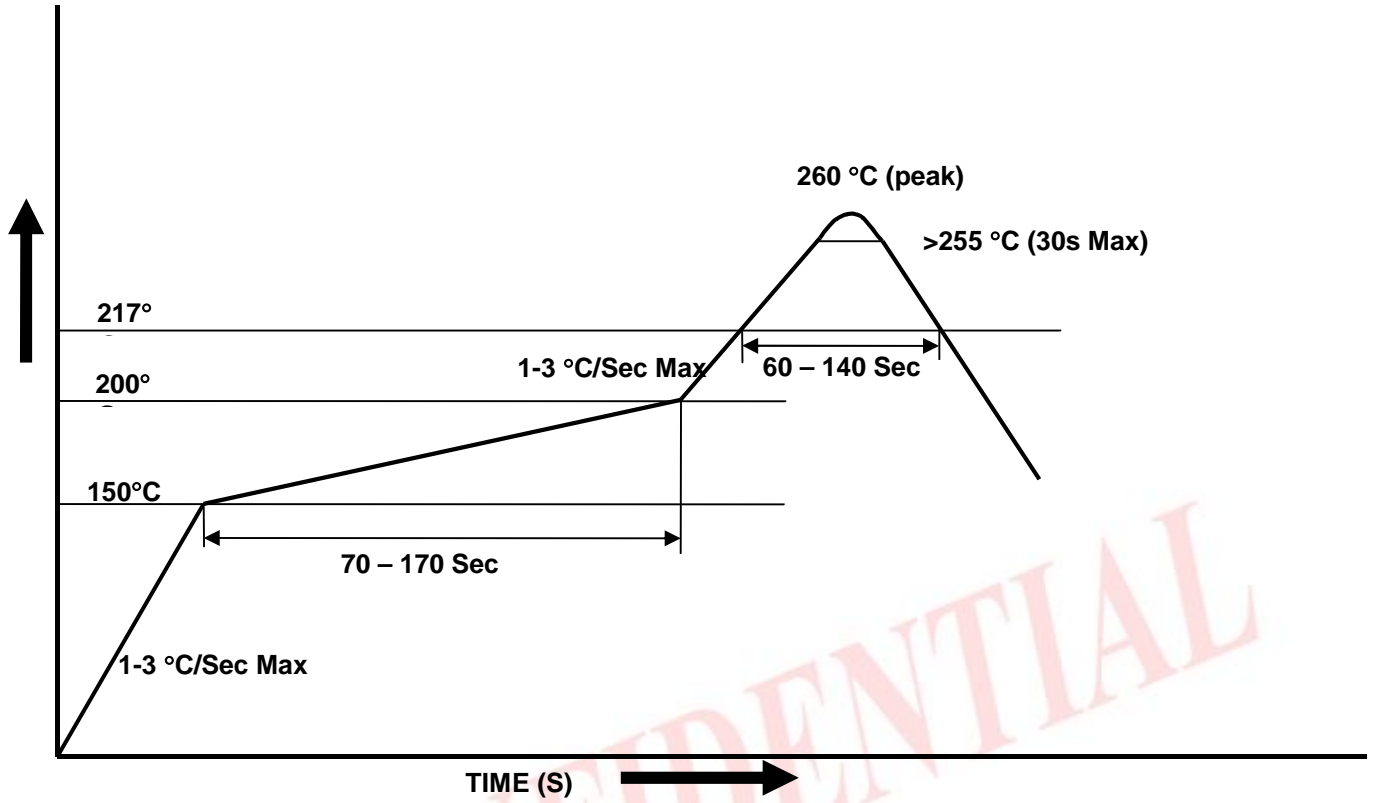

CONFIDENTIAL



LIGHTING FOREVER

4 PIN SOP PHOTOTRANSISTOR AC INPUT PHOTOCOUPLER

EL3H4-G Series

DISCLAIMER

1. The specifications in this datasheet may be changed without notice. EVERLIGHT reserves the authority on material change for above specification.
2. When using this product, please observe the absolute maximum ratings and the instructions for use as outlined in this datasheet. EVERLIGHT assumes no responsibility for any damage resulting from use of the product which does not comply with the absolute maximum ratings and the instructions included in this datasheet.
3. These specification sheets include materials protected under copyright of EVERLIGHT. Reproduction in any form is prohibited without the specific consent of EVERLIGHT.

CONFIDENTIAL