

# RT16032

SHENZHEN RUIITE ELECTRONIC CO., LTD  
 Address: 深圳市宝安区79区西乡流塘107国道1-3栋8楼  
 Tel: 86-755-27931867, 27931884, 27931806, 27931875  
 FAX: 86-755-27931864 Postcode: 518102  
 E-Mail: ruite168@21cn.com Http://www.ruitelcd.com

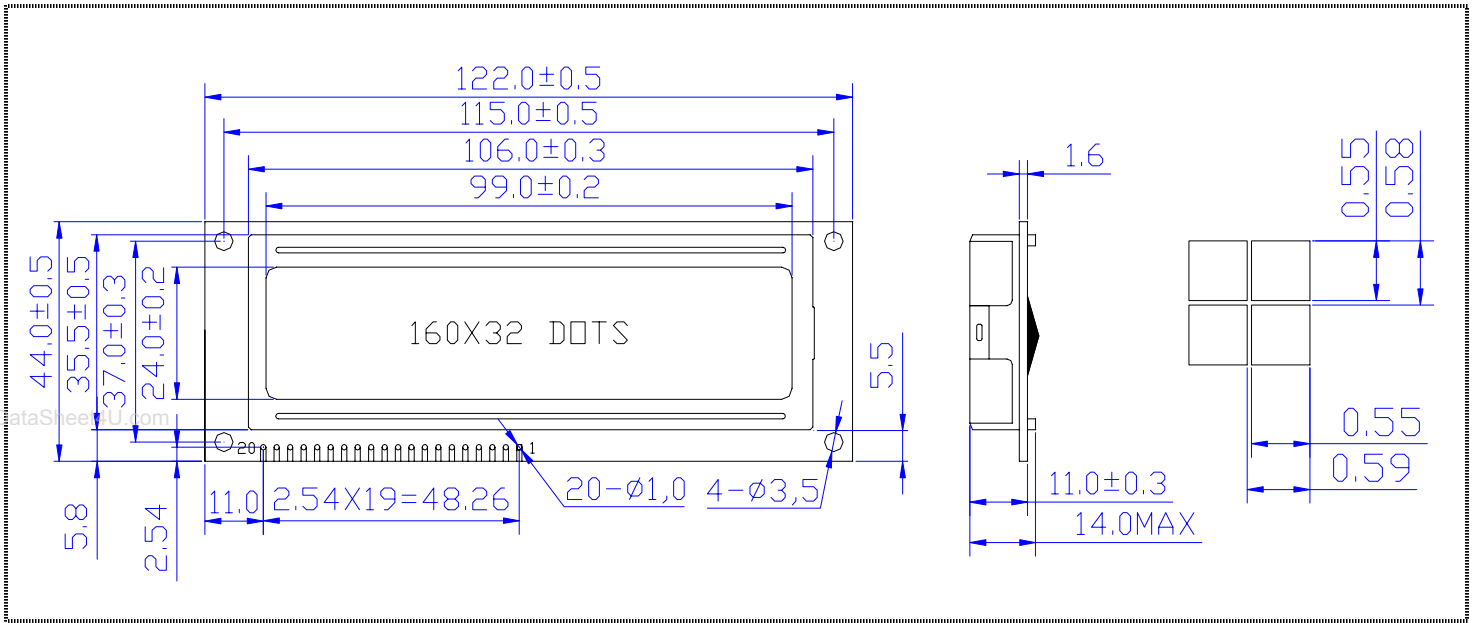

MECHANICAL DATA		
Item	Nominal Dimensions	Unit
Module Size(W×H×T)	122.0 × 44.0 × 14.0	mm
Viewing Area(W×H)	99.0 × 24.0	mm
Dot Pitch(W×H)	0.59 × 0.58	mm
Dot Size(W×H)	0.55 × 0.55	mm

PIN CONNECTIONS			
PIN	Symbol	Level	Function
1	VSS	—	GND(0V)
2	VDD	—	Supply Voltage for Logic(+5V)
3	V0	—	Power supply for LCD
4	RS/CS	H/L	H: Data ; L: Instruction Code/Chip select
5	RW/SID	H/L	H: Read; L: Write(Parallel)/Data(Serial)
6	E/SCLK	H/L	Enable Signal(Parallel) / Serial Clock
7	DB0	H/L	Data Bus Line
8	DB1	H/L	
9	DB2	H/L	
10	DB3	H/L	
11	DB4	H/L	
12	DB5	H/L	
13	DB6	H/L	
14	DB7	H/L	
15	PSB	H/L	H:Parallel Mode; L:Serial Mode
16	NC	—	NO Connect
17	/RST	L	Reset Signal (Active LOW )
18	NC	—	NO Connect
19	LED-	—	Backlight Power (0V)
20	LED+	—	Backlight Power (+5V)

ABSOLUTE MAXIMUM RATINGS					
Item	Symbol	Min	Type	Max	Unit
Operating Voltage	VDD	4.5	5.0	5.5	V
Operating Current	IDD	1.0	1.6	2.2	mA
LED Voltage	V <sub>LED</sub>	4.5	5.0	5.5	V
LED Current	I <sub>LED</sub>	80	130	170	mA
Operating Temp.	Topr	-20	—	+70	
Storage Temp.	Tsto	-30	—	+80	

ELECTRICAL CHARACTERISTICS					
Item	Symbol	Min	Type	Max	Unit
Input Hight Voltage	V <sub>IH</sub>	0.7VDD	—	VDD	V
Input Low Voltage	V <sub>IL</sub>	0	—	0.6	V
Output Hight Voltage	V <sub>OH</sub>	0.8VDD	—	VDD	V
Output Low Voltage	V <sub>OL</sub>	0	—	0.4	V

