

**2.0x1.2mm SMD CHIP LED LAMP**

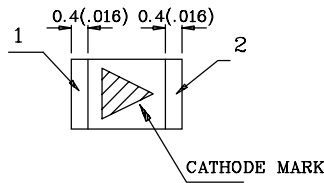

**SUN LED**

ZAG54W-01

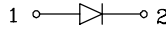
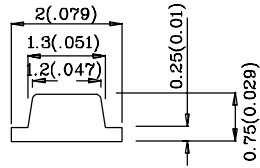
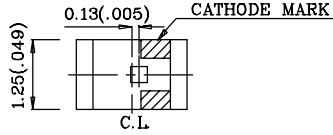

Notes:

1. All dimensions are in millimeters (inches).
2. Tolerance is  $\pm 0.1(0.004)$  unless otherwise noted.

Absolute maximum ratings ( $T_A=25^\circ\text{C}$ )		AG (InGaN)	Unit
Reverse voltage	$V_R$	5	V
Forward current	$I_F$	30	mA
Forward current (peak) 1/10Duty cycle 0.1ms pulse width	$i_{FS}$	100	mA
Power dissipation	$P_T$	135	mW
Operation temperature	$T_A$	-20 ~ +80	°C
Storage temperature	Tstg	-30 ~ +85	

Operating Characteristics ( $T_A=25^\circ\text{C}$ )		AG (InGaN)	Unit
Forward voltage (typ.) ( $I_F=20\text{mA}$ )	$V_F$	3.5	V
Forward voltage (max.) ( $I_F=20\text{mA}$ )	$V_F$	4.0	V
Reverse current ( $V_R=5\text{V}$ )	$I_R$	10	uA
Wavelength at peak emission ( $I_F=20\text{mA}$ )	$\lambda_{\text{peak}}$	502	nm
Spectral Line half-width ( $I_F=20\text{mA}$ )	$\Delta\lambda$	30	nm
Capacitance ( $V_F=0, f=1\text{MHz}$ )	C	90	pF

Part Number	Emitting Color	Emitting Material	Lens-color	Luminous Intensity ( $I_F=20\text{mA}$ ) mcd		Wavelength nm	Viewing Angle
				min.	typ.		
ZAG54W-01	green	InGaN	water clear	40	75	502	120°

# ZAG54W-01

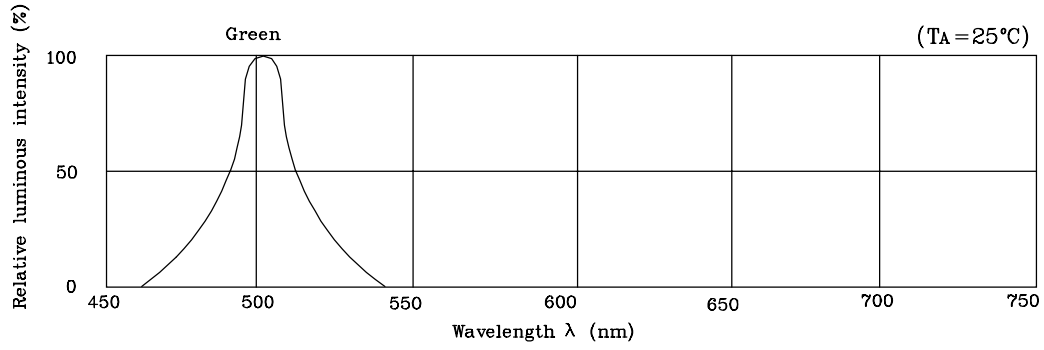

## ◆AG

Forward current derating curve

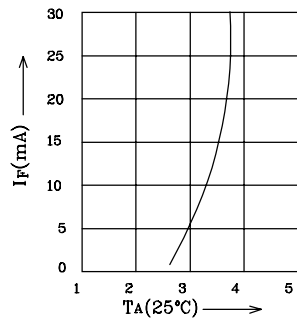

Forward current Vs. Forward voltage

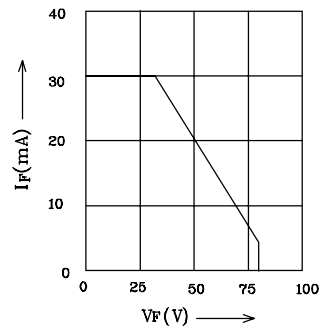

Radiation Characteristics

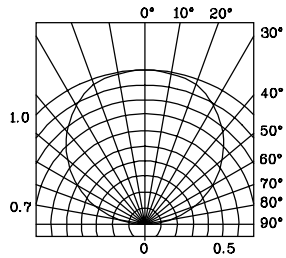

Luminous Intensity Vs. Forward Current

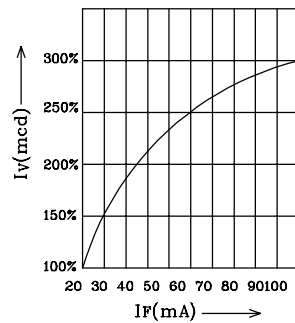

**ZAG54W-01**

**❖SMT Reflow Soldering Instructions**

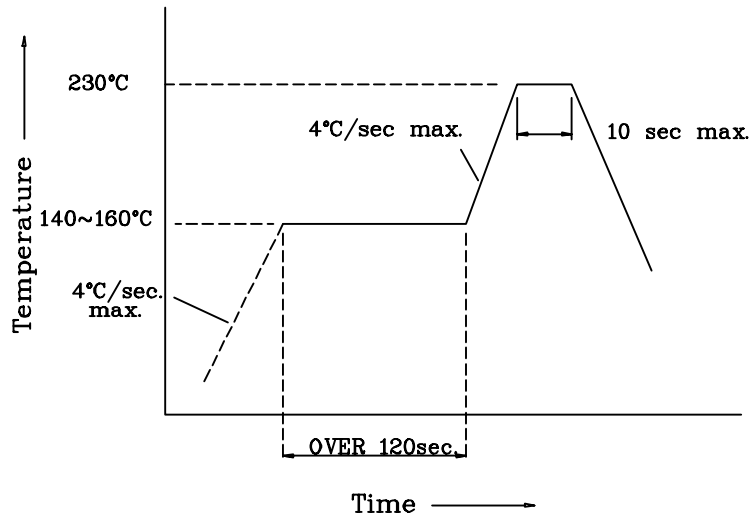

**❖Recommended Soldering Pattern (Units : mm)**

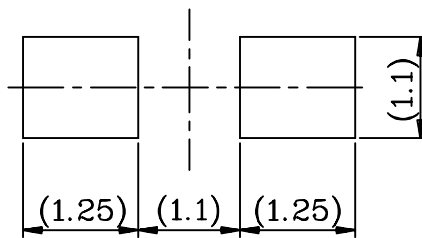

**ZAG54W-01**

**❖ Tape Specification (Units : mm)**

