

The customer is the recipient of technical specifications and is advised to check the drawing against the actual product. The manufacturer is not to be held responsible for any errors or omissions in the drawing or in the product. For any questions or requests for information, please contact the manufacturer or the distributor. The manufacturer is not to be held responsible for any errors or omissions in the drawing or in the product. For any questions or requests for information, please contact the manufacturer or the distributor.

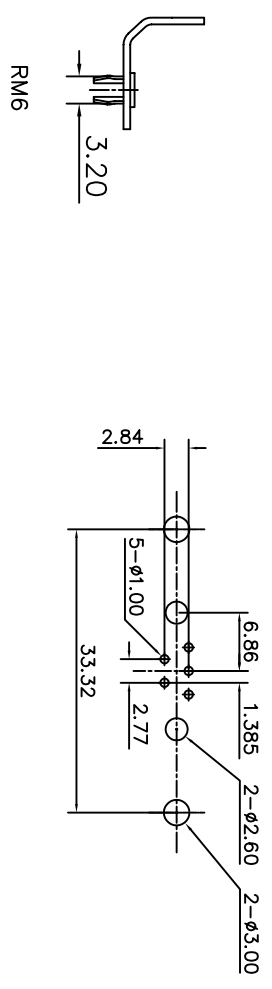

RECOMMENDED P.C.B LAYOUT
(TOLERANCE +/-0.03)

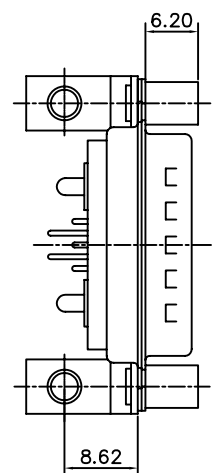
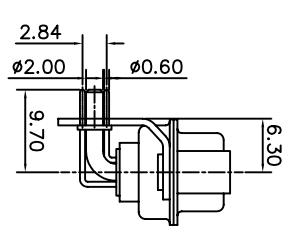
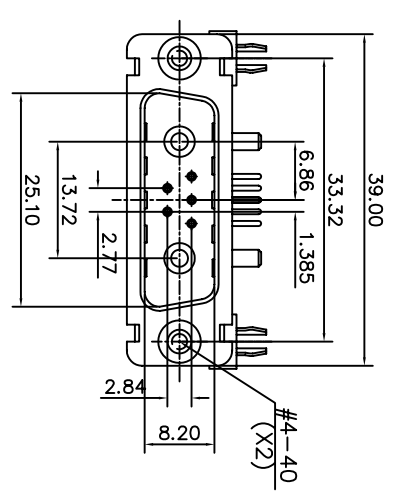

REVISIONS		
SM	ENR	DATE
B		30/12/08

D-SUB TECHNICAL DATA

SHELL : Steel 100u" min tin over 50u" min nickel
 BODY : Glass filled thermoplastic.
 Flame retardant to UL94 V-0
 Color : Black

CONTACTS : Signal contacts material for pins brass.
 Power contacts material : brass

Right angle version:
 Signal contact: 30u" min Full gold over 50u" min nickel
 Front power contact: 30u" min gold over 50" min nickel
 Rear power contact: 100u" min sn over 50" min nickel

BRACKET : Steel ,100u" min, sn over 50u" min nickel
 BOARDLOCK: Phosphor copper, 100u" min sn over 50u" min nickel
 FRONT SCREWLOCK : Brass, 100u" min sn over 50u" min nickel
 ELECTRICAL : Voltage rating 300 V Rms to 50 Hz
 Current rating Singal contacts 7.5A. Power contacts 10 to 40A
 Withstanding Voltage >1000 V Rms to 50 Hz for one minute
 Insulation resistance >5000 M Ohms

Contact resistance 5 mOhms max.
 CLIMATIC : Temperature range -55 °C up to 155°C
 Damp heat 56 days(40 °C-95% HR)
 MECHANICAL : Insertion force per contact<3.41N Max
 Extraction force per contact 0.21N Min.

MARKING : Amphenol...(Series No.)
 Commercial reference
 Manufacturing date

PRODUCT CODE

L717TTW A TW2 P MP2SV 4F RM6

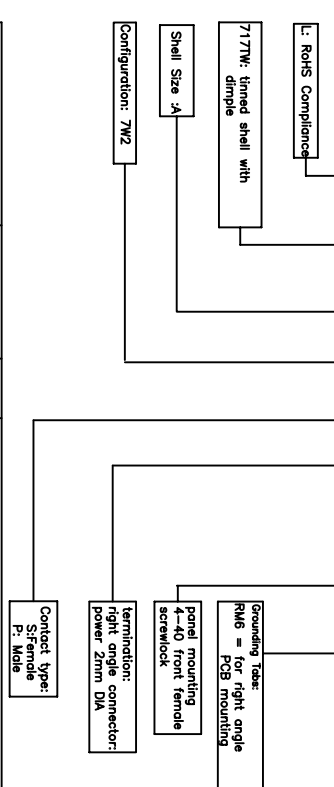

UNLESS OTHERWISE SPECIFIED		APPROVAL		DATE	
TOLERANCES	METRIC	DRAWN	DESIGNED	DATE	DATE
U.S.	0.50	Hyden	Hyden	12/08	12/08
XX +/-	0.30	CHECKED	CHK. using	30/12/08	
XXX +/-	0.20				
FRACTIONS +/-					
ANGLES +/-	2°				

FOR MATERIALS AND FINISHES SEE DRAWING SHEET SHARP EDGES REMOVE SHARP EDGES

ANGLE OF PRODUCTION

TITLE: Hybrid connector, TW series

SIZE: DRAWING NO. A4 C L717TTW A TW2 P MP2SV 4 F RM6 B

SCALE: NONE

REV: SHEET 1 OF 1

