

Quartz Crystal Units AT-Cut, 2.4 - 300 MHz

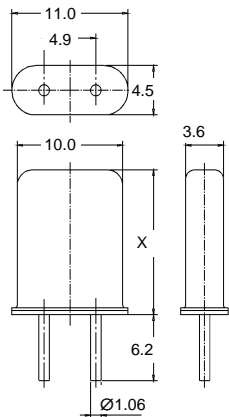

HC-50/U: X = 13.4
 HC-50/11mm: X = 11.5

DIN 45110: M3
 IEC 122-3: DQ
 NFC-93-601: n^o 9
 MIL-H-10056: HC-50/U
 Welded metal enclosure
 (inert atmosphere)
 with pins

All dimensions in mm (max)

HC-50/U			Temperature Stability in the Temperature Range						Nom. Temp. ± 5°C ¹⁾
			-55°C...+105°C		-20°C...+70°C				
Overtone	Frequency [MHz]	Type	± 50ppm	± 25ppm	± 20ppm	± 10ppm	± 7ppm	± 5ppm	± 2ppm
1.OT	2.4...5.2	XS 22xx	01	02	03	04	06	-----	05
	5.2...10	XS 22xx	11	12	13	14	16	17	15
	10...35	XS 23xx	01	02	03	04	06	07	05
3.OT	15...90	XS 24xx	01	02	03	04	06	07	05
5.OT	40...150	XS 25xx	01	02	03	04	06	07	05
7.OT	100...210	XS 26xx	01	02	03	04	06	07	05
9.OT	150...300	XS 26xx	11	12	13	14	16	17	15

Calibration tolerance: ± 10 ppm

¹⁾ Nom. Temp. = Nominal temperature for oven application to be given with the order.

Motional Resistance R1

Overtone	Frequency [MHz]	R1max [Ω]
1. OT	2.4...3	250
1. OT	3...5.2	120
1. OT	5.2...6	80
1. OT	6...8	60
1. OT	8...10	40
1. OT	10...15	30
1. OT	15...35	25
3. OT	20...100	40
5. OT	50...160	60
7. OT	110...210	100
9. OT	150...300	200

Standard resonance for fundamental crystals: load resonance with $C_L = 30 \pm 0.5\text{pF}$
 Overtone crystals: series mode
 Shunt capacitance: $C_0 = 7\text{pF max}$

Crystal units with different tolerances or additional data upon request.

Modifications:

HC-50/U-S, HC-50/11mm-3 MM-S: 3-point mounting for exposure to extreme accelerations (shock and vibration).



VECTRON
 INTERNATIONAL

A DOVER TECHNOLOGIES COMPANY

166 Glover Avenue
 Norwalk, CT 06856

Tel: 1-88-VECTRON-1
 Fax: 1-888-FAX-VECTRON
 www.vectron.com