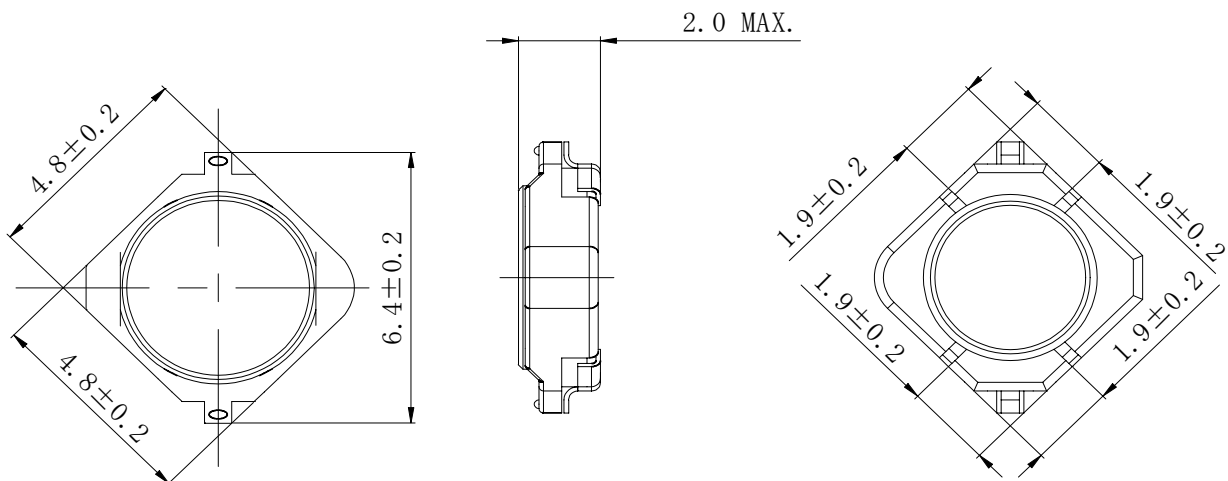
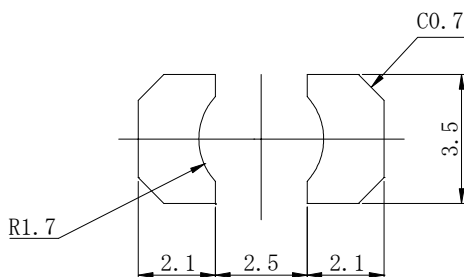

Type: CDC4D20
◆ Product Description

- 5.0×5.0mm Max.(L×W), 2.0mm Max. Height.
- Inductance range: 100 μ H~4.7mH
- Rated current range:34~230mA
- In addition to the standard versions of inductors shown here, custom inductors are available to meet your exact requirements.

◆ Feature

- Magnetically unshielded construction.
- Ideally used in EL drive as EL lamp inverter inductors.
- RoHS Compliance

◆ Dimensions (mm)

◆ Land Pattern (mm)

Type: CDC4D20
◆ Specification

Part Name ※	Stamp	Inductance (μ H) [Within] 100kHz	D.C.R.(Ω) Max.(Typ.) (at 20°C)	Saturation Current (mA) ※1	Temperature Rise Current (mA) ※2
CDC4D2ØNP-1Ø1K□	A	100 μ H \pm 10%	1.77 (1.48)	275	230
CDC4D2ØNP-121K□	B	120 μ H \pm 10%	1.97(1.65)	250	220
CDC4D2ØNP-151K□	C	150 μ H \pm 10%	2.61(2.18)	230	195
CDC4D2ØNP-181K□	D	180 μ H \pm 10%	2.73(2.28)	210	190
CDC4D2ØNP-221K□	E	220 μ H \pm 10%	3.20(2.67)	190	180
CDC4D2ØNP-271K□	F	270 μ H \pm 10%	3.66(3.05)	170	160
CDC4D2ØNP-331K□	G	330 μ H \pm 10%	5.16(4.30)	160	135
CDC4D2ØNP-391K□	H	390 μ H \pm 10%	5.66(4.72)	140	130
CDC4D2ØNP-471K□	J	470 μ H \pm 10%	7.30(6.08)	130	110
CDC4D2ØNP-561K□	K	560 μ H \pm 10%	8.40(6.99)	120	105
CDC4D2ØNP-681K□	L	680 μ H \pm 10%	9.60(8.00)	110	90
CDC4D2ØNP-821K□	M	820 μ H \pm 10%	14.1(11.7)	100	75
CDC4D2ØNP-1Ø2K□	N	1.0mH \pm 10%	16.2(13.5)	90	70
CDC4D2ØNP-122K□	P	1.2mH \pm 10%	18.6(15.5)	80	65
CDC4D2ØNP-152K□	Q	1.5mH \pm 10%	23.8(19.8)	75	55
CDC4D2ØNP-182K□	R	1.8mH \pm 10%	27.1(22.6)	65	55
CDC4D2ØNP-222K□	S	2.2mH \pm 10%	31.6(26.3)	60	50
CDC4D2ØNP-272K□	T	2.7mH \pm 10%	38.9(32.4)	55	45
CDC4D2ØNP-332K□	U	3.3mH \pm 10%	43.7(36.4)	50	40
CDC4D2ØNP-392K□	V	3.9mH \pm 10%	50.9(42.4)	45	38
CDC4D2ØNP-472K□	W	4.7mH \pm 10%	72.1(60.0)	40	34

※ Description of part name

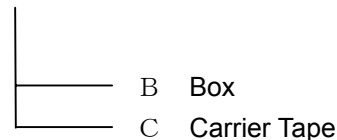
C D C 4 D 2 Ø N P - 1 Ø 1 K □



※1: Saturation current: The DC current at which the inductance decreases to 90% of its initial value.
(Ta=20°C).

※2: Temperature rise current: The DC current at which the temperature rise is $\Delta t=40^\circ\text{C}$. (Ta=20°C).