

SOLDER SUFFIX	CUSTOMER TERMINAL	RoHS	LEAD(Pb)-FREE
LF1	Sn96%, Ag4%	Yes	Yes

TERM. NO.'s FOR REF. ONLY
CUSTOMER TERM. NO.'s IN ()

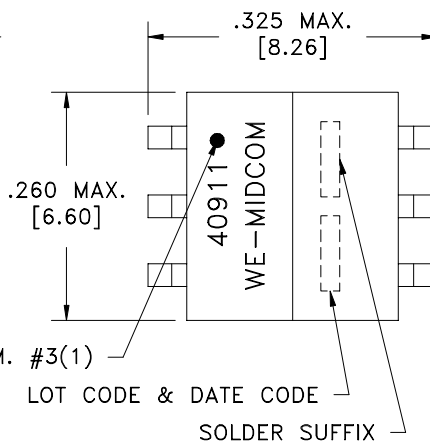
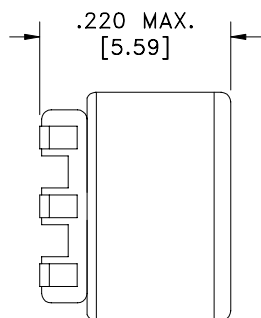
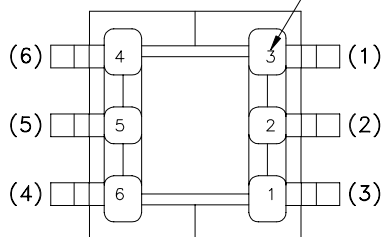

DOT LOCATES TERM. #3(1)

LOT CODE & DATE CODE

SOLDER SUFFIX

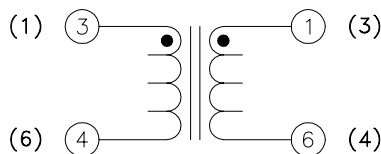

AREA REPRESENTS
TERMINAL PAD DIMENSIONS

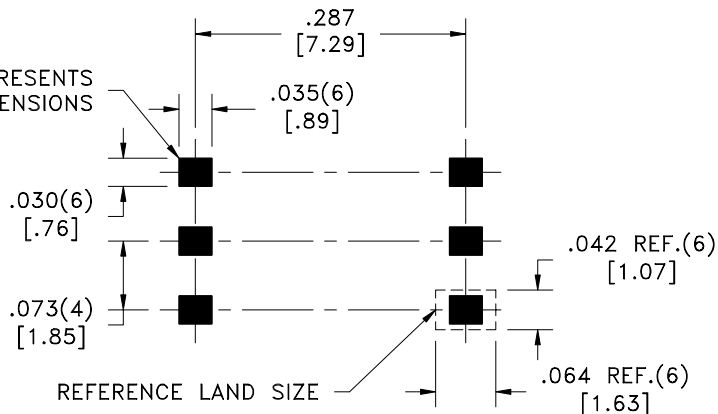

REFERENCE LAND SIZE

CUSTOMER TO DETERMINE LAND LAYOUT

ELECTRICAL SPECIFICATIONS @ 25°C unless otherwise noted:

D.C. RESISTANCE (@20°C): 3-4, 3.90 ohms ±10%.
1-6, 3.90 ohms ±10%.

DIELECTRIC RATING: 500VDC, 1 minute tested by applying 625VDC for 1 second between 3-1.

INDUCTANCE: 250uH ±5%, 100kHz, 100mVAC, 3-4; 1-6, Ls.
1.00mH ±10%, 100kHz, 100mVAC, 0/120mADC, 3-6(tie 1+4), Ls.

TURNS RATIO: (3-4):(1-6) = 1:1, ±1%.

OPERATING TEMPERATURE RANGE: -40°C to +85°C.

DETAILS SUBJECT TO CHANGE

Unless otherwise specified:
Tolerances:
Angles: ±1°
Fractions: ±1/64
Decimals: ±.005[.13]

DRAWING TITLE

INDUCTOR

eiSos p/n: 750040911



DRAWING NO.

40911R-LF1

REV.

6B
5/07

REVISIONS: SEE SHEET 1

SCALE ---

SHEET 2 OF 5

DWG # 40911R-LF1

This drawing is dual dimensioned.
Dimensions in brackets are in millimeters.