

Specifications:

| | |
|-----------------------|---|
| plug description (1) | Ø2.1 x 5.5 x 22 ±0.5 with black insulator |
| plug overmold (2) | 30P, black PVC (including strain relief) |
| cable description (3) | 0.16 x 41, 2 conductor, black twin wire |
| cable outer diameter | 4.6 ± 0.1 (each conductor 2.3) |
| cable material | UL 2468 |
| cable color | black |
| cable gauge | AWG #18 |
| cable length | 1830 |
| twist tie (4) | black |
| max voltage | 36 Vdc |
| max current | 3 A |

Notes: RoHS compliant

Function test: no open, no reversed polarity, no short circuit, no INT

Hi-Pot test: 600 Vac, 05 mA, 1 second

Mechanical drawing:

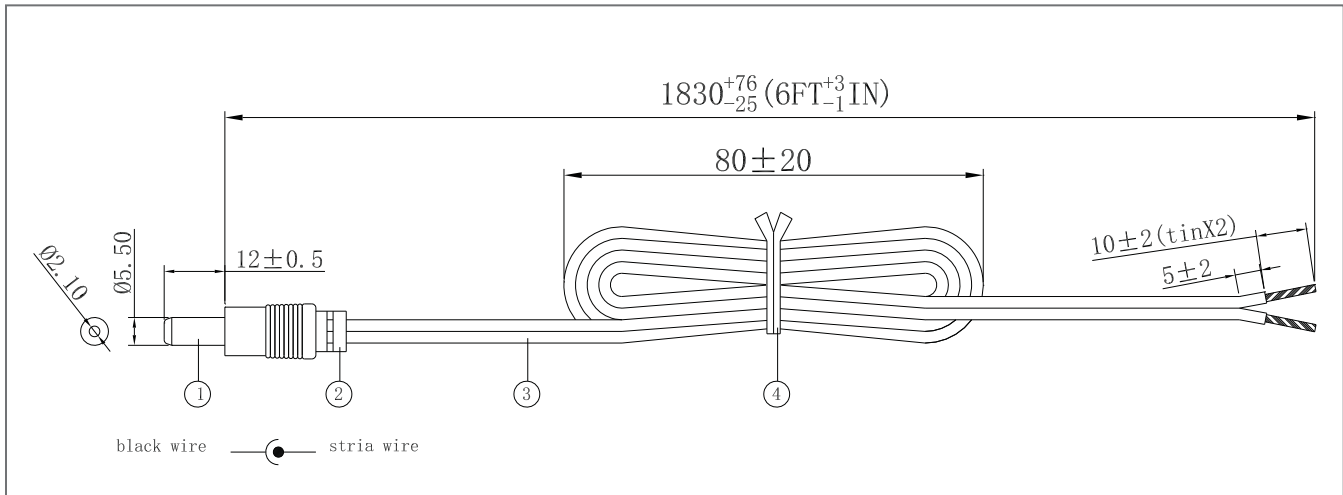

tolerance X: ±0.5 mm .X: ±0.25 mm .XX: ±0.05 mm

Revision notes:

| Rev | Date | Description |
|-----|------------------|---|
| A | January 19, 2009 | Re-issued; original specification issued by CUI, re-issued by Tensility without any material or mechanical changes. |
| | | |
| | | |
| | | |
| | | |

tolerance X: ± 0.5 mm .X: ± 0.25 mm .XX: ± 0.05 mm