

Spezifikation für Freigabe / specification for release

Kunde / customer :

Artikelnummer / part number :

74466240007 LF



Bezeichnung : **STROMKOMPENSIERTE DROSSEL WE-LF**
 description : **CURRENT-COMPENSATED CHOKE WE-LF**

DATUM / DATE : 2012-07-08

A Mechanische Abmessungen / dimensions:

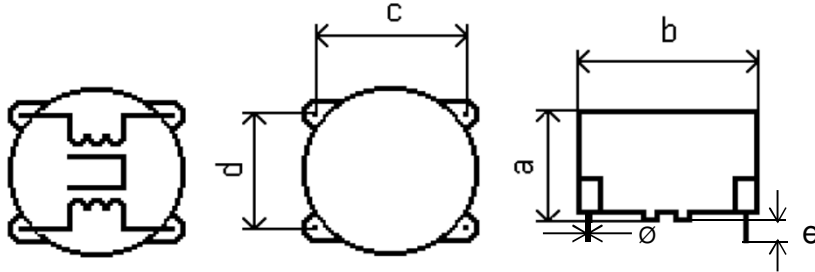

Gehäuse / case: SH		
a	13,0 max	mm
b	18,0 max	mm
c	15,0 ± 0,2	mm
d	10,0 ± 0,2	mm
e	3,0 ± 0,5	mm
Ø	0,6 x 0,6 typ	mm

B Elektrische Eigenschaften / electrical properties:

C Lötpad / soldering spec.:

Eigenschaften / properties	Testbedingungen / test conditions		Wert / value	Einheit / unit	tol.
Leerlauf-Induktivität / inductance	10 kHz / 50 mV / 25 °C	L _O	0.7	mH	±30%
DC-Widerstand / DC-resistance		R _{DC}	0.027	Ω	max.
Nennstrom / nominal current		I _N	4.0	A	
Nennspannung / nominal voltage	50 Hz	U _N	250	V	

D Prüfgeräte / test equipment:

E Testbedingungen / test conditions:

FLUKE PM 6306 für/for L₀/L_N
HP 34401 A für/for I_N und/and R_{DC}

Luftfeuchtigkeit / humidity: 33%
 Umgebungstemperatur / temperature: +25 °C
 Prüfspannung / testing voltage: 1500 V, 50 Hz

F Werkstoffe & Zulassungen / material & approvals:

G Eigenschaften / general specifications:

Gehäuse / case: UL94V-0
 Draht / wire: P155 IEC317-20
 Verguß / molding: UL94V-0

Klimabeständigkeit/ climatic class: 40/125/21
 Betriebstemp. / operating temperature: -40 °C - + 125 °C
 Übertemperatur / temperature rise: < 55 K
 It is recommended that the temperature of the part does not exceed 125 °C under worst case operating conditions.

Freigabe erteilt / general release:		Kunde / customer			
.....		
Datum / date	Unterschrift / signature	HasA	Version 5 12-08-07
				HasA	Version 4 11-08-22
				MST	Version 3 05-11-21
				MST	Version 2 05-01-18
				MST	Version 1 04-10-11
Geprüft / checked	Kontrolliert / approved	Name	Änderung / modification Datum / date

This electronic component has been designed and developed for usage in general electronic equipment. Before incorporating this component into any equipment where higher safety and reliability is especially required or if there is the possibility of direct damage or injury to human body, for example in the range of aerospace, aviation, nuclear control, submarine, transportation, (automotive control, train control, ship control), transportation signal, disaster prevention, medical, public information network etc, Würth Elektronik eiSos GmbH must be informed before the design-in stage. In addition, sufficient reliability evaluation checks for safety must be performed on every electronic component which is used in electrical circuits that require high safety and reliability functions or performance.

Würth Elektronik eiSos GmbH & Co. KG

D-74638 Waldenburg · Max-Eyth-Strasse 1 -3 · Germany · Telefon (+49) (0) 7942 - 945 - 0 · Telefax (+49) (0) 7942 - 945 - 400
<http://www.we-online.com>