

825-11-9

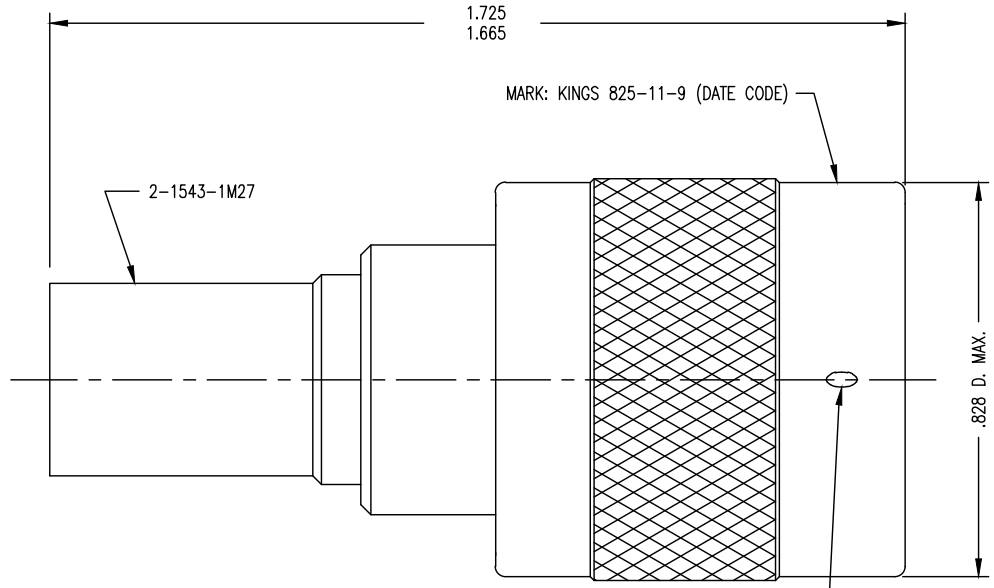

- NOTES:
- FOR USE WITH BOEING BMS13-65 OH & ADAMS RUSSELL FC28Z CABLE.
 - FOR CABLING INSTRUCTIONS SEE 3-546-2.
 - FOR CRIMPING USE DIE KTH-2212.
 - INTERFACE PER MIL-STD-348, FIG. 309-1.
 - CENTER CONTACT (1-903-21MA9) SUPPLIED UNASSEMBLED.
 - MARK PACKAGE: KINGS 825-11-9 (DATE CODE)
 - MATERIALS:
 - INSULATOR: TEFLON, ASTM D1710
 - GASKET: SIL. RUB., A-A-59588
 - C-RING: PHOS. BRONZE, ASTM B103
 - K-GRIP SLEEVE: COM. BRONZE TUBE, ASTM B135
 - OUTER CONTACT: BER. COP., ASTM B196
 - ALL OTHER PARTS: BRASS, ASTM-B16
 - FINISHES:
 - CENTER CONTACT: .000050 MIN GOLD PLATE, PER ASTM B488 OVER .000050 MIN. NICKEL PER AMS-QQ-N-290 (RoHS)
 - OUTER CONTACT: SILVER PLATE PER ASTM B700
 - ALL OTHER METAL PARTS: .000050 MIN NICKEL PER AMS-QQ-N-290 OVER .000050 MIN COPPER PER ASTM B734 (RoHS)
 - ELECTRICAL CHARACTERISTICS:
 - NOMINAL IMPEDANCE: 50 OHMS
 - VOLTAGE RATING: 1000 VRMS
 - FREQUENCY RANGE: DC TO 11GHz
 - WIEGHT: 33.5 GRAMS

REVISIONS	
ISSUE	CHANGES
0	ER 33836 JCA 04/16/92
B	REVISED PER DMF 304 & ER34974 KPL 09/20/11
CUSTOMER SALES DRAWING	
THIS DRAWING, THE DESIGNS AND IDEAS EMBODIED IN THE DEVICE TO WHICH IT RELATES, AND THE METHOD OF PRODUCING THE DEVICE, ARE THE PROPERTY OF WINCHESTER ELECTRONICS CORPORATION AND SHALL NOT BE EMPLOYED, COPIED, OR DISCLOSED TO ANYONE, IN ANY MANNER WITHOUT THE CONSENT OF WINCHESTER ELECTRONICS CORPORATION.	
SCALE 4:1	
APPROX SURFACE AREA	
WAS: E-17397	
CAGE CODE: 91836	
REF: BOEING	
PLUG, SC	
DRAWN JCA	DATE 04/16/92
DESIGN JT	DATE 04/20/92
APPR.	DATE
 Winchester Electronics Corporation 82 Barnes Industrial Road North Wallingford, Connecticut 06492	
825-11-9	