

## 1. CONFIGURATION & DIMENSIONS :

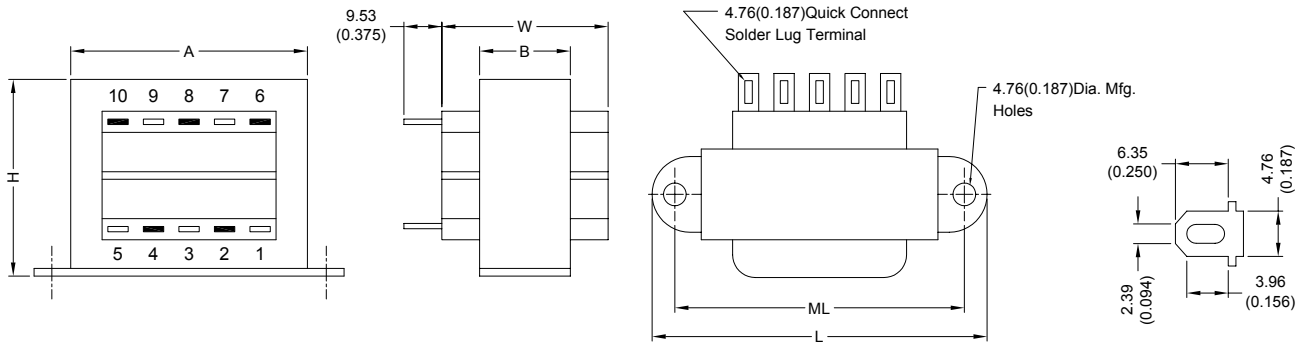

UNIT : mm (inch)

SIZE	VA	L	W	H	A	B	ML	gram
7	56	93.68 (3.688)	46.05 (1.813)	57.15 (2.250)	68.28 (2.688)	27.00 (1.063)	79.38 (3.125)	771.11

## 2. SCHEMATIC :

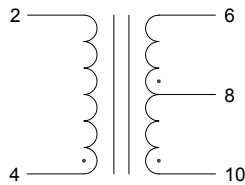

" . " indicates polarity

## 3. ELECTRICAL CHARACTERISTICS (@ 25°C) :

a. Primary Voltage	AC 115 V 60 Hz .
b. No Load Primary Current	Less Than 30mA .
c. Secondary Voltage (±5%)	
Pin 6-10 C.T. Pin 8	AC 40.2 V .
d. Secondary Load Current	1.80A .
e. Full Load Primary Current	Less Than 620mA .
f. Full Load Secondary Voltage (±5%)	30.00V .
Pin 6-10 C.T. Pin 8	
g. DC Resistance	
Pin 2-4	Primary = 10.50 Ohm .
Pin 6-8	Secondary-1 = - Ohm .
Pin 8-10	Secondary-2 = - Ohm .
h. Insulation Resistance	DC 500V 100Meg Ohm Of More .
i. Withstand Voltage (Hi-Pot)	AC 2500V 60Hz 1 Minutes .
j. Temperature Rise	Less Than 60 Deg C .
k. Core Size	EI-66 x 26.00 m/m .
l. Turns & Wire Gauge	
Primary Pin 2-4	585 Turns Diameter : 0.40 mm
Secondary Pin 6-8-10	0-103-206 Turns Diameter : 0.65 mm



**RoHS Compliant**

NOTE : Specifications subject to change without notice. Please check our website for latest information.

25.02.2008



**SUPERWORLD ELECTRONICS (S) PTE LTD**

PG. 1