

# 2.50mm PITCH BATTERY CONNECTOR

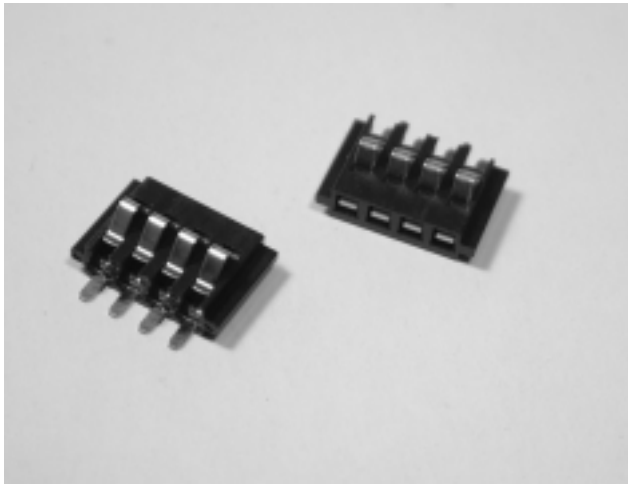

## 250105MR Series

### Specifications:

- **Insulator Material** : Black High Temp. Plastic
- **Operating Type Range** : -40°C TO +105°C
- **Terminal Material** : Phos. Bronze
- **Platings** : Contact-Selective Gold Plated or Full Gold Plated
- **Max. Current Rating** : 1.0A
- **Max. Voltage Rating** : 200V AC
- **Dielectric Strength** : 500V AC For 60 Seconds

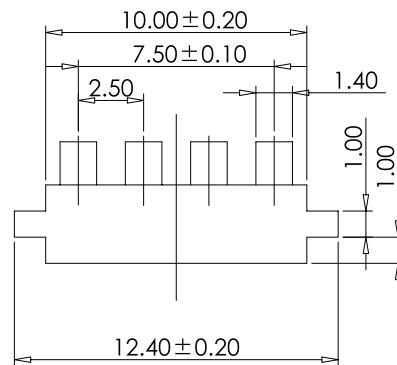
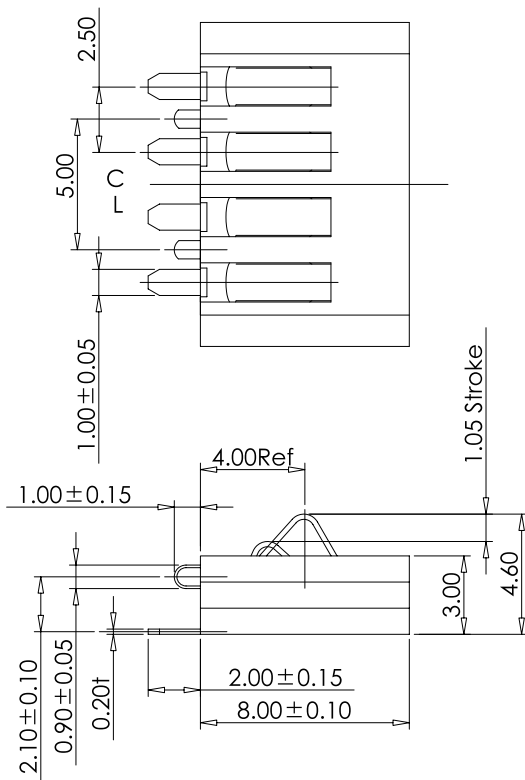

## Order Information

250105MR004□□05ZU  
 1 2 3 4 5

1. 'R' : Right Angle Dip Type
  2. No. of Pins.
  3. Plating
  4. Color 'Z' : Black
  5. Package
- 'U' : Tube Package Without Cap  
 Reference Page 11

## Recommended P.C.B Layout

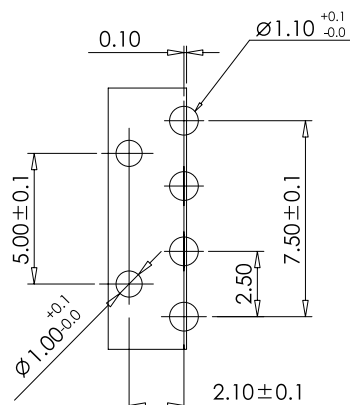

Mobile

BATTERY