

1. CONFIGURATION & DIMENSIONS :

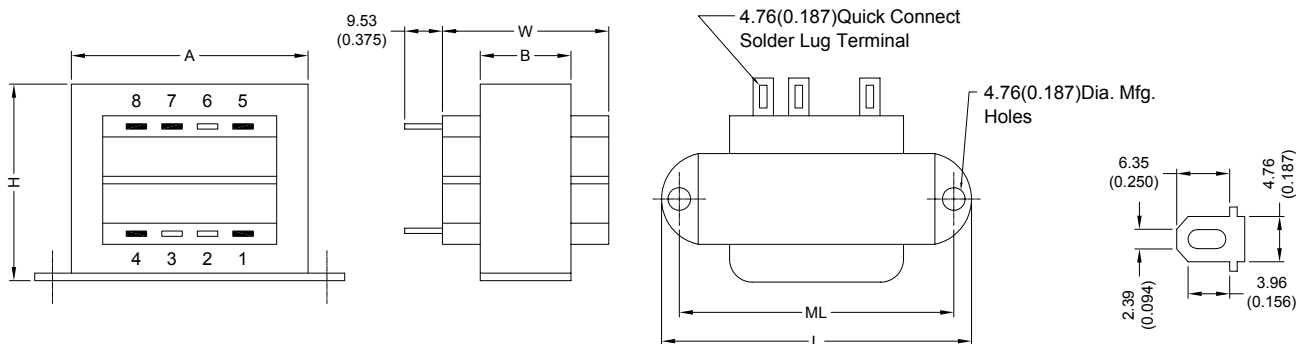

UNIT : mm (inch)

| SIZE | VA | L | W | H | A | B | ML | gram |
|------|-----|------------------|------------------|------------------|------------------|------------------|-----------------|--------|
| 3 | 2.4 | 52.40 (2.063) | 27.00 (1.063) | 30.18 (1.188) | 41.28 (1.625) | 14.30 (0.563) | 44.45 (1.75) | 113.40 |

2. SCHEMATIC :

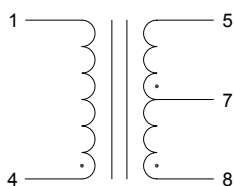

" . " indicates polarity

3. ELECTRICAL CHARACTERISTICS (@ 25°C) :

- | | |
|--------------------------------------|------------------------------|
| a. Primary Voltage | AC 115 V 60 Hz . |
| b. No Load Primary Current | Less Than 10mA . |
| c. Secondary Voltage (±5%) | |
| Pin 5-8 C.T. Pin 7 | AC 110.2 V . |
| d. Secondary Load Current | 0.03A . |
| e. Full Load Primary Current | Less Than 40mA . |
| f. Full Load Secondary Voltage (±5%) | 88.00V . |
| Pin 5-8 C.T. Pin 7 | |
| g. DC Resistance | |
| Pin 1-2 | Primary = 320 Ohm . |
| Pin 5-7 | Secondary-1 = - Ohm . |
| Pin 7-8 | Secondary-2 = - Ohm . |
| h. Insulation Resistance | DC 500V 100Meg Ohm Of More . |
| i. Withstand Voltage (Hi-Pot) | AC 2500V 60Hz 1 Minutes . |
| j. Temperature Rise | Less Than 60 Deg C . |
| k. Core Size | EI-35 x 13.00 m/m . |

l. Turns & Wire Gauge

Primary Pin 1-4 2889 Turns Diameter: 0.11 mm
 Secondary Pin 5-7-8 0-1279-2538 Turns Diameter: 0.09 mm



RoHS Compliant

NOTE : Specifications subject to change without notice. Please check our website for latest information.

25.02.2008



SUPERWORLD ELECTRONICS (S) PTE LTD