

MODS-D-6PXC-X-N-SM-X

TYPE -D

POSITIONS/CONTACTS
 -6P4C: 6 Pos/4 Con
 -6P6C: 6 Pos/6 Con

PLATING
 -S: .000030" Au
 (SEE NOTE 2)
 -L: .000010" Au
 -U: .000050" Au

OPTION
 -N: NO FLANGE

RA TERMINATION
 -SM: SURFACE MOUNT

E & I OPTION
 -R: RoHS COMPLIANT

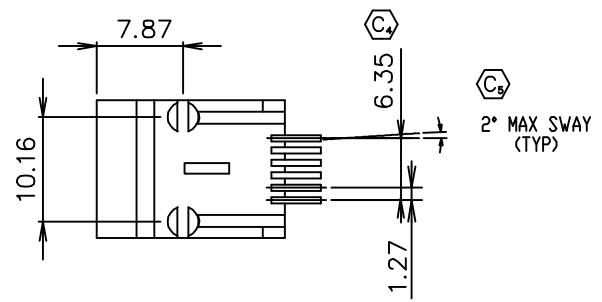
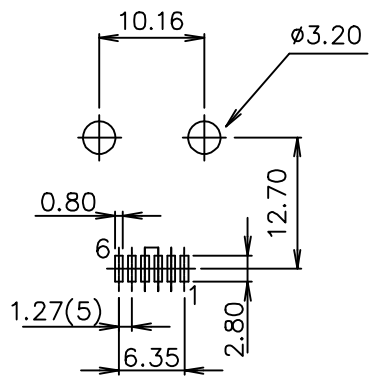

PCB LAYOUT

NOTES:

1. (C) REPRESENTS A CRITICAL DIMENSION
2. PLATING APPLIES TO MATING AREA, GOLD FLASH ON TAILS.

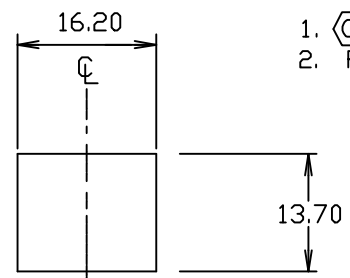

DO NOT SCALE FROM THIS PRINT

SUGGESTED PANEL CUTOUT DIMENSIONS

UNLESS OTHERWISE SPECIFIED, DIMENSIONS ARE IN MM. TOLERANCES ARE:
 DECIMALS X.XX±0.25
 X.XXX±0.13
 X.XXXX±0.05

ANGLES ±3

PROPRIETARY NOTE
 THIS DOCUMENT CONTAINS INFORMATION CONFIDENTIAL AND PROPRIETARY TO SAMTEC INC. AND SHALL NOT BE REPRODUCED OR TRANSFERRED TO OTHER DOCUMENTS OR DISCLOSED TO OTHERS OR USED FOR ANY PURPOSE OTHER THAN THAT FOR WHICH IT WAS OBTAINED WITHOUT THE EXPRESSED WRITTEN CONSENT OF SAMTEC INC.

DO NOT SCALE DRAWING
 INSULATOR: Nylon 46 (UL 94V-0) Black
 CONTACT : Phosphor Bronze
 SHELL : Copper Alloy
 MAX FLASH ALLOWED: .051
 MAX GATE VESTIGE: .051
 MISC/MKGT

SHEET SCALE: 1:2

samtec		520 PARK EAST BLVD. NEW ALBANY, IN 47150 (812) 944-6733 P.O. BOX 1147 TWX: 810-540-4085	CODE: 55372
DESCRIPTION:		RJ11 Low Profile PCB Jack	
DWG. NO.		MODS-D-6PXC-X-N-SM-X	
BY: J. Riley 4/19/04		SHEET 1 OF 1	