

THIS DRAWING CONTAINS INFORMATION PROPRIETARY TO POSITRONIC INDUSTRIES INC. THE DATA ON THIS DRAWING TO BE RELEASED SINCE THE USER EMPLOYS SUCH INFORMATION AT HIS OWN DISCRETION. RESULTS OBTAINED OR DAMAGES INCURRED FROM USE OF SUCH INFORMATION IN WHOLE OR IN PART.

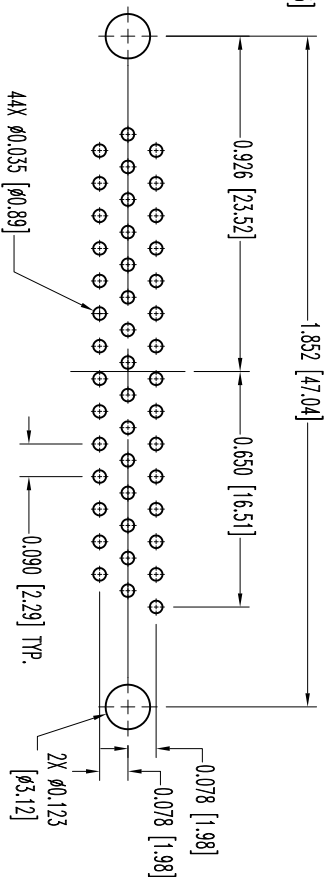
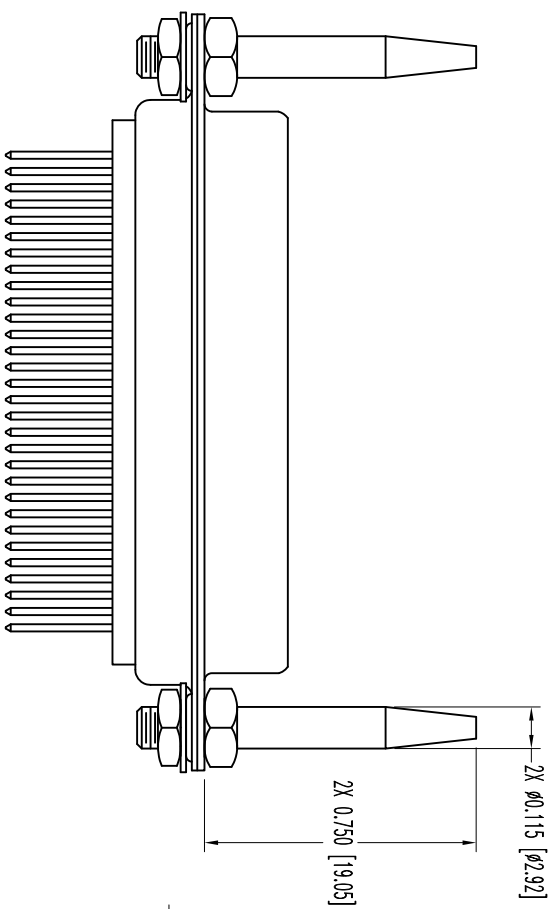
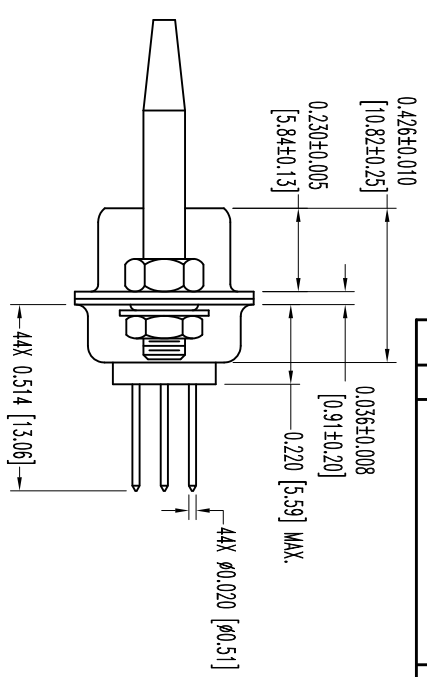
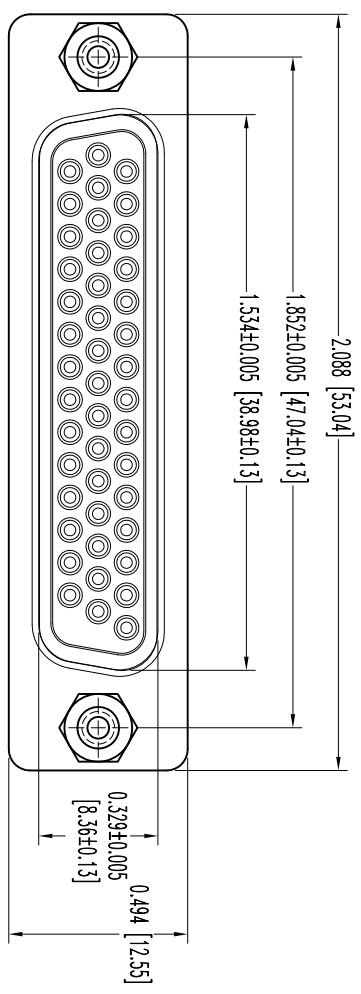

CONTACT HOLE PATTERN

NOTES:
 1. MATERIALS AND FINISHES:
 INSULATOR: GLASS FILLED POLYESTER PER ASTM-D5927, UL 94V-0, COLOR: BLACK.
 CONTACTS: PRECISION MACHINED COPPER ALLOY, GOLD FLASH OVER NICKEL PLATE.
 SHELLS: STAINLESS STEEL, PASSIVATED.
 INTERFACIAL SEAL: THERMOPLASTIC ELASTOMER.
 BLIND-MATE GUIDES: STAINLESS STEEL, PASSIVATED.
 2. DETAILED PRODUCT, MECHANICAL, AND ELECTRICAL INFORMATION IS AVAILABLE IN THE LATEST HIGH DENSITY D-SUB PRODUCT PUBLICATION. VISIT CONNECTROSTRONIC.COM/PRODUCTS/59/HIGHDENSITY-D-SUBMINIATURE-OR-CONNECTROSTRONIC.COM.
 3. MOS CALLS FOR CONNECTOR TO BE SUPPLIED WITH SPECIAL SOLDER-DIP CONTACT TAILS THAT EXTEND 0.514 [13.06] BELOW SHELL FLANGE AND SPECIAL BLIND MATE GUIDES, SHELL HALVES AND MOLDING HALVES TO BE SEALED WITH RHY1106 OR EQUIVALENT. CONNECTOR TO BE PERMANENTLY MARKED WITH P+ PART NUMBER, DATE CODE AND CAGE CODE.
 4. DIMENSIONS ARE IN INCHES [MILLIMETERS].

DATE	REV	REVISION RECORD	APP	DR	CK
9-02	NC	ECO 34431	COL	BS	COL

SK12624



POSITRONIC INDUSTRIES INC.
www.connectrostronic.com
 FSC# 28198

DECIMAL TOL.	± 0.015 [0.38]	SCALE	N.T.S.	DRAWN BY	B SHELLARDY
ANGULAR TOL.	± 5°	DD SERIES	DD44P3S200S-792.99	APPROVED BY	COL
DATE	9-02-11	DRAWING NUMBER	SK12624	REV.	NC