

REVISION U

NOTES:

- HEIGHT VARIATION BETWEEN ANY TWO PINS SHALL BE .005 [1.13] MAX.
- MAXIMUM PIN ROTATION IN BODY: 2°.
- TAILS TO BE SHEARED TO ACHIEVE DIMENSIONAL CALLOUT +/- .010.
- MINIMUM PUSHOUT FORCE: 3 lbs.
- MAXIMUM ALLOWABLE BURR: .0015 [.038].
- THROUGH HOLES (-S & -RA) ARE TO BE BULK PACKAGED.
- SURFACE MOUNT (-VS) IS TO BE PACKAGED AS FOLLOWS:
POSITIONS -04 THRU -20 ARE TO BE TUBE PACKAGED;
POSITION -02 TO BE LAYER PACKAGED,
-03 POSITION TO BE TUBE OR LAYER PACKAGED
MAX CUT FLASH TO BE .020.
- ⊙ REPRESENTS A CRITICAL DIMENSION.
- COPLANARITY (-VS); POSITIONS -02 THRU -15: .008 [.20],
POSITIONS -16 THRU -20: .010 [.25]

UNLESS OTHERWISE NOTED		TOLERANCES ARE:	TITLE:	DWG NO:
ONE PLACE DECIMALS ±.1[2.5]	THREE PLACE DECIMALS ±.003[.08]	ANGLES ± 2°	.200 HIGH POWER BLOCK, ASM	HPM-XX-XX-XX-X-XX-X
TWO PLACE DECIMALS ±.01[.25]	FOUR PLACE DECIMALS ±.0015[.038]			

TABLE 3

FORM	BODY	MATERIAL
T/H	FSW-20-200	VALOX 420SEO BLACK OR
RA	FSW-20-200	CRASTIN SK652FR BLACK
VS	HFSW-20-200	VECTRA E130I NATURAL

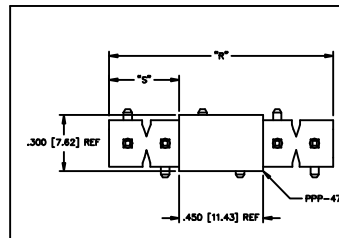
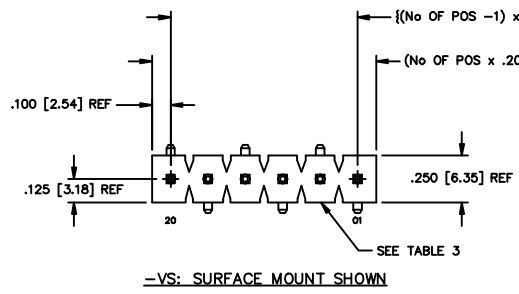
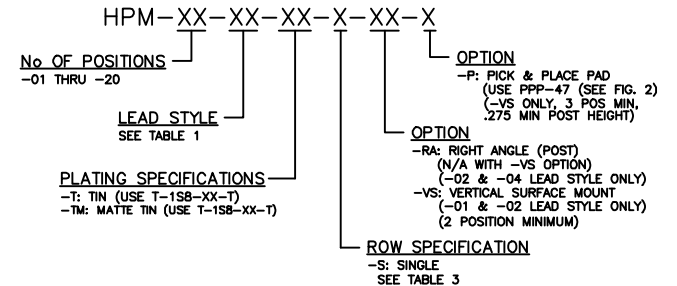

NOTE:
"T" = No OF POS x .200 [5.08] REF
"S" = (["T" - .450 [11.43]] / 2) ±.020 [12.90]
"O" = POST HEIGHT + .050 [1.27] REF

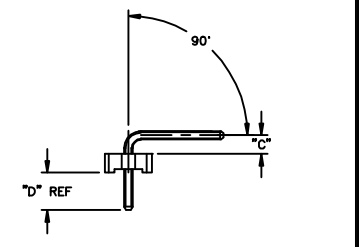
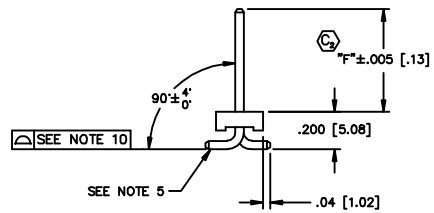
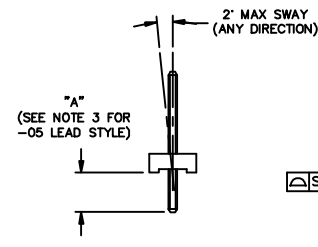
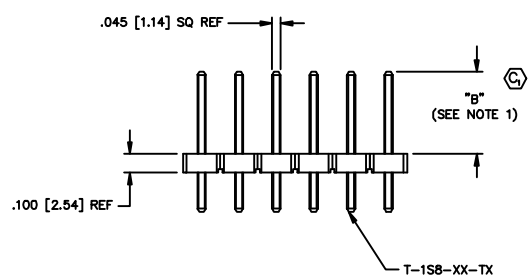
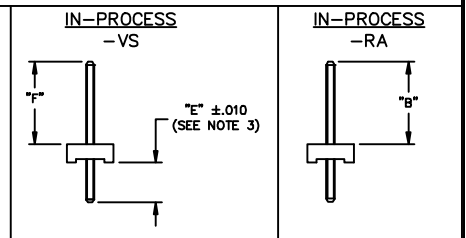

-S: SINGLE
-01, -02, -04 & -05 & -06

-VS: SURFACE MOUNT
-01 & -02 ONLY

-RA: RIGHT ANGLE
-02 & -04 ONLY

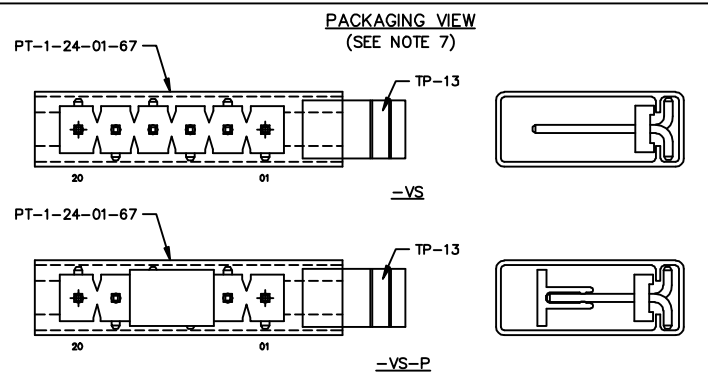

TABLE 1

STYLE	TERMINAL	"A"	"B"	"C"	"D"	"E"	"F"
-01	T-1S8-11-TX	.180 [4.57]	.470 [11.94]	N/A	N/A	.213±.010 [5.41±.25]	.422 [10.72]
-02	T-1S8-12-TX	.180 [4.57]	.520 [13.21]	.100 [2.54]	.175 [4.45]	.213±.010 [5.41±.25]	.482 [12.24]
-04	T-1S8-14-TX	.161 [4.09]	.829 [21.06]	.195 [4.95]	.156 [3.96]	N/A	N/A
-05	T-1S8-11-TX	.180 [4.57]	.150 [3.81]	N/A	N/A	N/A	N/A
-06	T-1S8-15-TX	.180 [4.57]	1.070 [27.18]	N/A	N/A	N/A	N/A

MATERIAL:
BODY: SEE TABLE 3
TERMINAL: CDA7025
GRADE TL02
MAX BOW ALLOWED: .003 IN/IN
PLOT SCALE: .375/ DIMSCALE: .350

EXISPROD\ASSEMBLY\200
HPM-ASM

samtec

520 PARK EAST BLVD. NEW ALBANY, INDIANA 47150
PHONE (812) 944-6733 P.O. BOX 1147
CODE 55322

MADE BY: BURREN 08-21-98 HPM-XX-XX-XX-X-XX-X

PROPRIETARY NOTE
THIS DOCUMENT CONTAINS INFORMATION CONFIDENTIAL AND PROPRIETARY TO SAMTEC INC. AND SHALL NOT BE REPRODUCED OR TRANSMITTED IN ANY FORM OR BY ANY MEANS, ELECTRONIC OR MECHANICAL, INCLUDING PHOTOCOPYING, RECORDING, OR BY ANY INFORMATION STORAGE AND RETRIEVAL SYSTEM, WITHOUT THE WRITTEN CONSENT OF SAMTEC INC.