

TECHNICAL SPECIFICATION

INSULATOR MATERIAL : THERMOPLASTIC POLYESTER UL94V-0 , GREY
 HOUSING CAN WITHSTAND EXPOSURE TO LEAD FREE WAVE SOLDERING TEMPERATURE OF 260-265°C FOR STRAIGHT CONNECTORS AS IT IS IN CLASSICAL LEAD WAVE SOLDERING AT 235-250°C.
 CONTACT MATERIAL : COPPER ALLOY
 CONTACT PLATING : GOLD OVER NICKEL
 ACTIVE ZONE : GOLD OVER NICKEL
 TERMINATION ZONE : TIN LEAD VERSION - TIN LEAD OVER NICKEL
 LEAD FREE VERSION - Sn (MATTE TIN) OVER Ni
ELECTRICAL DATA
 CURRENT RATING AT 20°C : 1.5 A
 CURRENT(I MAX.) : 2 A
 TEMPERATURE RANGE : -55°C/+125°C
 CONTACT RESISTANCE : ≤ 20mΩ
 INSULATION RESISTANCE : ≥ 10⁶ MΩ
 TEST VOLTAGE (rms) : 1000V

MECHANICAL DATA

INSERTION FORCE PER CONTACT : ≤ 0.94N
 EXTRACTION FORCE PER CONTACT : ≥ 0.15N

REFERENCE SPECIFICATIONS : DIN 41612 / IEC 603-2

SERIES	8609	3	63	8	1	14	7	5	0	F20E1
ROWS FITTED WITH CONTACTS										
Rows a b c		3	63							
NUMBER OF CONTACTS										
TYPE OF INSULATOR										
3 ROW FEMALE INSULATOR										8
METHOD OF MOUNTING										
STANDARD MOUNTING - STYLE C										1
TERMINATION										
SHORT STRAIGHT SPILL (L = SEE TABLE)										24
LONG STRAIGHT SPILL (L = SEE TABLE)										14
OPTIONS										
NO OPTION										7
PERFORMANCE CLASS										
DIN 41612 CLASS 3										4
DIN 41612 CLASS 2										5
DIN 41612 CLASS 1										6
AS PER MIL C 55302/ JSS 50808										8
PITCH PER ROW										
MIXED PITCH										0

SPECIAL CODE: F20E1 - SPL. CONTACTS LOADING-TIN LEAD VERSION
 CONTACTS LOADED IN a 1,2,3 6,7,8 12,13 16,17,18,19 22,23,24,25,26 28,29,30,31,32
 b 1,2,3 6,7,8 12,13 20 22,23,24,25,26 28,29,30,31,32
 c 1,2,3 6,7,8 12,13 16,17,18,19 22,23,24,25,26 28,29,30,31,32

SPECIAL CODE: NYLF - SPL. CONTACTS LOADING -LEAD FREE VERSION
 CONTACTS LOADED IN a 1,2,3 6,7,8 12,13 16,17,18,19 22,23,24,25,26 28,29,30,31,32
 b 1,2,3 6,7,8 12,13 20 22,23,24,25,26 28,29,30,31,32
 c 1,2,3 6,7,8 12,13 16,17,18,19 22,23,24,25,26 28,29,30,31,32

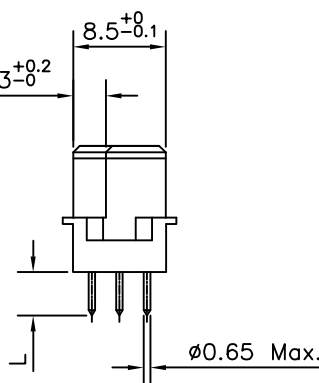

24	2.5
14	4.0
TERM. STYLE	L +0.7 / -0

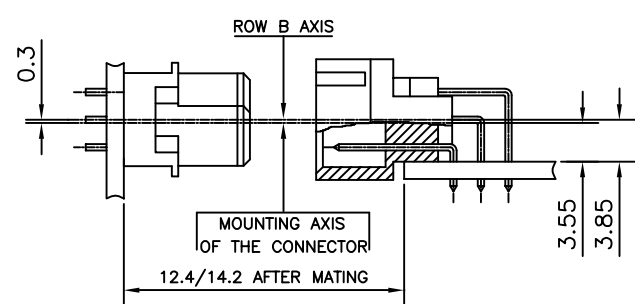
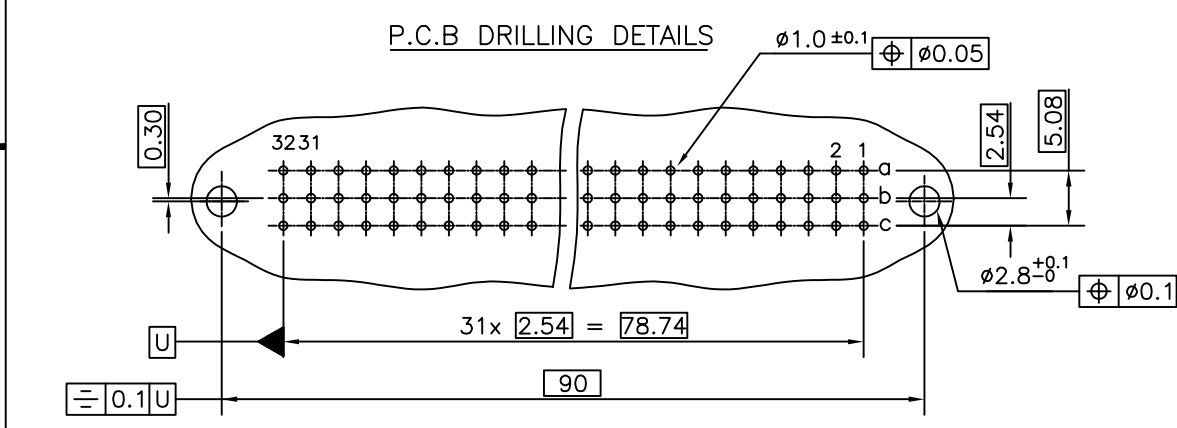
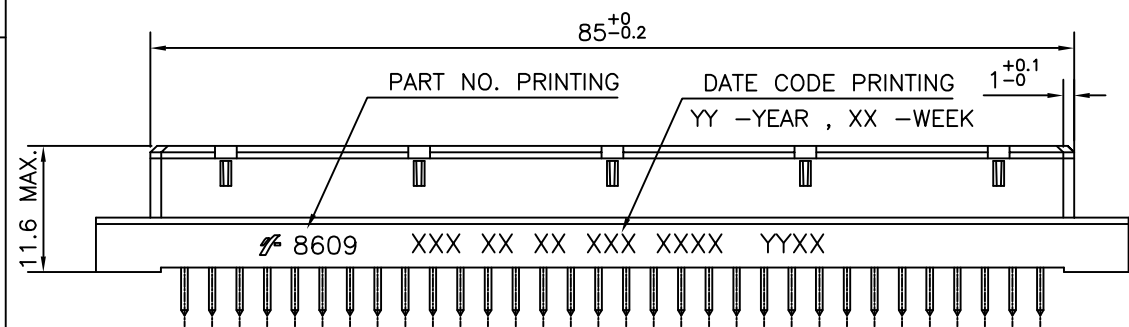
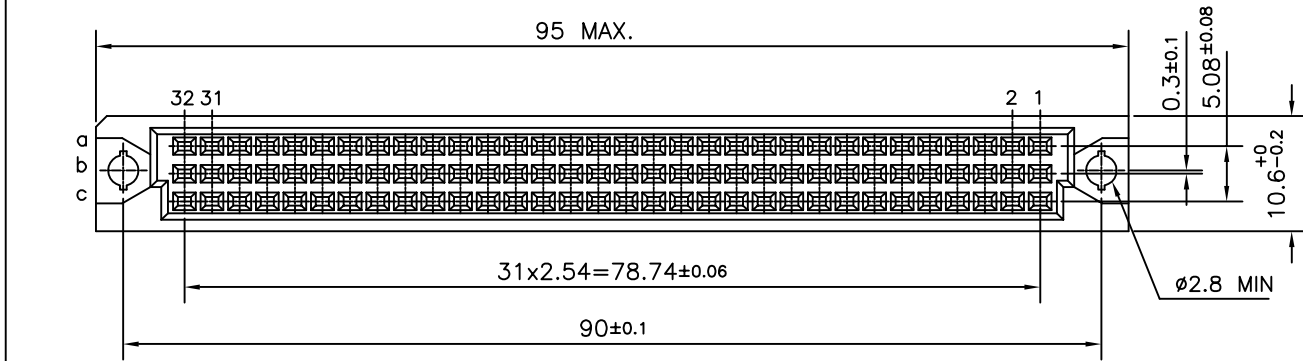

NOTES:-
 1. THE "LF" PRODUCTS MEET EUROPEAN UNION DIRECTIVES AND OTHER COUNTRY REGULATIONS AS DESCRIBED IN GS-22-008
 2. THE HOUSING WILL WITHSTAND EXPOSURE TO 260°C PEAK TEMPERATURE FOR 3.5 SECONDS IN A WAVE SOLDER APPLICATION WITH A 1.6 MM MINIMUM THICK CIRCUIT BOARD
 3. LEAD FREE OR RoHS DIRECTIVE LABELING TO BE PROVIDED AS PER GS-14-920 FOR LEAD FREE VERSION.

mat'l. code	SEE TECH. SPEC.	surface	ISO 1302	tolerance	ISO 406 ISO 1101	projection	product family	8609
ltr	ecn no	dr	date	tolerances unless otherwise specified	angles	linear	title	DIN STANDARD RECEPTACLE
A	I05-0166	MINI	2005-09-22				STRAIGHT SPILL DIN 41612 STYLE-C	
B	I05-0283	MINI	2005-12-31					
C	I06-0064	MINI	2006-06-01					
D	I06-0204	MINI	2006-11-30					
sheet index	revision sheet	D	1				dwg no	sheet 1 of 1 size
							C-8609-2056	A3
							type	Product Customer Drawing

FCIconnect.com
 Copyright FCI