



TAI-SAW TECHNOLOGY CO., LTD.

No. 3, Industrial 2nd Rd., Ping-Chen Industrial District,
Taoyuan, 324, Taiwan, R.O.C.

TEL: 886-3-4690038 FAX: 886-3-4697532

E-mail: tstsales@mail.taisaw.com Web: www.taisaw.com

Approval Sheet For Product Specification

Issued Date:

Product Name: SAW Filter 942.5MHz

TST Parts No.:TA0179A

Customer Parts No.:_____

Company: _____
Division: _____
Approved by : _____
Date: _____

Checked by: _____ Elvis Chiu

Approval by: _____ Francis Chen

Date: _____ 2003/1/13



TAI-SAW TECHNOLOGY CO., LTD.

No. 3, Industrial 2nd Rd., Ping-Chen Industrial District,
Taoyuan, 324, Taiwan, R.O.C.

TEL: 886-3-4690038 FAX: 886-3-4697532

E-mail: tstsales@mail.taisaw.com Web: www.taisaw.com

SAW Filter 942.5 MHz

MODEL NO.: TA0179A

REV. NO.:2

A. MAXIMUM RATING:

1. Input Power Level: 15 dB_m
2. DC voltage: 0 V
3. Operating Temperature: -30°C to +80°C
4. Storage Temperature: -40°C to +85°C

RoHS Compliant
Lead free
Lead-free soldering

B. ELECTRICAL CHARACTERISTICS:

Characteristics			Specification			Note
			Min.	Typ.	Max	
Center frequency	F_c	MHz	-	942.5	-	-
Insertion loss	925~960 MHz	I.L. dB	-	3.0	4.0	-
Ripple	925~960 MHz	dB	-	1.3	2.3	-
V.S.W.R	925~960 MHz		-	2.0	2.6	-
Attenuation: (Reference level from 0 dB)						
	0 ~ 750 MHz	dB	50	60	-	-
	750 ~ 880 MHz	dB	43	50	-	-
	880 ~ 905 MHz	dB	31	42	-	-
	980 ~ 1005 MHz	dB	21	28	-	-
	1005 ~ 1025 MHz	dB	28	33	-	-
	1025 ~ 1035 MHz	dB	35	49	-	-
	1035 ~ 1760 MHz	dB	40	50	-	-
	1760 ~ 3000 MHz	dB	25	31	-	-
Impedance at F_c	Input	$Z_{IN}=R_{IN}/C_{IN}$	50Ω // 0 PF			1
	Output	$Z_{OUT}=R_{OUT}/C_{OUT}$	50Ω // 0 PF			1

Note1. No matching network required for operation at 50 Ω

C. Transfer Function :

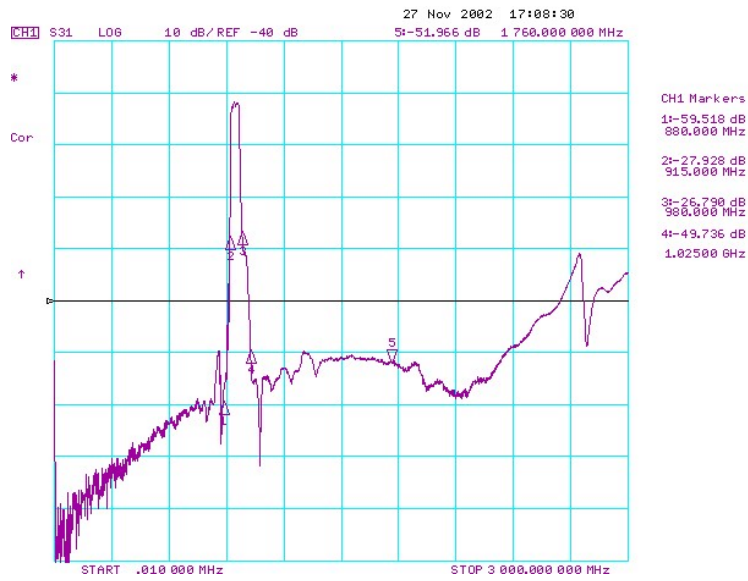
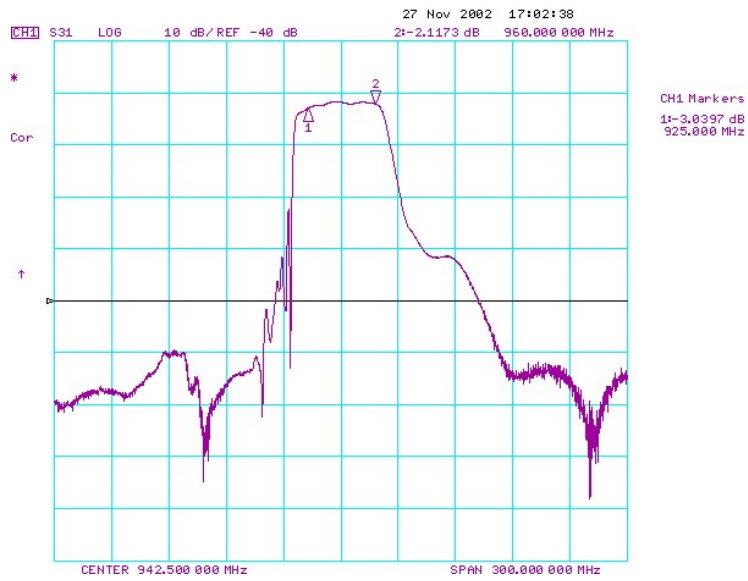

D. Reflections Functions :

S11

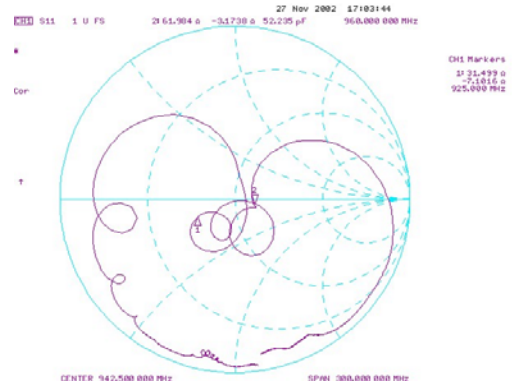
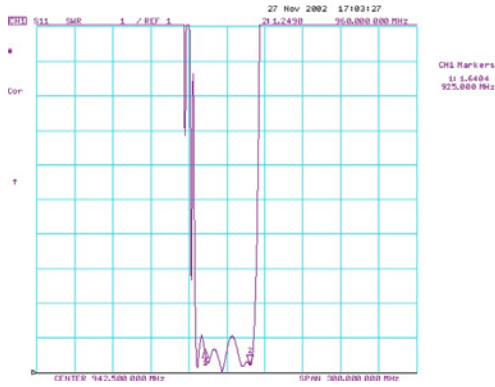

S22

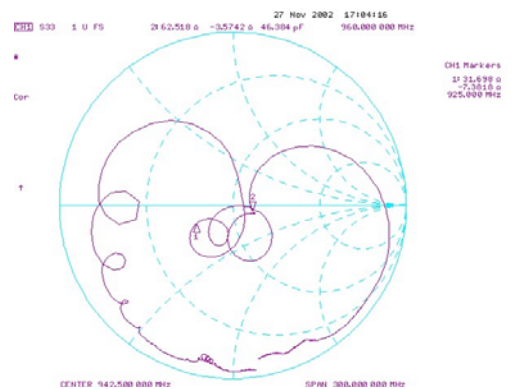
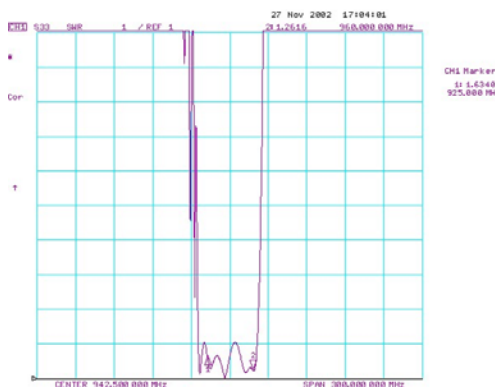

E. MEASUREMENT CIRCUIT:

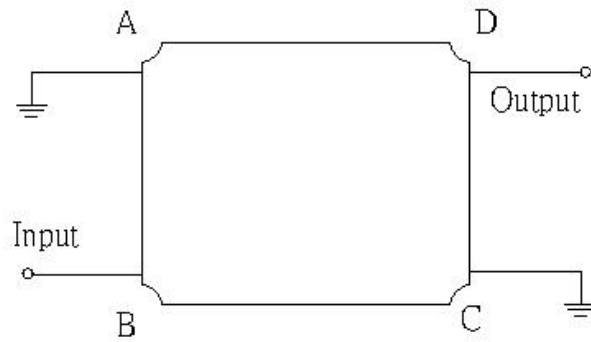

F. OUTLINE DRAWING:

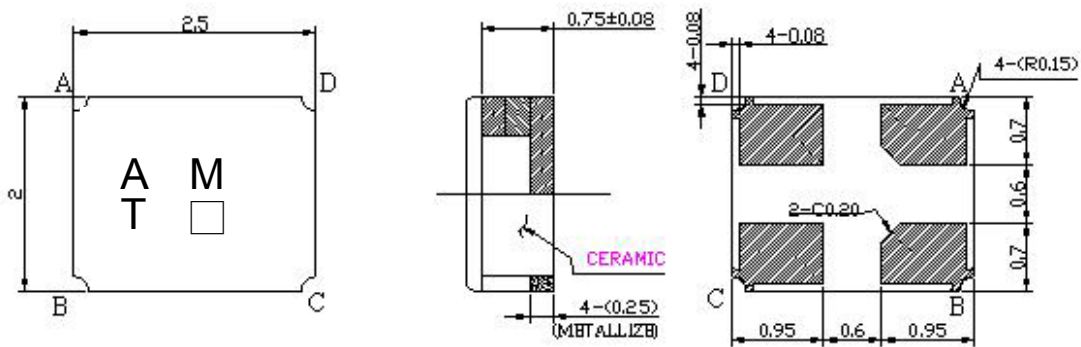

- B : Input
- D : Output
- A, C : Ground
- : Date Code
- Unit : mm

G. PACKING:

1. REEL DIMENSION

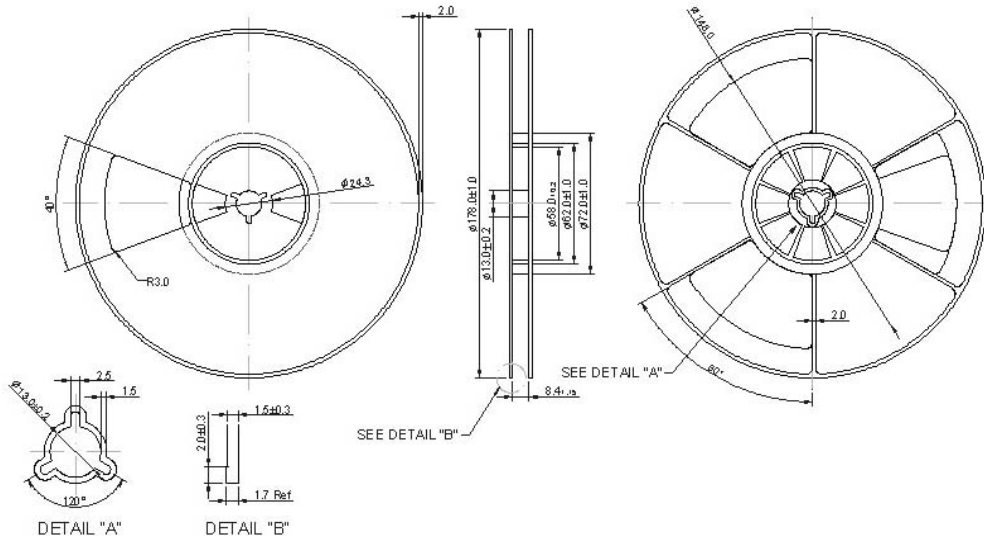

2. TAPE DIMENSION

