

液晶之友 电话: 020-88819057  
 Http://www.redfriends.com

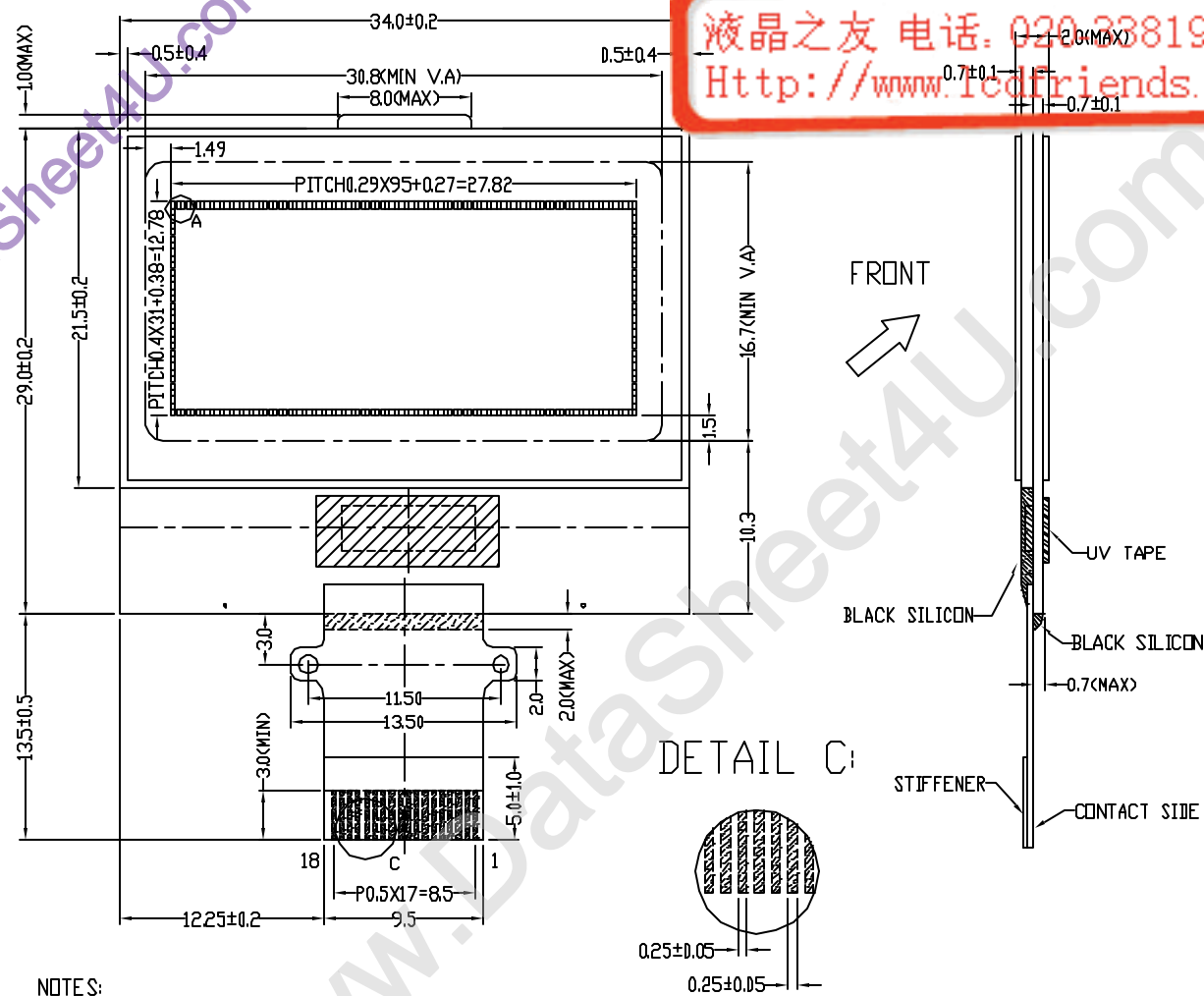

DETAIL A:

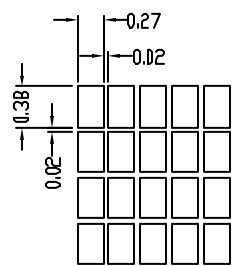

NO.	SYMBOL	NO.	SYMBOL
1	RESETB	10	C1-
2	CS2	11	C2+
3	RS	12	C2-
4	VDD	13	VR
5	SCLK	14	V0
6	SID	15	V1
7	VSS	16	V2
8	VDOUT	17	V3
9	C1+	18	V4

DETAIL C:

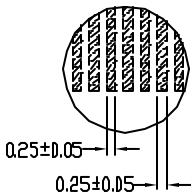

DETAIL B:

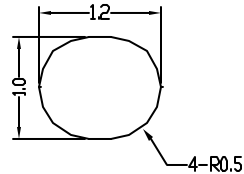

- NOTES:
1. DISPLAY TYPE: STN or FSTN
  2. VIEWING DIRECTION: 6:00 or 12:00
  3. POLARIZER MODE: REFLECTIVE or TRANSFLECTIVE
  4. DRIVE METHOD: 1/33 DUTY 1/6 BIAS
  5. LCD OPERATING VOLTAGE: 7.5V
  6. VDD=2.4~5.5V
  7. OPERATING TEMP.: NORMAL or WIDE
  8. STORAGE TEMP.: NORMAL or WIDE
  9. CONNECTOR: FPC
  10. CONTROLLER: S6B0715A11-B0CZ
  11. WITHOUT BACKLIGHT
  12. UNMARKED TOLERANCES: ±0.3mm

**TIAN-MA MICROELECTRONICS CO.**  
 6/F., CASTIC Building, Shennan Road, Central, Shenzhen, China

DRAWN BY:	TITLE: TM9632E series	
CHECKED BY:	DWG NO: G-2	
APPROVED BY:	DWG NAME: TM9632E C1G0-2	UNIT: mm
CONFIRMED BY:	SHEET NO: 01	