

ITEM	Q'TY	PART NUMBER	PART DESCRIPTION
1	1	PML3-1	Bushing, FLeXible Light Pipe Adapter
2	1	PML3-2	Body, Flexible Light Pipe Adapter
3	1	3IR-940	T-1 (3mm) Infrared LED
4	1	LC-IR-XX.X	IR Lens Cap / FLPC-XX.X Assembly. (XX.X, Cut Length in Inches)

REV.	DESCRIPTION	DATE	APPROVED
A	Engineering Release.	05/20/09	T. Y.

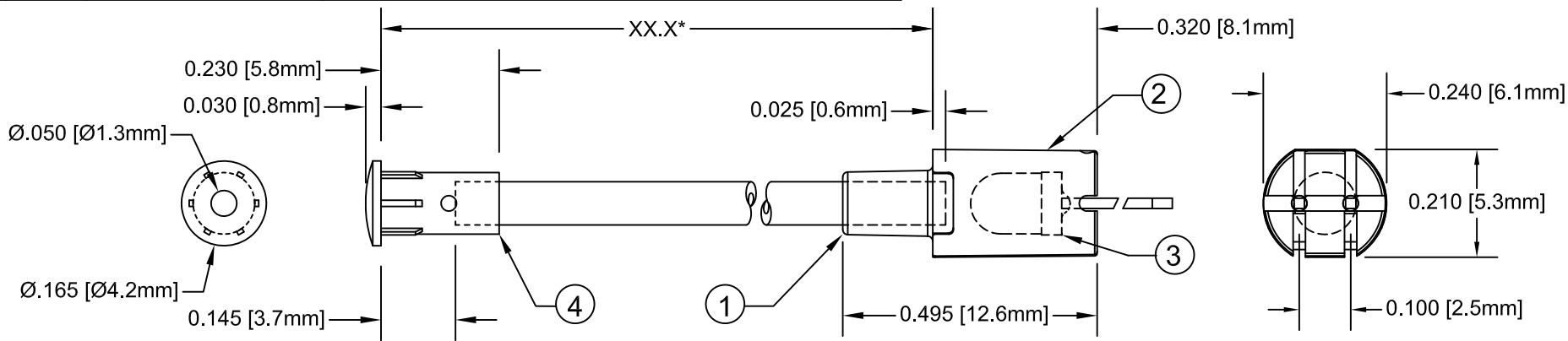

ITEMS 1, 2, & 3 ASSEMBLED AND SHIPPED SEPARATELY

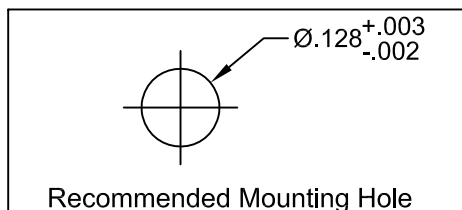

Recommended Mounting Hole

" XX.X "	Tolerance
2.5" ~ 16.0"	±0.050"
16.1" ~ 40.0"	±0.15"
40.1" ~ 80.0"	±0.30"
80.1" ~ 3,940.0"	±0.5%

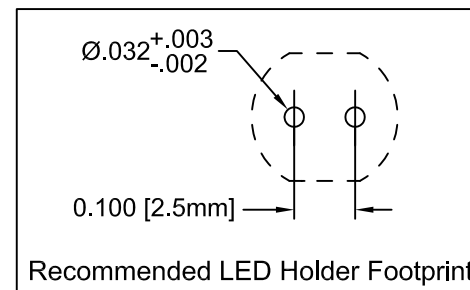

Recommended LED Holder Footprint

LED OPTICAL / ELECTRICAL CHARACTERISTICS					
Parameter	Test Condition	Minimum	Typical	Maximum	Units
Radiant Intensity	I _f = 50mA	11.78	33.4	-	mW/sr
Forward Voltage	I _f = 50mA	-	1.25	1.5	V
Peak Wavelength	I _f = 20mA	-	940	-	nm
Spectral Line-Half Width	I _f = 20mA	-	50	-	nm
Viewing Angle	I _f = 20mA	-	50	-	deg

* Lens Appearance: Blue Transparent

LED ABSOLUTE MAXIMUM RATINGS		
Parameter	Maximum Rating	Unit
Power Dissipation	100	mW
Continuous Forward Current	100	mA
Peak Forward Current	1.0	A
Reverse Voltage	5	V
Reverse Current	10	µA

ABSOLUTE TEMPERATURE RATINGS (Ta=25°C)

OPERATING TEMPERATURE RANGE _____ -25°C - 85°C

STORAGE TEMPERATURE _____ -30°C - 100°C

LEAD SOLDERING TEMPERATURE(1/16" FROM BODY) _____ 260°C FOR 5 SECONDS

STANDARD TOLERANCE (UNLESS OTHERWISE SPECIFIED)	
DECIMALS	ANGULAR
.X ±.1	X° ± 1°
.XX ±.02	
.XXX ±.010	



DESIGNED: Raffy Paje	DATE: 05/20/09
CHECKED: F. Jensen	DATE: 05/20/09

BIVAR®

4 THOMAS, IRVINE, CA. 92618
TEL: (949) 951-8808 FAX: (949) 951-3974

TITLE: FLEXIBLE LIGHT-PIPE LED ADAPTER ASSY, IR	PART NO: FLPIRVXX.XIR940	REVISION: A
CAGE CODE : 32559	SHEET # 1 OF 1	
CAD GENERATED DOCUMENT, DO NOT MEASURE DRAWING.		