

KMD-8S-S

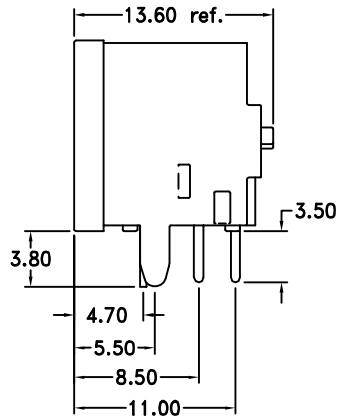

Materials and Finish

Body: PBT thermoplastic,
UL 94V-0 rated, black color

Shield: SPCC, tin plated,
with nickel underplating

Ground Terminal: brass, tin plated,
with nickel underplating

Contacts: brass, tin plated,
with nickel underplating

Electrical Characteristics

Contact Resistance: 50milliohm max.

Insulation Resistance: 100megohm min.
at 500V DC

Withstanding Voltage: 500V AC rms
for 1 minute

Contact Current Rating:
12V DC at 5A Max.

or
20V DC at 2A max

Operating Temperature:
-25°C to +100°C

Mechanical Characteristics

Insertion Force:
0.5kg - 5.0kg

Extraction Force:
0.4kg - 5.0kg

Durability: 5000 mating cycles min.
with test plug

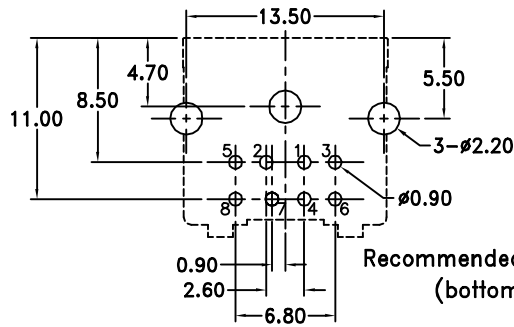
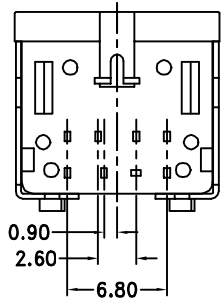

Recommended PCB Layout
(bottom view)

| KMD-3S-S | KMD-4S-S | KMD-5S-S | KMD-6S-S | KMD-7S-S |
|----------|----------|----------|----------|----------|
| | | | | |
| | | | | |

Recommended PCB Layouts (for KMD-8S-S, 8 position, see above) bottom view

CSA US/C Certified File No. LR78160

| REVISION | DATE | DESCRIPTION | DRAWN BY | DESIGNED BY | UNITS |
|----------|--------|-----------------|------------|-------------|----------|
| A1 | 1/4/01 | ref. ECD 01-002 | C. Leiva | | mm |
| | | | CHECKED BY | APPROVED BY | DATE |
| | | | | | 12/14/00 |

KMD-xS-S
x = No. of Contacts

Right Angle PCB Mount Mini-Din
3-8 position, 3 side shielded

