

PLEASE CHECK WWW.MOLEX.COM FOR LATEST PART INFORMATION

Part Number: [5023781310](#)
Status: **Active**
Description: 2.54mm (.100") Pitch Easy-On™ Type FPC Connector, Right Angle, Through Hole, Top Contact Style, 13 Circuits

Documents:

[3D Model](#) [Product Specification PS-502378-001 \(PDF\)](#)
[Drawing \(PDF\)](#) [RoHS Certificate of Compliance \(PDF\)](#)

General

Product Family FFC/FPC Connectors
 Series [502378](#)
 Product Name Easy-On™

Physical

Circuits (Loaded) 13
 Contact Position Top
 Durability (mating cycles max) 20
 Entry Angle 90° Angle
 Mated Height (in) 0.268 In
 Mated Height (mm) 6.80 mm
 Material - Metal Phosphor Bronze
 Material - Plating Mating Gold
 Material - Plating Termination Tin
 Number of Rows 1
 Orientation Right Angle
 PC Tail Length (in) 0.122 In
 PC Tail Length (mm) 3.10 mm
 PCB Locator Yes
 PCB Retention Yes
 Packaging Type Tray
 Pitch - Mating Interface (in) 0.100 In
 Pitch - Mating Interface (mm) 2.54 mm
 Polarized to PCB Yes
 Stackable No
 Temperature Range - Operating -40°C to +85°C
 Termination Interface: Style Through Hole
 Wire/Cable Type FPC only

Electrical

Current - Maximum per Contact 1A
 Voltage - Maximum 125V

Material Info

Reference - Drawing Numbers

Product Specification PS-502378-001, RPS-502378-001, RPS-502378-002, RPS-502378-003
 Sales Drawing SD-502378-001

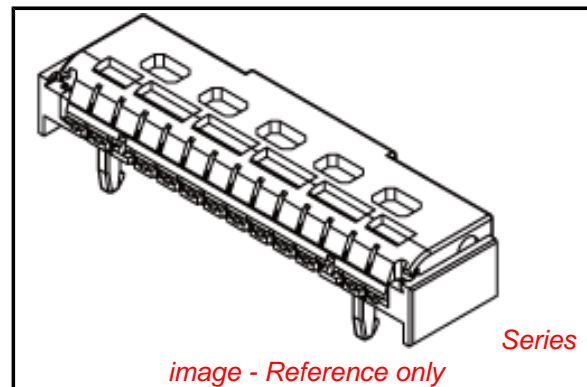

EU RoHS

ELV and RoHS Compliant
REACH SVHC Contains SVHC: No
Halogen-Free Status
Not Reviewed

China RoHS



Need more information on product environmental compliance?

Email productcompliance@molex.com
 For a multiple part number RoHS Certificate of Compliance, [click here](#)

Please visit the [Contact Us](#) section for any non-product compliance questions.

Search Parts in this Series
[502378Series](#)

10 9 8 7 6 5 4 3 2 1

F

E

D

C

B

A

F

E

D

C

B

A

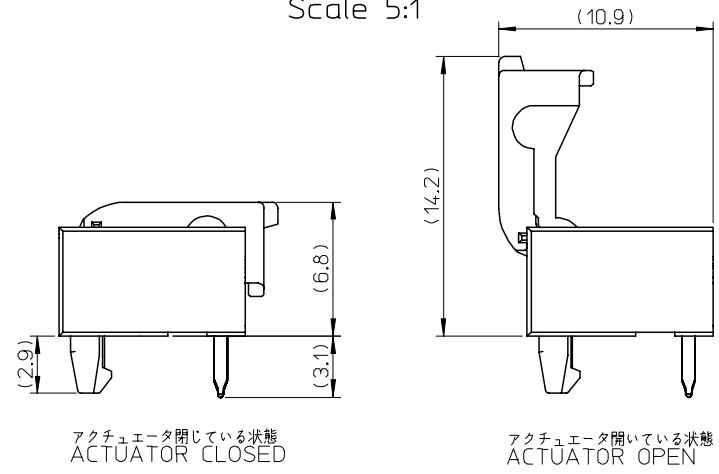
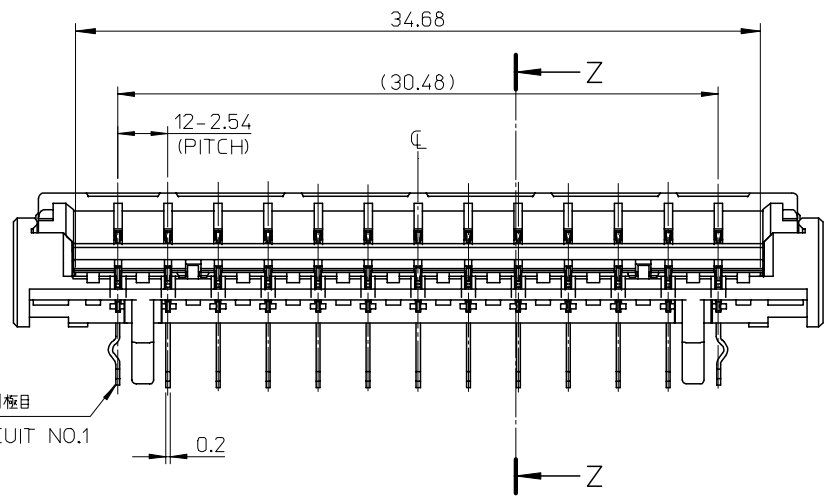
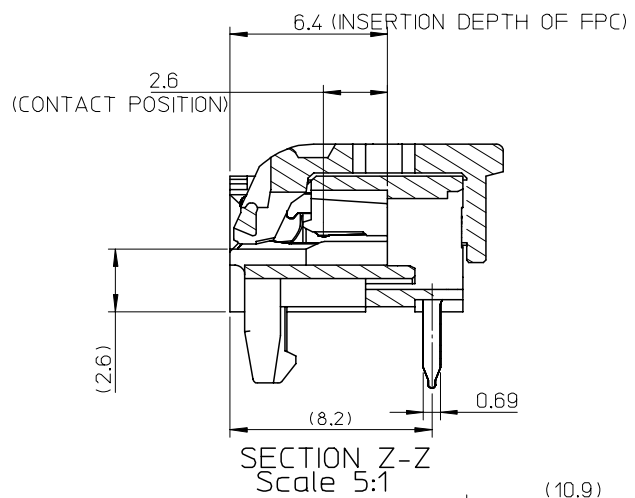
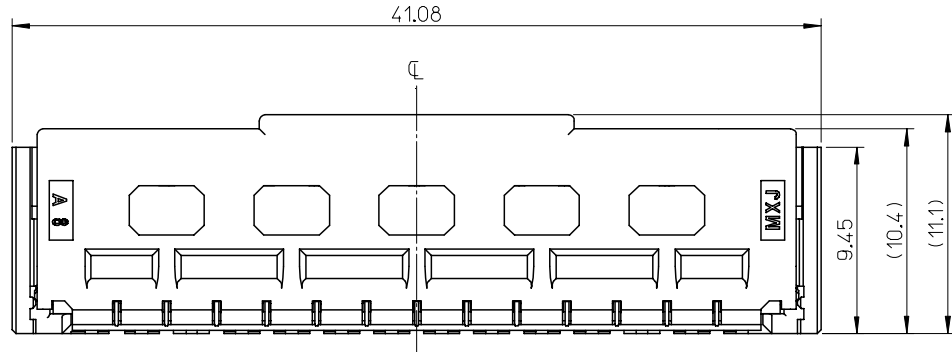

RELEASED EC NO: J2007-3187 DRWN:KONURAKAMI 2007/05/23 CHKD:K.TAKAHASHI 2007/05/23 APPR:K.TAKAHASHI 2007/05/24	GENERAL TOLERANCES (UNLESS SPECIFIED)		DIMENSION STYLE MM ONLY		SCALE 4:1	DESIGN UNITS METRIC	THIRD ANGLE PROJECTION	
	10 UNDER	±0.2	DRAWN BY K.MURAKAMI	DATE 2007/05/22	TITLE 2.54MM FPC CONN EO BACK FLIP HSG ASS'Y			
	10 OVER 30 UNDER	±0.2	CHECKED BY K.TAKAHASHI	DATE 2007/05/22				
	30 OVER	±0.2	APPROVED BY H.HIRATA	DATE 2007/05/22	MOLEX INCORPORATED			
	ANGULAR	±1 °	MATERIAL NO. 502378-1310	DOCUMENT NO. SD-502378-001				
DRAFT WHERE APPLICABLE MUST REMAIN WITHIN DIMENSIONS		SIZE A3	THIS DRAWING CONTAINS INFORMATION THAT IS PROPRIETARY TO MOLEX INCORPORATED AND SHOULD NOT BE USED WITHOUT WRITTEN PERMISSION					

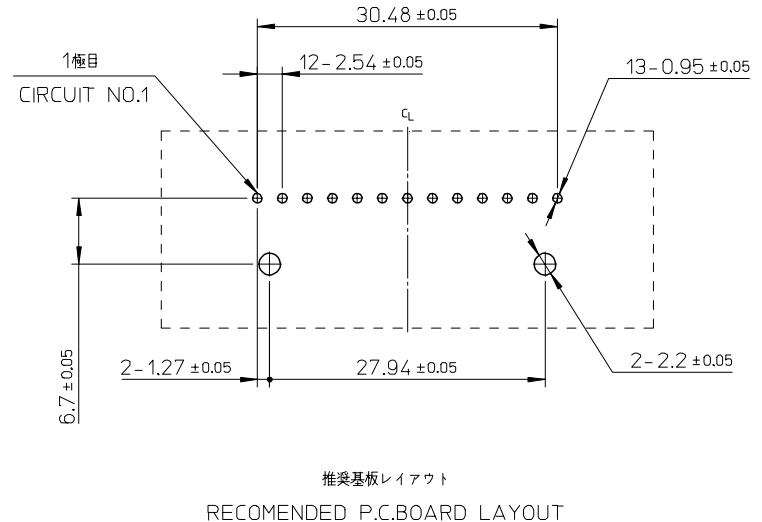
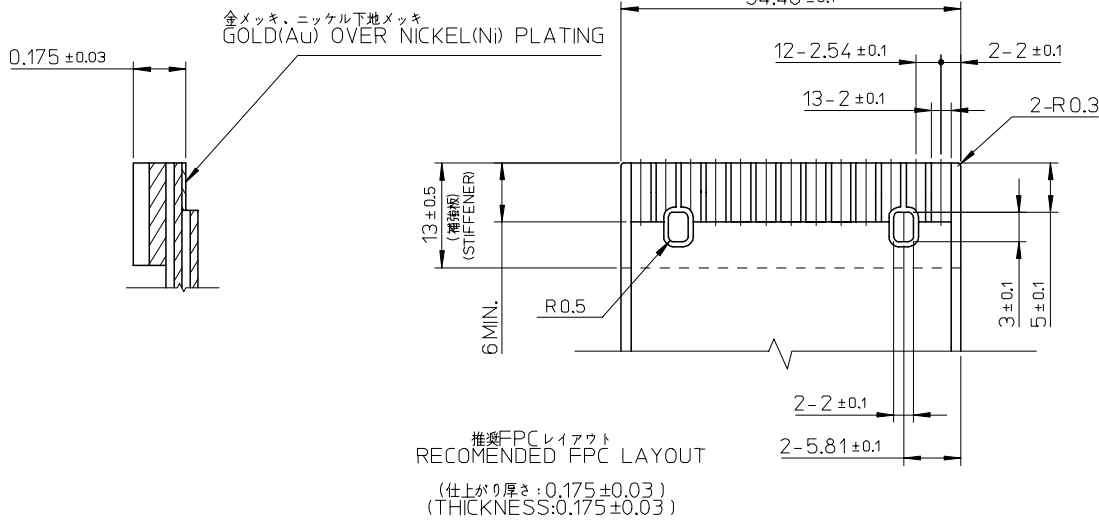

注記 NOTES

1. 使用材料 MATERIAL
 ハウジング: 46ナイロン UL94 V-0
 HOUSING: PA46 UL94 V-0
 アクチュエータ: 46ナイロン UL94 V-0
 ACTUATOR: PA46 UL94 V-0
 ターミナル: リン青銅
 TERMINAL: PHOSPHOR BRONZE
2. メッキ仕様 PLATING
 コンタクト部: 金メッキ(0.1マイクロメートル以上 封孔処理)
 CONTACT AREA: GOLD PLATING
 (0.1 MICROMETER MIN. FOR SEALING DEPOSITION)
 半田付け部: 錫メッキ
 SOLDERING AREA: TIN PLATING
 下地: ニッケルメッキ
 UNDER PLATING: NICKEL PLATING
3. ELV及びRoHS適合品
 ELV AND RoHS COMPLIANT.

FPCについて:
 打抜き方向は導体側から補強板側を推奨致します。
 導体部については軟銅箔35マイクロメートルまたは50マイクロメートルを推奨致します。
 ABOUT FPC
 RECOMMENDED PUNCHER DIRECTION: FROM CONDUCTOR SIDE TO STIFFENER FILM SIDE.
 RECOMMENDED CONDUCTOR SPEC:
 THICKNESS OF SOFT COPPER FOIL: 35 MICROMETER OR 50 MICROMETER
 補強フィルム材質はポリイミドを推奨致します。
 接着剤は熱硬化接着剤を推奨致します。
 ベースフィルムは25マイクロメートルを推奨致します。
 RECOMMENDED MATERIAL:
 STIFFENER FILM: POLYIMIDE
 BONDING AGENT: THERMOSETTING BONDING AGENT
 RECOMMENDED THICKNESS:
 BASE FILM: 25 MICROMETER

RELEASED EC NO: J2007-3187 DRW: K. MURAKAMI 2007/05/23 CHK: K. TAKAHASHI 2007/05/23 APPR: K. TAKAHASHI 2007/05/24	GENERAL TOLERANCES (UNLESS SPECIFIED)		DIMENSION STYLE MM ONLY		SCALE 2:1	DESIGN UNITS METRIC	THIRD ANGLE PROJECTION	
	10 UNDER	± 0.2	DRAWN BY K. MURAKAMI		DATE 2007/05/22		TITLE 2.54MM FPC CONN EO BACK FLIP HSG ASS'Y	
	10 OVER 30 UNDER	± 0.2	CHECKED BY K. TAKAHASHI		DATE 2007/05/22			
	30 OVER	± 0.2	APPROVED BY H. HIRATA		DATE 2007/05/22		MOLEX INCORPORATED	
ANGULAR	± 1	MATERIAL NO. 502378-1310		DOCUMENT NO. SD-502378-001		SHEET NO. 2 OF 2		
DRAFT WHERE APPLICABLE MUST REMAIN WITHIN DIMENSIONS			SIZE A3	THIS DRAWING CONTAINS INFORMATION THAT IS PROPRIETARY TO MOLEX INCORPORATED AND SHOULD NOT BE USED WITHOUT WRITTEN PERMISSION				