

**PLEASE CHECK WWW.MOLEX.COM FOR LATEST PART INFORMATION**

**Part Number:** [0901200766](#)  
**Status:** **Active**  
**Overview:** [cgrid\\_iii](#)  
**Description:** 2.54mm (.100") Pitch C-Grid III™ Header, Single Row, Vertical, 6 Circuits, 0.38μm (15μ") Gold (Au) Selective Plating

**Documents:**

[3D Model](#) [RoHS Certificate of Compliance \(PDF\)](#)  
[Drawing \(PDF\)](#)

**General**

|                |                           |
|----------------|---------------------------|
| Product Family | PCB Headers               |
| Series         | <a href="#">90120</a>     |
| Application    | Wire-to-Board             |
| Overview       | <a href="#">cgrid_iii</a> |
| Product Name   | C-Grid III™               |

**Physical**

|                                |                 |
|--------------------------------|-----------------|
| Breakaway                      | Yes             |
| Circuits (Loaded)              | 6               |
| Circuits (maximum)             | 6               |
| Color - Resin                  | Black           |
| First Mate / Last Break        | No              |
| Glow-Wire Compliant            | No              |
| Guide to Mating Part           | No              |
| Keying to Mating Part          | None            |
| Lock to Mating Part            | None            |
| Material - Metal               | Brass           |
| Material - Plating Mating      | Gold            |
| Material - Plating Termination | Tin             |
| Material - Resin               | Polyester       |
| Number of Rows                 | 1               |
| Orientation                    | Vertical        |
| PC Tail Length (in)            | 0.114 In        |
| PC Tail Length (mm)            | 2.90 mm         |
| PCB Locator                    | No              |
| PCB Retention                  | None            |
| Packaging Type                 | Bag             |
| Pitch - Mating Interface (in)  | 0.100 In        |
| Pitch - Mating Interface (mm)  | 2.54 mm         |
| Plating min: Mating (μin)      | 15              |
| Plating min: Mating (μm)       | 0.38            |
| Polarized to Mating Part       | No              |
| Polarized to PCB               | No              |
| Shrouded                       | No              |
| Stackable                      | No              |
| Temperature Range - Operating  | -55°C to +125°C |
| Termination Interface: Style   | Through Hole    |

**Electrical**

|                               |      |
|-------------------------------|------|
| Current - Maximum per Contact | 3A   |
| Voltage - Maximum             | 350V |

**Solder Process Data**

|  |                        |
|--|------------------------|
| Duration at Max. Process Temperature (seconds) | 5                      |
| Lead-free Process Capability                   | Wave Capable (TH only) |

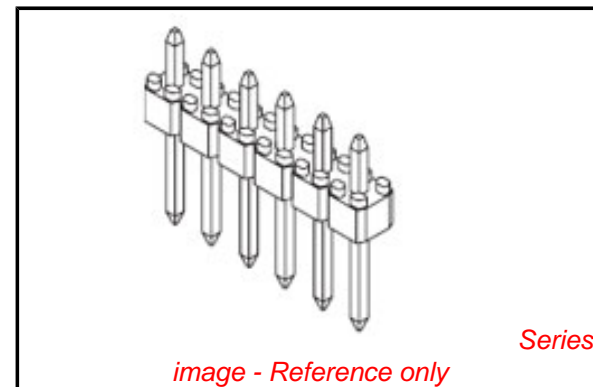

**EU RoHS**

**ELV and RoHS Compliant**  
**REACH SVHC Contains SVHC: No**  
**Halogen-Free Status**

**China RoHS**



**Need more information on product environmental compliance?**

Email [productcompliance@molex.com](mailto:productcompliance@molex.com)  
 For a multiple part number RoHS Certificate of Compliance, [click here](#)

Please visit the [Contact Us](#) section for any non-product compliance questions.

**Search Parts in this Series**

[90120Series](#)

**Mates With**

[90147 C-Grid® PC Board Connector](#). [90123 C-Grid III™ Modular Crimp Housing](#)

|   |     |
|---|-----|
| Max. Cycles at Max. Process Temperature | 1   |
| Process Temperature max. C              | 230 |

**Material Info**

**Reference - Drawing Numbers**

|               |           |
|---------------|-----------|
| Sales Drawing | SDA-90120 |
|---------------|-----------|

This document was generated on 05/26/2010

**PLEASE CHECK [WWW.MOLEX.COM](http://WWW.MOLEX.COM) FOR LATEST PART INFORMATION**

10 9 8 7 6 5 4 3 2 1

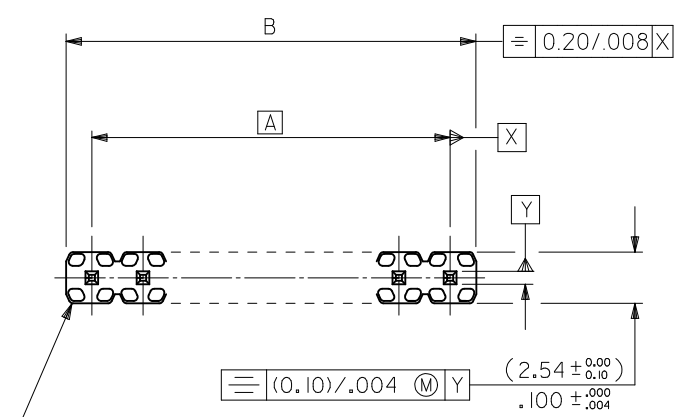

WAFER: 15% GLASS FILLED POLYESTER  
TO UL 94V-0.  
COLOUR: BLACK.

| CKT SIZE | DIM. "A" |       | DIM. "B" <sup>(+0.45)</sup> <sub>(-0.18)</sub> |       | CKT SIZE | DIM. "A" |       | DIM. "B" <sup>(+0.45)</sup> <sub>(-0.18)</sub> |       |
|----------|----------|-------|--|-------|----------|----------|-------|--|-------|
| 1X 1     |          |       | (2.54)   | .100  | 1X21     | (50.80)  | 2.000 | (53.34)  | 2.100 |
| 1X 2     | (2.54)   | .100  | (5.08)   | .200  | 1X22     | (53.34)  | 2.100 | (55.88)  | 2.200 |
| 1X 3     | (5.08)   | .200  | (7.62)   | .300  | 1X23     | (55.88)  | 2.200 | (58.42)  | 2.300 |
| 1X 4     | (7.62)   | .300  | (10.16)  | .400  | 1X24     | (58.42)  | 2.300 | (60.96)  | 2.400 |
| 1X 5     | (10.16)  | .400  | (12.70)  | .500  | 1X25     | (60.96)  | 2.400 | (63.50)  | 2.500 |
| 1X 6     | (12.70)  | .500  | (15.24)  | .600  | 1X26     | (63.50)  | 2.500 | (66.04)  | 2.600 |
| 1X 7     | (15.24)  | .600  | (17.78)  | .700  | 1X27     | (66.04)  | 2.600 | (68.58)  | 2.700 |
| 1X 8     | (17.78)  | .700  | (20.32)  | .800  | 1X28     | (68.58)  | 2.700 | (71.12)  | 2.800 |
| 1X 9     | (20.32)  | .800  | (22.86)  | .900  | 1X29     | (71.12)  | 2.800 | (73.66)  | 2.900 |
| 1X 10    | (22.86)  | .900  | (25.40)  | 1.000 | 1X30     | (73.66)  | 2.900 | (76.20)  | 3.000 |
| 1X 11    | (25.40)  | 1.000 | (27.94)  | 1.100 | 1X31     | (76.20)  | 3.000 | (78.74)  | 3.100 |
| 1X 12    | (27.94)  | 1.100 | (30.48)  | 1.200 | 1X32     | (78.74)  | 3.100 | (81.28)  | 3.200 |
| 1X 13    | (30.48)  | 1.200 | (33.02)  | 1.300 | 1X33     | (81.28)  | 3.200 | (83.82)  | 3.300 |
| 1X 14    | (33.02)  | 1.300 | (35.56)  | 1.400 | 1X34     | (83.82)  | 3.300 | (86.36)  | 3.400 |
| 1X 15    | (35.56)  | 1.400 | (38.10)  | 1.500 | 1X35     | (86.36)  | 3.400 | (88.90)  | 3.500 |
| 1X 16    | (38.10)  | 1.500 | (40.64)  | 1.600 | 1X36     | (88.90)  | 3.500 | (91.44)  | 3.600 |
| 1X 17    | (40.64)  | 1.600 | (43.18)  | 1.700 | 1X37     | (91.44)  | 3.600 | (93.98)  | 3.700 |
| 1X 18    | (43.18)  | 1.700 | (45.72)  | 1.800 | 1X38     | (93.98)  | 3.700 | (96.52)  | 3.800 |
| 1X 19    | (45.72)  | 1.800 | (48.26)  | 1.900 | 1X39     | (96.52)  | 3.800 | (99.06)  | 3.900 |
| 1X 20    | (48.26)  | 1.900 | (50.80)  | 2.000 | 1X40     | (99.06)  | 3.900 | (101.60)                                       | 4.000 |

NOTES

- FOR ASSY NUMBERS WITH FINISH OPTIONS AND DIM'S C & D SEE SHEETS 2 TO 6.
- PRODUCT SPEC: PS-99020-0001
- RECOMMENDED PCB THICKNESS 1.6mm

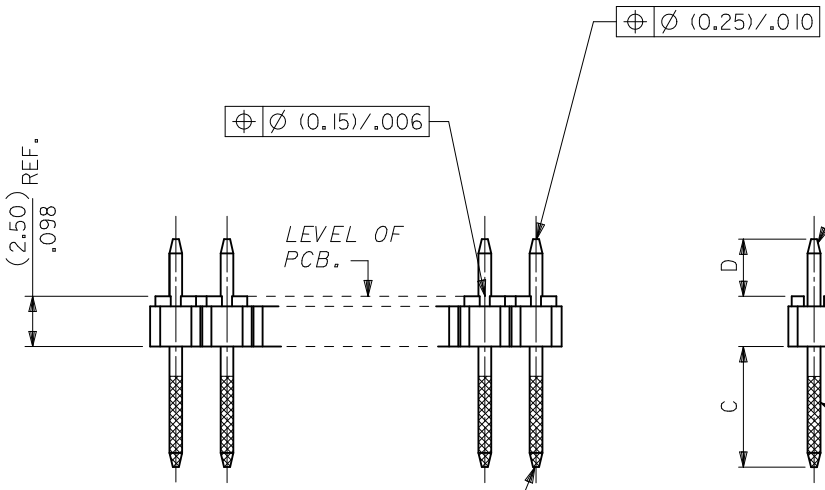

PINS: (0.635)/.025 SQ. BRASS WIRE.  
PLATED AS PER SHEETS 2 TO 6.

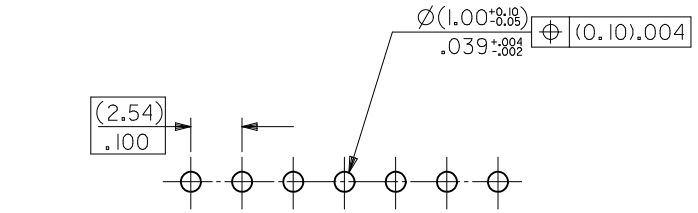
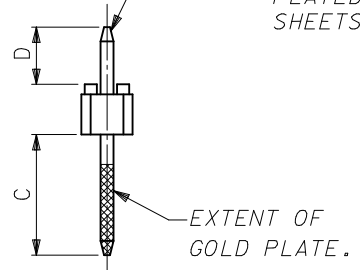

$(2.54) \text{ } .100$

|   |  |                                       |              |                 |            |                    |   |                        |  |
|---|--|---------------------------------------|--------------|-----------------|------------|--------------------|---|------------------------|--|
| <b>REV GD&amp;T FOR DIM B</b><br>EC NO: S2010-0493<br>DRWN:SKANG 2009/12/11<br>CHKD:ATSEE 2009/12/21<br>APPR:MLONG 2009/12/21 | QUALITY SYMBOLS                                      | GENERAL TOLERANCES (UNLESS SPECIFIED) |              | DIMENSION STYLE |            | SCALE              | DESIGN UNITS  | THIRD ANGLE PROJECTION |  |
|   | $\nabla_A = 0$                                       | mm                                    | INCH         | MM/IN           |            | NTS                | METRIC  |                        |  |
|   | $\nabla_C = 0$                                       | 4 PLACES                              | ± ---        | ± ---           | DRAWN BY   | DATE               | TITLE   |                        |  |
|   | $\nabla_B = 0$                                       | 3 PLACES                              | ± ---        | ± ---           | JDENNEHY   | 2006/01/18         | C-GRID III<br>SINGLE ROW STRAIGHT<br>PIN HEADER   |                        |  |
|   | 2 PLACES   | ± ---                                 | ± ---        | CHECKED BY      | DATE       | MOLEX INCORPORATED |   |                        |  |
|   | 1 PLACE  | ± ---                                 | ± ---        | DWASZKIEWICZ    | 2006/01/18 | SDA-90120          |   |                        |  |
|   | ANGULAR ± ---°                                       |                                       | APPROVED BY  |                 | DATE       | SHEET NO.          |   |                        |  |
|   | DRAFT WHERE APPLICABLE MUST REMAIN WITHIN DIMENSIONS |                                       | MLONG        |                 | 2009/12/21 | 1 OF 6             |   |                        |  |
|   |  |                                       | MATERIAL NO. |                 | SEE TABLE  |                    | THIS DRAWING CONTAINS INFORMATION THAT IS PROPRIETARY TO MOLEX INCORPORATED AND SHOULD NOT BE USED WITHOUT WRITTEN PERMISSION |                        |  |
|   |  |                                       | SIZE         |                 | A3         |                    |   |                        |  |

9 8 7 6 5 4 3 2 1

| CIRCUIT SIZE | PLATING TYPE A |                            | PLATING TYPE E |                            | PLATING TYPE F |                            |
|--------------|----------------|----------------------------|----------------|----------------------------|----------------|----------------------------|
|              | PART NO.       | CUSTOMER SPECIFIC PART NO. | PART NO.       | CUSTOMER SPECIFIC PART NO. | PART NO.       | CUSTOMER SPECIFIC PART NO. |
| 1 X 1        | 90120-0121     | 90120-9121                 | 90120-0761     | 90120-9761                 | 90120-0921     | 90120-9921                 |
| 1 X 2        | ↑ -0122        | ↑ -9122                    | ↑ -0762        | ↑ -9762                    | ↑ -0922        | ↑ -9922                    |
| 1 X 3        | -0123          | -9123                      | -0763          | -9763                      | -0923          | -9923                      |
| 1 X 4        | -0124          | -9124                      | -0764          | -9764                      | -0924          | -9924                      |
| 1 X 5        | -0125          | -9125                      | -0765          | -9765                      | -0925          | -9925                      |
| 1 X 6        | -0126          | -9126                      | -0766          | -9766                      | -0926          | -9926                      |
| 1 X 7        | -0127          | -9127                      | -0767          | -9767                      | -0927          | -9927                      |
| 1 X 8        | -0128          | -9128                      | -0768          | -9768                      | -0928          | -9928                      |
| 1 X 9        | -0129          | -9129                      | -0769          | -9769                      | -0929          | -9929                      |
| 1 X 10       | -0130          | -9130                      | -0770          | -9770                      | -0930          | -9930                      |
| 1 X 11       | -0131          | -9131                      | -0771          | -9771                      | -0931          | -9931                      |
| 1 X 12       | -0132          | -9132                      | -0772          | -9772                      | -0932          | -9932                      |
| 1 X 13       | -0133          | -9133                      | -0773          | -9773                      | -0933          | -9933                      |
| 1 X 14       | -0134          | -9134                      | -0774          | -9774                      | -0934          | -9934                      |
| 1 X 15       | -0135          | -9135                      | -0775          | -9775                      | -0935          | -9935                      |
| 1 X 16       | -0136          | -9136                      | -0776          | -9776                      | -0936          | -9936                      |
| 1 X 17       | -0137          | -9137                      | -0777          | -9777                      | -0937          | -9937                      |
| 1 X 18       | -0138          | -9138                      | -0778          | -9778                      | -0938          | -9938                      |
| 1 X 19       | -0139          | -9139                      | -0779          | -9779                      | -0939          | -9939                      |
| 1 X 20       | -0140          | -9140                      | -0780          | -9780                      | -0940          | -9940                      |
| 1 X 21       | -0141          | -9141                      | -0781          | -9781                      | -0941          | -9941                      |
| 1 X 22       | -0142          | -9142                      | -0782          | -9782                      | -0942          | -9942                      |
| 1 X 23       | -0143          | -9143                      | -0783          | -9783                      | -0943          | -9943                      |
| 1 X 24       | -0144          | -9144                      | -0784          | -9784                      | -0944          | -9944                      |
| 1 X 25       | -0145          | -9145                      | -0785          | -9785                      | -0945          | -9945                      |
| 1 X 26       | -0146          | -9146                      | -0786          | -9786                      | -0946          | -9946                      |
| 1 X 27       | -0147          | -9147                      | -0787          | -9787                      | -0947          | -9947                      |
| 1 X 28       | -0148          | -9148                      | -0788          | -9788                      | -0948          | -9948                      |
| 1 X 29       | -0149          | -9149                      | -0789          | -9789                      | -0949          | -9949                      |
| 1 X 30       | -0150          | -9150                      | -0790          | -9790                      | -0950          | -9950                      |
| 1 X 31       | -0151          | -9151                      | -0791          | -9791                      | -0951          | -9951                      |
| 1 X 32       | -0152          | -9152                      | -0792          | -9792                      | -0952          | -9952                      |
| 1 X 33       | -0153          | -9153                      | -0793          | -9793                      | -0953          | -9953                      |
| 1 X 34       | -0154          | -9154                      | -0794          | -9794                      | -0954          | -9954                      |
| 1 X 35       | -0155          | -9155                      | -0795          | -9795                      | -0955          | -9955                      |
| 1 X 36       | -0156          | -9156                      | -0796          | -9796                      | -0956          | -9956                      |
| 1 X 37       | -0157          | -9157                      | -0797          | -9797                      | -0957          | -9957                      |
| 1 X 38       | -0158          | -9158                      | -0798          | -9798                      | -0958          | -9958                      |
| 1 X 39       | ↓ -0159        | ↓ -9159                    | ↓ -0799        | ↓ -9799                    | ↓ -0959        | ↓ -9959                    |
| 1 X 40       | 90120-0160     | 90120-9160                 | 90120-0800     | 90120-9800                 | 90120-0960     | 90120-9960                 |

DIM C (+0.20 / -0.008) (6.75) .266

DIM D (+0.20 / -0.30) (+.008 / -.012) (2.90) .114

NOTES:  
FOR PLATING VARIATIONS SEE  
ENG.STD. SDES-99000-0003.

**STANDARD PRODUCTS**

REV GD&T FOR DIM B  
EC NO: S2010-0493  
DRWN:SKANG 2009/12/11  
CHKD:ATSEE 2009/12/21  
APPR:MLONG 2009/12/21

QUALITY SYMBOLS  
F<sub>A</sub>=0  
F<sub>E</sub>=0  
F<sub>F</sub>=0

GENERAL TOLERANCES (UNLESS SPECIFIED)  
mm INCH  
4 PLACES ± --- ± ---  
3 PLACES ± --- ± ---  
2 PLACES ± --- ± ---  
1 PLACE ± --- ± ---  
ANGULAR ± ---°  
DRAFT WHERE APPLICABLE  
MUST REMAIN WITHIN DIMENSIONS

DIMENSION STYLE MM/IN  
DRAWN BY JDENNEHY DATE 2006/01/18  
CHECKED BY DWASZKIEWICZ DATE 2006/01/18  
APPROVED BY MLONG DATE 2009/12/21  
MATERIAL NO. SEE TABLE  
SIZE A3

SCALE NTS  
DESIGN UNITS METRIC  
THIRD ANGLE PROJECTION

TITLE  
C-GRID III  
SINGLE ROW STRAIGHT  
PIN HEADER  
MOLEX INCORPORATED  
DOCUMENT NO. SDA-90120  
SHEET NO. 2 OF 6  
THIS DRAWING CONTAINS INFORMATION THAT IS PROPRIETARY TO MOLEX INCORPORATED AND SHOULD NOT BE USED WITHOUT WRITTEN PERMISSION

| CIRCUIT SIZE | PLATING TYPE A PART NO. | PLATING TYPE E PART NO. | PLATING TYPE F PART NO. |
|--------------|-------------------------|-------------------------|-------------------------|
| 1 X 1        | 90120-0041              | 90120-0681              | 90120-0841              |
| 1 X 2        | ▲ -0042                 | ▲ -0682                 | ▲ -0842                 |
| 1 X 3        | -0043                   | -0683                   | -0843                   |
| 1 X 4        | -0044                   | -0684                   | -0844                   |
| 1 X 5        | -0045                   | -0685                   | -0845                   |
| 1 X 6        | -0046                   | -0686                   | -0846                   |
| 1 X 7        | -0047                   | -0687                   | -0847                   |
| 1 X 8        | -0048                   | -0688                   | -0848                   |
| 1 X 9        | -0049                   | -0689                   | -0849                   |
| 1 X 10       | -0050                   | -0690                   | -0850                   |
| 1 X 11       | -0051                   | -0691                   | -0851                   |
| 1 X 12       | -0052                   | -0692                   | -0852                   |
| 1 X 13       | -0053                   | -0693                   | -0853                   |
| 1 X 14       | -0054                   | -0694                   | -0854                   |
| 1 X 15       | -0055                   | -0695                   | -0855                   |
| 1 X 16       | -0056                   | -0696                   | -0856                   |
| 1 X 17       | -0057                   | -0697                   | -0857                   |
| 1 X 18       | -0058                   | -0698                   | -0858                   |
| 1 X 19       | -0059                   | -0699                   | -0859                   |
| 1 X 20       | -0060                   | -0700                   | -0860                   |
| 1 X 21       | -0061                   | -0701                   | -0861                   |
| 1 X 22       | -0062                   | -0702                   | -0862                   |
| 1 X 23       | -0063                   | -0703                   | -0863                   |
| 1 X 24       | -0064                   | -0704                   | -0864                   |
| 1 X 25       | -0065                   | -0705                   | -0865                   |
| 1 X 26       | -0066                   | -0706                   | -0866                   |
| 1 X 27       | -0067                   | -0707                   | -0867                   |
| 1 X 28       | -0068                   | -0708                   | -0868                   |
| 1 X 29       | -0069                   | -0709                   | -0869                   |
| 1 X 30       | -0070                   | -0710                   | -0870                   |
| 1 X 31       | -0071                   | -0711                   | -0871                   |
| 1 X 32       | -0072                   | -0712                   | -0872                   |
| 1 X 33       | -0073                   | -0713                   | -0873                   |
| 1 X 34       | -0074                   | -0714                   | -0874                   |
| 1 X 35       | -0075                   | -0715                   | -0875                   |
| 1 X 36       | -0076                   | -0716                   | -0876                   |
| 1 X 37       | -0077                   | -0717                   | -0877                   |
| 1 X 38       | -0078                   | -0718                   | -0878                   |
| 1 X 39       | ▼ -0079                 | ▼ -0719                 | ▼ -0879                 |
| 1 X 40       | 90120-0080              | 90120-0720              | 90120-0880              |

| CIRCUIT SIZE | PLATING TYPE A PART NO. | PLATING TYPE E PART NO. | PLATING TYPE F PART NO. |
|--------------|-------------------------|-------------------------|-------------------------|
| 1 X 1        | 90120-0081              | 90120-0721              | 90120-0881              |
| 1 X 2        | ▲ -0082                 | ▲ -0722                 | ▲ -0882                 |
| 1 X 3        | -0083                   | -0723                   | -0883                   |
| 1 X 4        | -0084                   | -0724                   | -0884                   |
| 1 X 5        | -0085                   | -0725                   | -0885                   |
| 1 X 6        | -0086                   | -0726                   | -0886                   |
| 1 X 7        | -0087                   | -0727                   | -0887                   |
| 1 X 8        | -0088                   | -0728                   | -0888                   |
| 1 X 9        | -0089                   | -0729                   | -0889                   |
| 1 X 10       | -0090                   | -0730                   | -0890                   |
| 1 X 11       | -0091                   | -0731                   | -0891                   |
| 1 X 12       | -0092                   | -0732                   | -0892                   |
| 1 X 13       | -0093                   | -0733                   | -0893                   |
| 1 X 14       | -0094                   | -0734                   | -0894                   |
| 1 X 15       | -0095                   | -0735                   | -0895                   |
| 1 X 16       | -0096                   | -0736                   | -0896                   |
| 1 X 17       | -0097                   | -0737                   | -0897                   |
| 1 X 18       | -0098                   | -0738                   | -0898                   |
| 1 X 19       | -0099                   | -0739                   | -0899                   |
| 1 X 20       | -0100                   | -0740                   | -0900                   |
| 1 X 21       | -0101                   | -0741                   | -0901                   |
| 1 X 22       | -0102                   | -0742                   | -0902                   |
| 1 X 23       | -0103                   | -0743                   | -0903                   |
| 1 X 24       | -0104                   | -0744                   | -0904                   |
| 1 X 25       | -0105                   | -0745                   | -0905                   |
| 1 X 26       | -0106                   | -0746                   | -0906                   |
| 1 X 27       | -0107                   | -0747                   | -0907                   |
| 1 X 28       | -0108                   | -0748                   | -0908                   |
| 1 X 29       | -0109                   | -0749                   | -0909                   |
| 1 X 30       | -0110                   | -0750                   | -0910                   |
| 1 X 31       | -0111                   | -0751                   | -0911                   |
| 1 X 32       | -0112                   | -0752                   | -0912                   |
| 1 X 33       | -0113                   | -0753                   | -0913                   |
| 1 X 34       | -0114                   | -0754                   | -0914                   |
| 1 X 35       | -0115                   | -0755                   | -0915                   |
| 1 X 36       | -0116                   | -0756                   | -0916                   |
| 1 X 37       | -0117                   | -0757                   | -0917                   |
| 1 X 38       | -0118                   | -0758                   | -0918                   |
| 1 X 39       | ▼ -0119                 | ▼ -0759                 | ▼ -0919                 |
| 1 X 40       | 90120-0120              | 90120-0760              | 90120-0920              |

DIM  
C (±0.20)  
±.008  
(5.75)  
.226

DIM  
D (±0.20)  
±0.30  
±.008  
±.012  
(2.90)  
.114

DIM  
C (±0.20)  
±.008  
(5.75)  
.226

DIM  
D (±0.25)  
±.010  
(4.50)  
.177

NOTES:  
FOR PLATING VARIATIONS SEE  
ENG.STD. SDES-99000-0003.

**NON-STANDARD PRODUCTS**

|   |  |  |   |              |   |                        |  |
|---|--|--|---|--------------|---|------------------------|--|
| <b>REV GD&amp;T FOR DIM B</b><br>EC NO: S2010-0493<br>DRWN:SKANG 2009/12/11<br>CHKD:ATSEE 2009/12/21<br>APPR:MLONG 2009/12/21 | QUALITY SYMBOLS                                    | GENERAL TOLERANCES (UNLESS SPECIFIED)  | DIMENSION STYLE   | SCALE        | DESIGN UNITS                              | THIRD ANGLE PROJECTION |  |
|   | $\nabla_A = 0$<br>$\nabla_C = 0$<br>$\nabla_F = 0$ | mm INCH<br>4 PLACES ± --- ± ---<br>3 PLACES ± --- ± ---<br>2 PLACES ± --- ± ---<br>1 PLACE ± --- ± ---<br>ANGULAR ± ---° | MM/IN   | NTS          | METRIC                                    |                        |  |
|   |  | DRAFT WHERE APPLICABLE MUST REMAIN WITHIN DIMENSIONS   | DRAWN BY DATE   | TITLE        | C-GRID III SINGLE ROW STRAIGHT PIN HEADER |                        |  |
|   |  |  | CHECKED BY DATE   |              | MOLEX INCORPORATED                        |                        |  |
|   |  | APPROVED BY DATE   |   | SDA-90120    |   |                        |  |
|   |  | MATERIAL NO.   | SEE TABLE   | DOCUMENT NO. |   |                        |  |
|   |  | SIZE   | THIS DRAWING CONTAINS INFORMATION THAT IS PROPRIETARY TO MOLEX INCORPORATED AND SHOULD NOT BE USED WITHOUT WRITTEN PERMISSION |              |   |                        |  |
|   |  |  | 3 OF 6  |              |   |                        |  |

| CIRCUIT SIZE | PLATING TYPE A PART NO. | PLATING TYPE E PART NO. | PLATING TYPE F PART NO. |
|--------------|-------------------------|-------------------------|-------------------------|
| 1 X 1        | 90120-0161              | 90120-0801              | 90120-0961              |
| 1 X 2        | ▲ -0162                 | ▲ -0802                 | ▲ -0962                 |
| 1 X 3        | -0163                   | -0803                   | -0963                   |
| 1 X 4        | -0164                   | -0804                   | -0964                   |
| 1 X 5        | -0165                   | -0805                   | -0965                   |
| 1 X 6        | -0166                   | -0806                   | -0966                   |
| 1 X 7        | -0167                   | -0807                   | -0967                   |
| 1 X 8        | -0168                   | -0808                   | -0968                   |
| 1 X 9        | -0169                   | -0809                   | -0969                   |
| 1 X 10       | -0170                   | -0810                   | -0970                   |
| 1 X 11       | -0171                   | -0811                   | -0971                   |
| 1 X 12       | -0172                   | -0812                   | -0972                   |
| 1 X 13       | -0173                   | -0813                   | -0973                   |
| 1 X 14       | -0174                   | -0814                   | -0974                   |
| 1 X 15       | -0175                   | -0815                   | -0975                   |
| 1 X 16       | -0176                   | -0816                   | -0976                   |
| 1 X 17       | -0177                   | -0817                   | -0977                   |
| 1 X 18       | -0178                   | -0818                   | -0978                   |
| 1 X 19       | -0179                   | -0819                   | -0979                   |
| 1 X 20       | -0180                   | -0820                   | -0980                   |
| 1 X 21       | -0181                   | -0821                   | -0981                   |
| 1 X 22       | -0182                   | -0822                   | -0982                   |
| 1 X 23       | -0183                   | -0823                   | -0983                   |
| 1 X 24       | -0184                   | -0824                   | -0984                   |
| 1 X 25       | -0185                   | -0825                   | -0985                   |
| 1 X 26       | -0186                   | -0826                   | -0986                   |
| 1 X 27       | -0187                   | -0827                   | -0987                   |
| 1 X 28       | -0188                   | -0828                   | -0988                   |
| 1 X 29       | -0189                   | -0829                   | -0989                   |
| 1 X 30       | -0190                   | -0830                   | -0990                   |
| 1 X 31       | -0191                   | -0831                   | -0991                   |
| 1 X 32       | -0192                   | -0832                   | -0992                   |
| 1 X 33       | -0193                   | -0833                   | -0993                   |
| 1 X 34       | -0194                   | -0834                   | -0994                   |
| 1 X 35       | -0195                   | -0835                   | -0995                   |
| 1 X 36       | -0196                   | -0836                   | -0996                   |
| 1 X 37       | -0197                   | -0837                   | -0997                   |
| 1 X 38       | -0198                   | -0838                   | -0998                   |
| 1 X 39       | ▼ -0199                 | ▼ -0839                 | ▼ -0999                 |
| 1 X 40       | 90120-0200              | 90120-0840              | 90120-1000              |

DIM C  
(±0.20)  
±.008  
(6.75)  
.266

DIM D  
(±0.25)  
±.010  
(4.50)  
.177

NOTES:  
FOR PLATING VARIATIONS SEE  
ENG.STD. SDES-99000-0003.

**NON-STANDARD PRODUCTS**

|  |  |                                       |       |  |                            |  |                        |
|--|--|---------------------------------------|-------|--|----------------------------|--|------------------------|
| REV GD&T FOR DIM B<br>EC NO: S2010-0493<br>DRWN:SKANG 2009/12/11<br>CHKD:ATSEE 2009/12/21<br>APPR:MLONG 2009/12/21 | QUALITY SYMBOLS<br>▽ <sub>A</sub> =0<br>▽ <sub>B</sub> =0<br>▽ <sub>C</sub> =0 | GENERAL TOLERANCES (UNLESS SPECIFIED) |       | DIMENSION STYLE<br>MM/IN   | SCALE<br>NTS               | DESIGN UNITS<br>METRIC                                   | THIRD ANGLE PROJECTION |
|  |  | mm                                    | INCH  | DRAWN BY<br>JDENNEHY   | DATE<br>2006/01/18         | TITLE<br>C-GRID III<br>SINGLE ROW STRAIGHT<br>PIN HEADER |                        |
| N1   | DESCRIPTION  | 4 PLACES                              | ± --- | ± ---  | CHECKED BY<br>DWASZKIEWICZ | DATE<br>2006/01/18                                       | MOLEX INCORPORATED     |
|  |  | 3 PLACES                              | ± --- | ± ---  | APPROVED BY<br>MLONG       | DATE<br>2009/12/21                                       |                        |
| DRAFT WHERE APPLICABLE<br>MUST REMAIN<br>WITHIN DIMENSIONS   |  | SEE TABLE                             |       | THIS DRAWING CONTAINS INFORMATION THAT IS PROPRIETARY TO MOLEX<br>INCORPORATED AND SHOULD NOT BE USED WITHOUT WRITTEN PERMISSION |                            |  | SHEET NO.<br>4 OF 6    |

|        | 10              | 9                             | 8                             | 7                             | 6                             | 5               | 4                             | 3                             | 2                             | 1                             |   |            |            |
|--------|-----------------|-------------------------------|-------------------------------|-------------------------------|-------------------------------|-----------------|-------------------------------|-------------------------------|-------------------------------|-------------------------------|---|------------|------------|
| F      | CIRCUIT<br>SIZE | PLATING<br>TYPE B<br>PART NO. | PLATING<br>TYPE C<br>PART NO. | PLATING<br>TYPE D<br>PART NO. | PLATING<br>TYPE G<br>PART NO. | CIRCUIT<br>SIZE | PLATING<br>TYPE G<br>PART NO. | PLATING<br>TYPE B<br>PART NO. | PLATING<br>TYPE C<br>PART NO. | PLATING<br>TYPE D<br>PART NO. | F |            |            |
|        |                 | 1 X 1                         | 90120-0281                    | 90120-0441                    | 90120-0601                    |                 | 90120-1081                    | 1 X 1                         | 90120-1001                    | 90120-0201                    |   | 90120-0361 | 90120-0521 |
|        |                 | 1 X 2                         | ▲ -0282                       | ▲ -0442                       | ▲ -0602                       |                 | ▲ -1082                       | 1 X 2                         | ▲ -1002                       | ▲ -0202                       |   | ▲ -0362    | ▲ -0522    |
|        |                 | 1 X 3                         | -0283                         | -0443                         | -0603                         |                 | -1083                         | 1 X 3                         | -1003                         | -0203                         |   | -0363      | -0523      |
|        |                 | 1 X 4                         | -0284                         | -0444                         | -0604                         |                 | -1084                         | 1 X 4                         | -1004                         | -0204                         |   | -0364      | -0524      |
|        |                 | 1 X 5                         | -0285                         | -0445                         | -0605                         |                 | -1085                         | 1 X 5                         | -1005                         | -0205                         |   | -0365      | -0525      |
|        |                 | 1 X 6                         | -0286                         | -0446                         | -0606                         |                 | -1086                         | 1 X 6                         | -1006                         | -0206                         |   | -0366      | -0526      |
|        |                 | 1 X 7                         | -0287                         | -0447                         | -0607                         |                 | -1087                         | 1 X 7                         | -1007                         | -0207                         |   | -0367      | -0527      |
|        |                 | 1 X 8                         | -0288                         | -0448                         | -0608                         |                 | -1088                         | 1 X 8                         | -1008                         | -0208                         |   | -0368      | -0528      |
|        |                 | 1 X 9                         | -0289                         | -0449                         | -0609                         |                 | -1089                         | 1 X 9                         | -1009                         | -0209                         |   | -0369      | -0529      |
|        |                 | 1 X 10                        | -0290                         | -0450                         | -0610                         |                 | -1090                         | 1 X 10                        | -1010                         | -0210                         |   | -0370      | -0530      |
|        |                 | 1 X 11                        | -0291                         | -0451                         | -0611                         |                 | -1091                         | 1 X 11                        | -1011                         | -0211                         |   | -0371      | -0531      |
|        |                 | 1 X 12                        | -0292                         | -0452                         | -0612                         |                 | -1092                         | 1 X 12                        | -1012                         | -0212                         |   | -0372      | -0532      |
|        |                 | 1 X 13                        | -0293                         | -0453                         | -0613                         |                 | -1093                         | 1 X 13                        | -1013                         | -0213                         |   | -0373      | -0533      |
|        |                 | 1 X 14                        | -0294                         | -0454                         | -0614                         |                 | -1094                         | 1 X 14                        | -1014                         | -0214                         |   | -0374      | -0534      |
|        |                 | 1 X 15                        | -0295                         | -0455                         | -0615                         |                 | -1095                         | 1 X 15                        | -1015                         | -0215                         |   | -0375      | -0535      |
|        |                 | 1 X 16                        | -0296                         | -0456                         | -0616                         |                 | -1096                         | 1 X 16                        | -1016                         | -0216                         |   | -0376      | -0536      |
|        |                 | 1 X 17                        | -0297                         | -0457                         | -0617                         |                 | -1097                         | 1 X 17                        | -1017                         | -0217                         |   | -0377      | -0537      |
|        |                 | 1 X 18                        | -0298                         | -0458                         | -0618                         |                 | -1098                         | 1 X 18                        | -1018                         | -0218                         |   | -0378      | -0538      |
|        |                 | 1 X 19                        | -0299                         | -0459                         | -0619                         |                 | -1099                         | 1 X 19                        | -1019                         | -0219                         |   | -0379      | -0539      |
|        |                 | 1 X 20                        | -0300                         | -0460                         | -0620                         |                 | -1100                         | 1 X 20                        | -1020                         | -0220                         |   | -0380      | -0540      |
|        |                 | 1 X 21                        | -0301                         | -0461                         | -0621                         |                 | -1101                         | 1 X 21                        | -1021                         | -0221                         |   | -0381      | -0541      |
|        |                 | 1 X 22                        | -0302                         | -0462                         | -0622                         |                 | -1102                         | 1 X 22                        | -1022                         | -0222                         |   | -0382      | -0542      |
|        |                 | 1 X 23                        | -0303                         | -0463                         | -0623                         |                 | -1103                         | 1 X 23                        | -1023                         | -0223                         |   | -0383      | -0543      |
|        |                 | 1 X 24                        | -0304                         | -0464                         | -0624                         |                 | -1104                         | 1 X 24                        | -1024                         | -0224                         |   | -0384      | -0544      |
|        |                 | 1 X 25                        | -0305                         | -0465                         | -0625                         |                 | -1105                         | 1 X 25                        | -1025                         | -0225                         |   | -0385      | -0545      |
|        |                 | 1 X 26                        | -0306                         | -0466                         | -0626                         |                 | -1106                         | 1 X 26                        | -1026                         | -0226                         |   | -0386      | -0546      |
|        |                 | 1 X 27                        | -0307                         | -0467                         | -0627                         |                 | -1107                         | 1 X 27                        | -1027                         | -0227                         |   | -0387      | -0547      |
|        |                 | 1 X 28                        | -0308                         | -0468                         | -0628                         |                 | -1108                         | 1 X 28                        | -1028                         | -0228                         |   | -0388      | -0548      |
|        |                 | 1 X 29                        | -0309                         | -0469                         | -0629                         |                 | -1109                         | 1 X 29                        | -1029                         | -0229                         |   | -0389      | -0549      |
|        |                 | 1 X 30                        | -0310                         | -0470                         | -0630                         |                 | -1110                         | 1 X 30                        | -1030                         | -0230                         |   | -0390      | -0550      |
|        |                 | 1 X 31                        | -0311                         | -0471                         | -0631                         |                 | -1111                         | 1 X 31                        | -1031                         | -0231                         |   | -0391      | -0551      |
|        |                 | 1 X 32                        | -0312                         | -0472                         | -0632                         |                 | -1112                         | 1 X 32                        | -1032                         | -0232                         |   | -0392      | -0552      |
|        |                 | 1 X 33                        | -0313                         | -0473                         | -0633                         |                 | -1113                         | 1 X 33                        | -1033                         | -0233                         |   | -0393      | -0553      |
|        |                 | 1 X 34                        | -0314                         | -0474                         | -0634                         |                 | -1114                         | 1 X 34                        | -1034                         | -0234                         |   | -0394      | -0554      |
|        |                 | 1 X 35                        | -0315                         | -0475                         | -0635                         |                 | -1115                         | 1 X 35                        | -1035                         | -0235                         |   | -0395      | -0555      |
|        |                 | 1 X 36                        | -0316                         | -0476                         | -0636                         |                 | -1116                         | 1 X 36                        | -1036                         | -0236                         |   | -0396      | -0556      |
|        |                 | 1 X 37                        | -0317                         | -0477                         | -0637                         |                 | -1117                         | 1 X 37                        | -1037                         | -0237                         |   | -0397      | -0557      |
|        |                 | 1 X 38                        | -0318                         | -0478                         | -0638                         |                 | -1118                         | 1 X 38                        | -1038                         | -0238                         |   | -0398      | -0558      |
|        |                 | 1 X 39                        | ▼ -0319                       | ▼ -0479                       | ▼ -0639                       |                 | ▼ -1119                       | 1 X 39                        | ▼ -1039                       | ▼ -0239                       |   | ▼ -0399    | ▼ -0559    |
| 1 X 40 | 90120-0320      | 90120-0480                    | 90120-0640                    | 90120-1120                    | 1 X 40                        | 90120-1040      | 90120-0240                    | 90120-0400                    | 90120-0560                    |                               |   |            |            |

DIM  
C (±0.20)  
±.008  
(6.75)  
.266

DIM  
D (±0.20)  
±.008  
(2.90)  
.114

DIM  
C (±0.20)  
±.008  
(5.75)  
.226

DIM  
D (±0.20)  
±.008  
(2.90)  
.114

NOTES:  
FOR PLATING VARIATIONS SEE  
ENG.STD. SDES-99000-0003.

**NON-STANDARD PRODUCTS  
NOT FOR GENERAL RELEASE**

|   |   |  |       |  |              |                     |  |                           |           |  |
|---|---|--|-------|--|--------------|---------------------|--|---------------------------|-----------|--|
| <b>REV GD&amp;T FOR DIM B</b><br>EC NO: S2010-0493<br>DRWN:SKANG 2009/12/11<br>CHKD:ATSEE 2009/12/21<br>APPR:MLONG 2009/12/21 | QUALITY<br>SYMBOLS<br>$F_A=0$<br>$F_G=0$<br>$F_P=0$ | GENERAL TOLERANCES<br>(UNLESS SPECIFIED) |       | DIMENSION STYLE<br><b>MM/IN</b>  |              | SCALE<br><b>NTS</b> | DESIGN UNITS<br><b>METRIC</b>                            | THIRD ANGLE<br>PROJECTION |           |  |
|   |   | 4 PLACES                                 | ± --- | ± ---  | DRAWN BY     | DATE                | TITLE  |                           |           |  |
|   |   | 3 PLACES                                 | ± --- | ± ---  | JDENNEHY     | 2006/01/18          | <b>C-GRID III<br/>SINGLE ROW STRAIGHT<br/>PIN HEADER</b> |                           |           |  |
|   |   | 2 PLACES                                 | ± --- | ± ---  | CHECKED BY   | DATE                |  |                           |           |  |
|   |   | 1 PLACE                                  | ± --- | ± ---  | DWASZKIEWICZ | 2006/01/18          | <b>MOLEX INCORPORATED</b>                                |                           |           |  |
| ANGULAR ± ---°  |   | APPROVED BY                              |       | DATE   |              |                     |  |                           |           |  |
| DRAFT WHERE APPLICABLE<br>MUST REMAIN<br>WITHIN DIMENSIONS  |   | MATERIAL NO.                             |       | MLONG  |              | 2009/12/21          | DOCUMENT NO.   |                           | SHEET NO. |  |
|   |   | SEE TABLE                                |       | SDA-90120  |              | 5 OF 6              |  |                           |           |  |
|   |   | SIZE                                     |       | THIS DRAWING CONTAINS INFORMATION THAT IS PROPRIETARY TO MOLEX<br>INCORPORATED AND SHOULD NOT BE USED WITHOUT WRITTEN PERMISSION |              |                     |  |                           |           |  |
|   |   | A3                                       |       |  |              |                     |  |                           |           |  |

|  | 10 | 9            | 8                       | 7                       | 6                       | 5                       | 4 | 3            | 2                       | 1                       |                         |                         |
|--|----|--------------|-------------------------|-------------------------|-------------------------|-------------------------|---|--------------|-------------------------|-------------------------|-------------------------|-------------------------|
|  |    | CIRCUIT SIZE | PLATING TYPE B PART NO. | PLATING TYPE C PART NO. | PLATING TYPE D PART NO. | PLATING TYPE G PART NO. |   | CIRCUIT SIZE | PLATING TYPE B PART NO. | PLATING TYPE C PART NO. | PLATING TYPE D PART NO. | PLATING TYPE G PART NO. |
|  |    | I X 1        | 90120-0241              | 90120-0401              | 90120-0561              | 90120-1041              |   | I X 1        | 90120-0321              | 90120-0481              | 90120-0641              | 90120-1121              |
|  |    | I X 2        | ▲ -0242                 | ▲ -0402                 | ▲ -0562                 | ▲ -1042                 |   | I X 2        | ▲ -0322                 | ▲ -0482                 | ▲ -0642                 | ▲ -1122                 |
|  |    | I X 3        | -0243                   | -0403                   | -0563                   | -1043                   |   | I X 3        | -0323                   | -0483                   | -0643                   | -1123                   |
|  |    | I X 4        | -0244                   | -0404                   | -0564                   | -1044                   |   | I X 4        | -0324                   | -0484                   | -0644                   | -1124                   |
|  |    | I X 5        | -0245                   | -0405                   | -0565                   | -1045                   |   | I X 5        | -0325                   | -0485                   | -0645                   | -1125                   |
|  |    | I X 6        | -0246                   | -0406                   | -0566                   | -1046                   |   | I X 6        | -0326                   | -0486                   | -0646                   | -1126                   |
|  |    | I X 7        | -0247                   | -0407                   | -0567                   | -1047                   |   | I X 7        | -0327                   | -0487                   | -0647                   | -1127                   |
|  |    | I X 8        | -0248                   | -0408                   | -0568                   | -1048                   |   | I X 8        | -0328                   | -0488                   | -0648                   | -1128                   |
|  |    | I X 9        | -0249                   | -0409                   | -0569                   | -1049                   |   | I X 9        | -0329                   | -0489                   | -0649                   | -1129                   |
|  |    | I X 10       | -0250                   | -0410                   | -0570                   | -1050                   |   | I X 10       | -0330                   | -0490                   | -0650                   | -1130                   |
|  |    | I X 11       | -0251                   | -0411                   | -0571                   | -1051                   |   | I X 11       | -0331                   | -0491                   | -0651                   | -1131                   |
|  |    | I X 12       | -0252                   | -0412                   | -0572                   | -1052                   |   | I X 12       | -0332                   | -0492                   | -0652                   | -1132                   |
|  |    | I X 13       | -0253                   | -0413                   | -0573                   | -1053                   |   | I X 13       | -0333                   | -0493                   | -0653                   | -1133                   |
|  |    | I X 14       | -0254                   | -0414                   | -0574                   | -1054                   |   | I X 14       | -0334                   | -0494                   | -0654                   | -1134                   |
|  |    | I X 15       | -0255                   | -0415                   | -0575                   | -1055                   |   | I X 15       | -0335                   | -0495                   | -0655                   | -1135                   |
|  |    | I X 16       | -0256                   | -0416                   | -0576                   | -1056                   |   | I X 16       | -0336                   | -0496                   | -0656                   | -1136                   |
|  |    | I X 17       | -0257                   | -0417                   | -0577                   | -1057                   |   | I X 17       | -0337                   | -0497                   | -0657                   | -1137                   |
|  |    | I X 18       | -0258                   | -0418                   | -0578                   | -1058                   |   | I X 18       | -0338                   | -0498                   | -0658                   | -1138                   |
|  |    | I X 19       | -0259                   | -0419                   | -0579                   | -1059                   |   | I X 19       | -0339                   | -0499                   | -0659                   | -1139                   |
|  |    | I X 20       | -0260                   | -0420                   | -0580                   | -1060                   |   | I X 20       | -0340                   | -0500                   | -0660                   | -1140                   |
|  |    | I X 21       | -0261                   | -0421                   | -0581                   | -1061                   |   | I X 21       | -0341                   | -0501                   | -0661                   | -1141                   |
|  |    | I X 22       | -0262                   | -0422                   | -0582                   | -1062                   |   | I X 22       | -0342                   | -0502                   | -0662                   | -1142                   |
|  |    | I X 23       | -0263                   | -0423                   | -0583                   | -1063                   |   | I X 23       | -0343                   | -0503                   | -0663                   | -1143                   |
|  |    | I X 24       | -0264                   | -0424                   | -0584                   | -1064                   |   | I X 24       | -0344                   | -0504                   | -0664                   | -1144                   |
|  |    | I X 25       | -0265                   | -0425                   | -0585                   | -1065                   |   | I X 25       | -0345                   | -0505                   | -0665                   | -1145                   |
|  |    | I X 26       | -0266                   | -0426                   | -0586                   | -1066                   |   | I X 26       | -0346                   | -0506                   | -0666                   | -1146                   |
|  |    | I X 27       | -0267                   | -0427                   | -0587                   | -1067                   |   | I X 27       | -0347                   | -0507                   | -0667                   | -1147                   |
|  |    | I X 28       | -0268                   | -0428                   | -0588                   | -1068                   |   | I X 28       | -0348                   | -0508                   | -0668                   | -1148                   |
|  |    | I X 29       | -0269                   | -0429                   | -0589                   | -1069                   |   | I X 29       | -0349                   | -0509                   | -0669                   | -1149                   |
|  |    | I X 30       | -0270                   | -0430                   | -0590                   | -1070                   |   | I X 30       | -0350                   | -0510                   | -0670                   | -1150                   |
|  |    | I X 31       | -0271                   | -0431                   | -0591                   | -1071                   |   | I X 31       | -0351                   | -0511                   | -0671                   | -1151                   |
|  |    | I X 32       | -0272                   | -0432                   | -0592                   | -1072                   |   | I X 32       | -0352                   | -0512                   | -0672                   | -1152                   |
|  |    | I X 33       | -0273                   | -0433                   | -0593                   | -1073                   |   | I X 33       | -0353                   | -0513                   | -0673                   | -1153                   |
|  |    | I X 34       | -0274                   | -0434                   | -0594                   | -1074                   |   | I X 34       | -0354                   | -0514                   | -0674                   | -1154                   |
|  |    | I X 35       | -0275                   | -0435                   | -0595                   | -1075                   |   | I X 35       | -0355                   | -0515                   | -0675                   | -1155                   |
|  |    | I X 36       | -0276                   | -0436                   | -0596                   | -1076                   |   | I X 36       | -0356                   | -0516                   | -0676                   | -1156                   |
|  |    | I X 37       | -0277                   | -0437                   | -0597                   | -1077                   |   | I X 37       | -0357                   | -0517                   | -0677                   | -1157                   |
|  |    | I X 38       | -0278                   | -0438                   | -0598                   | -1078                   |   | I X 38       | -0358                   | -0518                   | -0678                   | -1158                   |
|  |    | I X 39       | ▼ -0279                 | ▼ -0439                 | ▼ -0599                 | ▼ -1079                 |   | I X 39       | ▼ -0359                 | ▼ -0519                 | ▼ -0679                 | ▼ -1159                 |
|  |    | I X 40       | 90120-0280              | 90120-0440              | 90120-0600              | 90120-1080              |   | I X 40       | 90120-0360              | 90120-0520              | 90120-0680              | 90120-1160              |

DIM C (+0.20) ±.008 (5.75) .226

DIM D (+0.25) ±.010 (4.50) .177

DIM C (+0.20) ±.008 (6.75) .266

DIM D (+0.25) ±.010 (4.50) .177

NOTES:  
FOR PLATING VARIATIONS SEE  
ENG.STD. SDES-99000-0003.

**NON-STANDARD PRODUCTS  
NOT FOR GENERAL RELEASE**

|                    |             |
|--------------------|-------------|
| REV GD&T FOR DIM B | DESCRIPTION |
| EC NO: S2010-0493  | 2009/12/11  |
| DRWN:SKANG         | 2009/12/11  |
| CHKD:ATSEE         | 2009/12/11  |
| APPR:MLONG         | 2009/12/11  |
| N1                 | REV         |

|                 |  |
|-----------------|--|
| QUALITY SYMBOLS | GENERAL TOLERANCES (UNLESS SPECIFIED)                |
| ▽A=0            | mm INCH  |
| ▽B=0            | 4 PLACES ± --- ± ---                                 |
| ▽C=0            | 3 PLACES ± --- ± ---                                 |
| ▽D=0            | 2 PLACES ± --- ± ---                                 |
|                 | 1 PLACE ± --- ± ---                                  |
|                 | ANGULAR ± ---°                                       |
|                 | DRAFT WHERE APPLICABLE MUST REMAIN WITHIN DIMENSIONS |

|                 |            |   |              |                        |
|-----------------|------------|---|--------------|------------------------|
| DIMENSION STYLE |            | SCALE   | DESIGN UNITS | THIRD ANGLE PROJECTION |
| MM/IN           |            | NTS   | METRIC       |                        |
| DRAWN BY        | DATE       | TITLE   |              |                        |
| JDENNEHY        | 2006/01/18 | C-GRID III SINGLE ROW STRAIGHT PIN HEADER   |              |                        |
| CHECKED BY      | DATE       | MOLEX INCORPORATED  |              |                        |
| DWASZKIEWICZ    | 2006/01/18 | MATERIAL NO. SDA-90120  |              |                        |
| APPROVED BY     | DATE       | SHEET NO. 6 OF 6  |              |                        |
| MLONG           | 2009/12/21 | THIS DRAWING CONTAINS INFORMATION THAT IS PROPRIETARY TO MOLEX INCORPORATED AND SHOULD NOT BE USED WITHOUT WRITTEN PERMISSION |              |                        |
| SIZE            | SEE TABLE  |   |              |                        |
| A3              |            |   |              |                        |



| CIRCUIT SIZE | PLATING TYPE A |                            | PLATING TYPE E |                            | PLATING TYPE F |                            |
|--------------|----------------|----------------------------|----------------|----------------------------|----------------|----------------------------|
|              | PART NO.       | CUSTOMER SPECIFIC PART NO. | PART NO.       | CUSTOMER SPECIFIC PART NO. | PART NO.       | CUSTOMER SPECIFIC PART NO. |
| 1 X 1        | 90120-0121     | 90120-9121                 | 90120-0761     | 90120-9761                 | 90120-0921     | 90120-9921                 |
| 1 X 2        | -0122          | -9122                      | -0762          | -9762                      | -0922          | -9922                      |
| 1 X 3        | -0123          | -9123                      | -0763          | -9763                      | -0923          | -9923                      |
| 1 X 4        | -0124          | -9124                      | -0764          | -9764                      | -0924          | -9924                      |
| 1 X 5        | -0125          | -9125                      | -0765          | -9765                      | -0925          | -9925                      |
| 1 X 6        | -0126          | -9126                      | -0766          | -9766                      | -0926          | -9926                      |
| 1 X 7        | -0127          | -9127                      | -0767          | -9767                      | -0927          | -9927                      |
| 1 X 8        | -0128          | -9128                      | -0768          | -9768                      | -0928          | -9928                      |
| 1 X 9        | -0129          | -9129                      | -0769          | -9769                      | -0929          | -9929                      |
| 1 X 10       | -0130          | -9130                      | -0770          | -9770                      | -0930          | -9930                      |
| 1 X 11       | -0131          | -9131                      | -0771          | -9771                      | -0931          | -9931                      |
| 1 X 12       | -0132          | -9132                      | -0772          | -9772                      | -0932          | -9932                      |
| 1 X 13       | -0133          | -9133                      | -0773          | -9773                      | -0933          | -9933                      |
| 1 X 14       | -0134          | -9134                      | -0774          | -9774                      | -0934          | -9934                      |
| 1 X 15       | -0135          | -9135                      | -0775          | -9775                      | -0935          | -9935                      |
| 1 X 16       | -0136          | -9136                      | -0776          | -9776                      | -0936          | -9936                      |
| 1 X 17       | -0137          | -9137                      | -0777          | -9777                      | -0937          | -9937                      |
| 1 X 18       | -0138          | -9138                      | -0778          | -9778                      | -0938          | -9938                      |
| 1 X 19       | -0139          | -9139                      | -0779          | -9779                      | -0939          | -9939                      |
| 1 X 20       | -0140          | -9140                      | -0780          | -9780                      | -0940          | -9940                      |
| 1 X 21       | -0141          | -9141                      | -0781          | -9781                      | -0941          | -9941                      |
| 1 X 22       | -0142          | -9142                      | -0782          | -9782                      | -0942          | -9942                      |
| 1 X 23       | -0143          | -9143                      | -0783          | -9783                      | -0943          | -9943                      |
| 1 X 24       | -0144          | -9144                      | -0784          | -9784                      | -0944          | -9944                      |
| 1 X 25       | -0145          | -9145                      | -0785          | -9785                      | -0945          | -9945                      |
| 1 X 26       | -0146          | -9146                      | -0786          | -9786                      | -0946          | -9946                      |
| 1 X 27       | -0147          | -9147                      | -0787          | -9787                      | -0947          | -9947                      |
| 1 X 28       | -0148          | -9148                      | -0788          | -9788                      | -0948          | -9948                      |
| 1 X 29       | -0149          | -9149                      | -0789          | -9789                      | -0949          | -9949                      |
| 1 X 30       | -0150          | -9150                      | -0790          | -9790                      | -0950          | -9950                      |
| 1 X 31       | -0151          | -9151                      | -0791          | -9791                      | -0951          | -9951                      |
| 1 X 32       | -0152          | -9152                      | -0792          | -9792                      | -0952          | -9952                      |
| 1 X 33       | -0153          | -9153                      | -0793          | -9793                      | -0953          | -9953                      |
| 1 X 34       | -0154          | -9154                      | -0794          | -9794                      | -0954          | -9954                      |
| 1 X 35       | -0155          | -9155                      | -0795          | -9795                      | -0955          | -9955                      |
| 1 X 36       | -0156          | -9156                      | -0796          | -9796                      | -0956          | -9956                      |
| 1 X 37       | -0157          | -9157                      | -0797          | -9797                      | -0957          | -9957                      |
| 1 X 38       | -0158          | -9158                      | -0798          | -9798                      | -0958          | -9958                      |
| 1 X 39       | -0159          | -9159                      | -0799          | -9799                      | -0959          | -9959                      |
| 1 X 40       | 90120-0160     | 90120-9160                 | 90120-0800     | 90120-9800                 | 90120-0960     | 90120-9960                 |

DIM C (+0.20) ±.008 (6.75) .266

DIM D (+0.20) (+0.30) ±.008 (+0.12) (2.90) .114

NOTES:  
FOR PLATING VARIATIONS SEE  
ENG.STD. SDES-99000-0003.

**STANDARD PRODUCTS**

PART NO'S ADDED  
EC NO: E2006-0667  
DRWN: DENNEHY 2006/01/23  
CHKD: DWASZKIEWICZ 2006/01/23  
APPR: DENNEHY 2006/02/07

QUALITY SYMBOLS  
▽=0  
▽=0

GENERAL TOLERANCES (UNLESS SPECIFIED)

|          | mm     | INCH  |
|----------|--------|-------|
| 4 PLACES | ± ---  | ± --- |
| 3 PLACES | ± ---  | ± --- |
| 2 PLACES | ± ---  | ± --- |
| 1 PLACE  | ± ---  | ± --- |
| ANGULAR  | ± ---° |       |

DRAFT WHERE APPLICABLE  
MUST REMAIN WITHIN DIMENSIONS

DIMENSION STYLE  
MM ONLY

| DRAWN BY     | DATE       |
|--------------|------------|
| JDENNEHY     | 2006/01/18 |
| CHECKED BY   | DATE       |
| DWASZKIEWICZ | 2006/01/18 |
| APPROVED BY  | DATE       |
| JDENNEHY     | 2006/01/18 |
| MATERIAL NO. |            |
| SIZE         | A3         |

SCALE ---  
DESIGN UNITS METRIC  
THIRD ANGLE PROJECTION

TITLE  
C-GRID III  
SINGLE ROW STRAIGHT  
PIN HEADER

MOLEX MOLEX INCORPORATED

DOCUMENT NO. SDA-90120  
SHEET NO. 2 OF 6

THIS DRAWING CONTAINS INFORMATION THAT IS PROPRIETARY TO MOLEX INCORPORATED AND SHOULD NOT BE USED WITHOUT WRITTEN PERMISSION