

Features

Festoon Light
 Energy saving and Long Life
 No radiation
 Available Voltage:12VDC/24VDC
 White,Blue,Red,Green,Yellow and so on

Applications

Automotive Top Light
 Automotive License Plate Light
 Automotive Reading Light

Outline Size

Unit: mm
 Tolerance: $\pm 0.30\text{mm}$

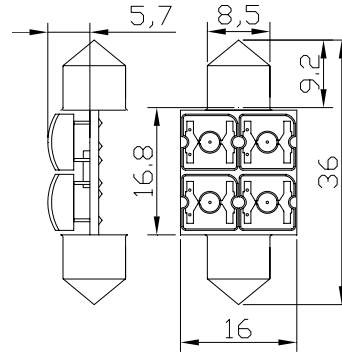

Absolute Maximum Rating

($T_a=25^\circ\text{C}$)

Item	Symbol	Value	Unit
Input Voltage (DC)	V_i	16	V
Input Current(DC)	I_i	85	mA
Power Dissipation	P_a	1.36	W
Operating Temperature	T_{ope}	-10 ~ +40	
Storage Temperature	T_{stg}	-20 ~ +80	

Picture



Electrical -Optical Characteristics

($T_a=25^\circ\text{C}$)

Item	Symbol	Min.	Typ.	Test Data	Unit
Input Voltage(DC)	V_i	-	12	14	V
Input Current(DC)	I_i	-	50	68	mA
Power Dissipation	P_a	-	0.6	0.952	W
Chromaticity	x		0.27		
Coordinates	y		0.28		
Whole Luminous Flux*	Φ_v		25		lm
Beam Pattern	BP	-	140	-	Deg
Net Weight	W_{ei}	-	3.4	-	g

*Tolerance of luminous intensity is $\pm 15\%$