

Subminiature Fuse, 3.8 x 10 mm, Quick-Acting F, 250 VAC, 125 VDC



UL 248-14 · 250VAC · 125VDC · Quick-Acting F



**Description**

- Low Breaking Capacity

**Standards**

- UL 248-14  
- CSA C22.2 no. 248.14

**Approvals**

- UL File Number: E42088

**References**

[General Product Information](#)  
[Packaging Details](#)

**Weblinks**

[Approvals, RoHS, CHINA-RoHS, e-Store, Distributor-Stock-Check, Accessories, Product Change Notification \(PCN\)](#)

**Technical Data**

|                              |   |
|------------------------------|---|
| Rated Voltage                | 125 - 250 VAC, 125 VDC  |
| Rated Current                | 0.05 - 5 A  |
| Breaking Capacity            | 50 A - 300 A  |
| Characteristic               | Quick-Acting F  |
| Admissible Ambient Air Temp. | -40 °C to 85 °C   |
| Material: Tube               | Ceramic   |
| Material: Axial Leads        | Tin-Plated Copper   |
| Unit Weight                  | 0.6 g   |
| Storage Conditions           | 0 °C to 60 °C, max. 70% r.h.  |
| Product Marking              |  Current, Characteristic |

|                              |   |
|------------------------------|---|
| Soldering Methods            | Wave  |
| Solderability                | 235 °C / 2 sec acc. to IEC 60068-2-20, Test Ta, method 1  |
| Resistance to Soldering Heat | 260 °C / 5 sec acc. to IEC 60068-2-20, Test Tb, method 1A |

**Dimensions**

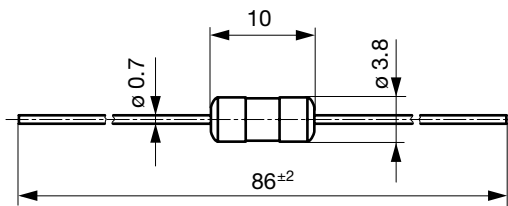
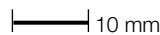

**Pre-Arcing Time**

Rated Current  $I_n$     1.0 x  $I_n$  min.    2.0 x  $I_n$  max.    3.0 x  $I_n$  max.

|              |     |      |        |
|--------------|-----|------|--------|
| 0.05 A - 5 A | 4 h | 60 s | 100 ms |
|--------------|-----|------|--------|

### Variants

| Rated Current [A] | Rated Voltage [VAC] | Rated Voltage [VDC] | Breaking Capacity | Voltage Drop 1.0 In typ. [mV] | Melting I <sup>2</sup> t 10.0 Intyp. [A <sup>2</sup> s] |  | Order Number |
|-------------------|---------------------|---------------------|-------------------|-------------------------------|---|---|--------------|
| 0.05              | 250                 | 125                 | 1)                | 1150                          | 0.00011   | ●   | 7010.1740.xx |
| 0.063             | 250                 | 125                 | 1)                | 735                           | 0.00035   | ●   | 7010.1750.xx |
| 0.08              | 250                 | 125                 | 1)                | 950                           | 0.00039   | ●   | 7010.1760.xx |
| 0.1               | 250                 | 125                 | 1)                | 875                           | 0.00079   | ●   | 7010.1770.xx |
| 0.125             | 250                 | 125                 | 1)                | 870                           | 0.0013  | ●   | 7010.1780.xx |
| 0.15              | 250                 | 125                 | 1)                | 545                           | 0.0029  | ●   | 7010.1790.xx |
| 0.2               | 250                 | 125                 | 1)                | 520                           | 0.0071  | ●   | 7010.1910.xx |
| 0.3               | 250                 | 125                 | 1)                | 920                           | 0.021   | ●   | 7010.1920.xx |
| 0.4               | 250                 | 125                 | 1)                | 725                           | 0.057   | ●   | 7010.1930.xx |
| 0.5               | 250                 | 125                 | 1)                | 725                           | 0.069   | ●   | 7010.1800.xx |
| 0.6               | 250                 | 125                 | 1)                | 205                           | 0.059   | ●   | 7010.1810.xx |
| 0.8               | 250                 | 125                 | 1)                | 150                           | 0.095   | ●   | 7010.1820.xx |
| 1                 | 250                 | 125                 | 1)                | 185                           | 0.12  | ●   | 7010.1830.xx |
| 1.25              | 250                 | 125                 | 1)                | 125                           | 0.29  | ●   | 7010.1840.xx |
| 1.6               | 250                 | 125                 | 1)                | 135                           | 0.48  | ●   | 7010.1850.xx |
| 2                 | 250                 | 125                 | 1)                | 110                           | 0.95  | ●   | 7010.1860.xx |
| 2.5               | 250                 | 125                 | 1)                | 145                           | 1.2   | ●   | 7010.1870.xx |
| 3                 | 250                 | 125                 | 1)                | 220                           | 1.8   | ●   | 7010.1880.xx |
| 4                 | 250                 | 125                 | 1)                | 130                           | 3.4   | ●   | 7010.1890.xx |
| 5                 | 250                 | 125                 | 1)                | 105                           | 7.7   | ●   | 7010.1900.xx |

1) 50 A @ 250 VAC/DC / 300 A @ 125 VAC/DC

### Packaging Unit

.xx = .12 Plastic Bag (50 pcs.)  
 .xx = .46 Taped 19 cm Reel (1000 pcs.)

### Time-Current-Curves

