

PART NO.	"D" ^{+0.0} _{-0.1}	"d" ^{+0.2} _{-0.1}	MATERIAL	"L"
*OFBLT-2.6-05-PP	5.05	2.6	POLYPROPYLENE, WHITE (RMS-86)	100 METERS
OFBLT-3.1-05-PP		3.1		
OFBLT-4.2-635-PP	6.35	4.2		
OFBLT-3.1-05-PBT VO	5.05	3.1	PBT VO, BLACK UL94-VO RATED (RMS-140)	
OFBLT-4.2-635-PBT VO	6.35	4.2		

*PARTS AVAILABLE BY SPECIAL ORDER ONLY

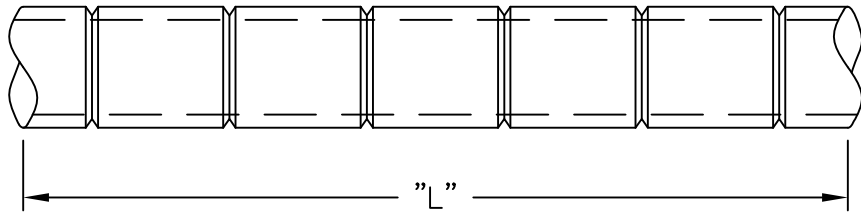
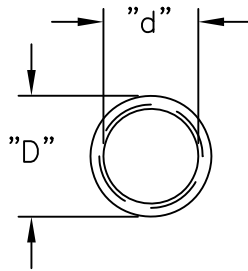

NOTES:
1. PLENUM RATED TYPE
AVAILABLE BY SPECIAL ORDER ONLY.

APPLICABLE PATENTS: CANADA PAT. NO.2122064
AUSTRALIA PAT. NO. 29063/92
EUROPE PAT. NO. 92923018.3
USA PAT. NO. 5 473 723

<table border="1"> <tr> <td>F</td> <td>SEE CO 200318 FOR CHANGES</td> <td>SK 02.03.09</td> </tr> <tr> <td>E</td> <td>SEE CO 200035 FOR CHANGES</td> <td>SK 09.26.07</td> </tr> <tr> <td>D</td> <td>SEE ECN #1012 FOR CHANGES</td> <td>SK 06.03.05</td> </tr> <tr> <td>C</td> <td>ADDED RMS NOTE TO TABLE</td> <td>SJ 04.24.02</td> </tr> <tr> <td>B</td> <td>REMOVED P/N: OFBLT-2.6-05-PBT VO</td> <td>SM 02.05.02</td> </tr> <tr> <td>A</td> <td>UPDATED PRINT, CHANGED FILE NO.</td> <td>SM 01.31.02</td> </tr> <tr> <td>REV</td> <td>DESCRIPTION</td> <td>ENGR DATE</td> </tr> </table>			F	SEE CO 200318 FOR CHANGES	SK 02.03.09	E	SEE CO 200035 FOR CHANGES	SK 09.26.07	D	SEE ECN #1012 FOR CHANGES	SK 06.03.05	C	ADDED RMS NOTE TO TABLE	SJ 04.24.02	B	REMOVED P/N: OFBLT-2.6-05-PBT VO	SM 02.05.02	A	UPDATED PRINT, CHANGED FILE NO.	SM 01.31.02	REV	DESCRIPTION	ENGR DATE	<p>TITLE: OPTICAL FIBER BEND LIMITING TUBE</p>						<p>DWG IN mm</p>			
F	SEE CO 200318 FOR CHANGES	SK 02.03.09																															
E	SEE CO 200035 FOR CHANGES	SK 09.26.07																															
D	SEE ECN #1012 FOR CHANGES	SK 06.03.05																															
C	ADDED RMS NOTE TO TABLE	SJ 04.24.02																															
B	REMOVED P/N: OFBLT-2.6-05-PBT VO	SM 02.05.02																															
A	UPDATED PRINT, CHANGED FILE NO.	SM 01.31.02																															
REV	DESCRIPTION	ENGR DATE																															
<p>TOLERANCES UNLESS NOTED .XX= .XXX= FRAC= ANG=±1°</p>			<p>FILE # OFBLT MAT'L: SEE TABLE RE: RICHCO, INC.</p>		<p>DWN: AM DT: 5/14/99</p>		<p>APP: DT:</p>		<p>FINAL</p>																								
			<p>PO BOX 804238, CHICAGO, 60680 (773) 539-4060</p>		<p>PART # SEE TABLE</p>		<p>PRINT TYPE CA</p>																										