



## BLOCK TYPE AVALANCHE AUTOMOTIVE RECTIFIER

**BA30Z**

**AVALANCHE VOLTAGE** 24 to 32 Volts

**CURRENT** 30 Amperes

### Technical Specifecation:

#### Features:

- High power capability
- Economical
- Avalanche Voltage: 24V to 32V
- Glass passivated chip

#### MECHANICAL DATA

- Copper cup with transfer molded plastic
- Epoxy: UL94-0 rate flame ratardant
- Polarity: BA30-P lead-P  
BA30-N lead-N
- Technology vacuum soldered
- Lead: Plated slug, solderable per MIL-STD-202E Method 208C
- Weight: 0.094 ounce 2.65 Grams

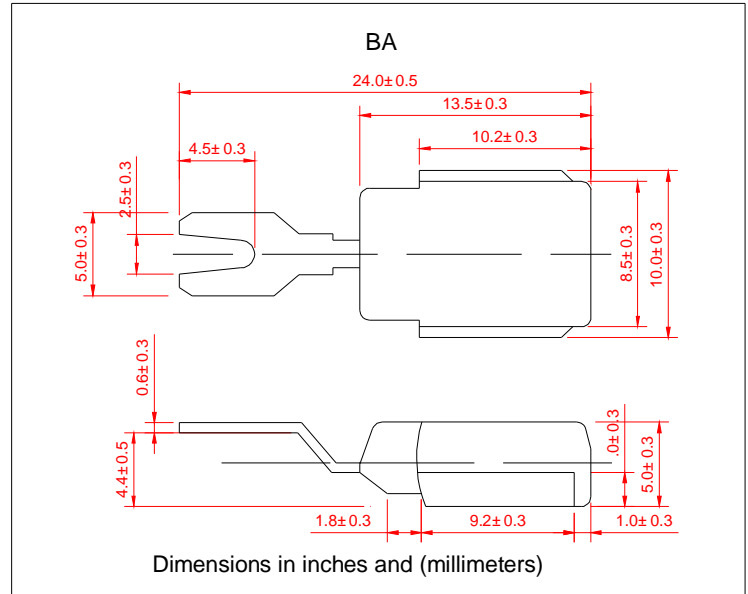

#### MAXIMUM RATINGS AND ELECTRICAL CHARACTERISTICS

- Ratings at 25°C ambient temperature unless otherwise specified
- Single Phase, half wave, 60Hz, resistive or inductive load
- For capacitive load derate current by 20%

		BA30Z-P/BA30Z-N			
Electrical Characteristics @ 25°C	SYMBOLS	MIN	NOMINAL	MAX	UNITS
Peak Repetitive Reverse Voltage	$V_{RRM}$		20		Volts
Working Peak Reverse Voltage	$V_{RRM}$		20		
DC Blocking Voltage	$V_{DC}$		20		
Average Rectified Forward Current ( $T_c=125^\circ\text{C}$ )	$I_o$		30		Amps
Repetitive Peak Reverse Surge Current $T_c=10\text{msec}$ Dury Cycle<1%	$I_{RSM}$		30		Amps
Breakdown Voltage ( $V_{br@ir=100\text{mA}, T_c=25^\circ\text{C}}$ )	$V_{br1}$	24	25-27	32	Volts
$I_r=90\text{Amps}, T_c=150^\circ\text{C}, PW=80\text{usec}$	$V_{br2}$			40	Volts
Forward Voltage Drop @ $I_f=100\text{Amps}<300\text{usec}$	$V_F$		1.05	1.10	Volts
Peak Forward Surge Current	$I_{FSM}$		400		Amps
Reverse Leakage ( $V_R=17\text{Vdc}$ ) $T_A=25^\circ\text{C}$	$I_R$		1.0	2.0	uAmps
Operating and Storage Junction Temperature Range	$T_J, T_{STG}$	-65 to +175			°C

**Notes:** 1. Enough heatsink must be considered in application.

